



# Woodview Elementary

Project Advisory Team  
Meeting #5  
April 26, 2022





# Welcome + Introductions

## SPRING BRANCH ISD

Irma Garner	Woodview Elementary, Principal
Travis Stanford	Associate Superintendent for Operations
Max Buja	Planning & Construction, Director
David Ramirez	Planning & Construction, Project Manager
Geoff Bay	Planning & Construction, Project Manager

## STANTEC ARCHITECTURE

Jennifer Henrikson	Architect - Principal
Tracy Eich	Architect - Senior Design Principal
Mark Jackson	Architect - Senior Project Manager
Gin Kappler-Peeler	Architect - Senior Project Manager
Gretchen Diesel	Interior Designer - Senior Interior Designer



# Agenda

1. **PAT Process:** Project/Process Status Update

---

2. **PAT Mtg #5: Plan Update**

WVE Guiding Principles  
Site Plan and Floor Plan Updates

---

3. **PAT Mtg #5: Exterior Expression**

PAT Feedback Results  
PAT Feedback → WVE Design Principles  
Design Progress | Preliminary Exterior Views  
**PAT Poll:** Exterior Design Progress

---

4. **PAT Mtg #5: Interior Expression**

Explore Interior Expression Elements  
**PAT Engagement:** Interior Expression Input

---

5. **Next Steps:** What's Happening Next



# Item 1

## PAT PROCESS OVERVIEW Project / Process Status Update





# New Woodview Elementary School - Project Scope

- **Replacement of Woodview Elementary School** with new building and site elements
- **Approx. 100,000 SF** building per SBISD Educational Specifications
- **Off Site Transition:** Campus will relocate to East Transition Campus from January 2023 thru May 2024
- **18-20 months** total construction period
- **August 2024:** New Woodview Elementary School opens



# PAT Engagement – Project Advisory Team (PAT) Charge

## OVERVIEW

A Project Advisory Team (PAT) will be chartered for the planning of a replacement for **Woodview Elementary School** under the school's project in the 2017 Bond Program.

## CHARGE

The PAT will work collaboratively and cooperatively with the architect and SBISD Project Manager **to conceptualize, develop and refine the project's goals and design.**

**The PAT will advise on recommendations regarding the interior and exterior appearance** of the replacement of Woodview Elementary School.

The PAT will **reach a proposed recommendation through consensus.**

**These recommendations will be presented to the Superintendent + Board of Trustees for approval.**  
*The Board of Trustees may act upon the recommendations developed with PAT input by approving, amending, altering or not approving all or any part of the recommendations.*

**Areas of focus from which the PAT should refrain include** recommendations regarding school programs, policies and procedures, boundaries of district facilities, instructional arrangements and/or educational pedagogy decided upon and/or subject to District, State and Federal laws.



# PAT Engagement – Process Overview | Status Update

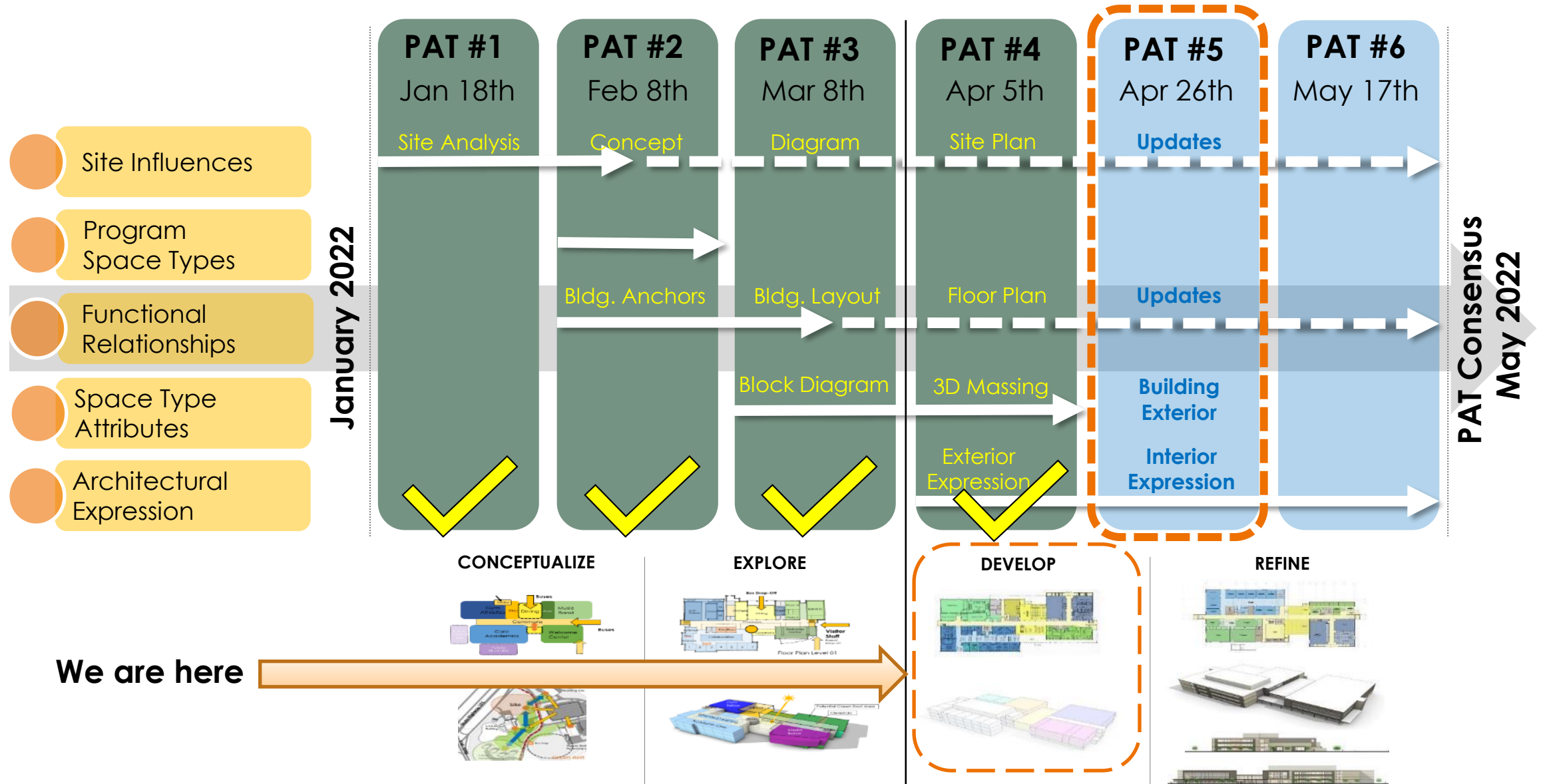

# Item 2

# PAT MEETING #5

## Plan Updates





# PAT Mtg#3 Information: **WVE Guiding Principles**

## **Reflect the Diversity of our Learners, Staff and Community**

Celebrate pride in our identity.

## **Provide an Open and Collaborative Learning Environment to Nurture Students, Staff, and Parents**

Support our commitment and dedication to one another.

## **Encourage Engagement and Connectivity with Nature**

Include light-filled interiors with views and access to courtyards, gardens and trees  
without interrupting the operational flow.

## **Welcome our Families, Neighbors and Partners**

Invite the community to our parks, playgrounds and event spaces.



# PAT Mtg#4 Recap: Schematic Design | Site Plan & Floor Plans

## SITE PLAN

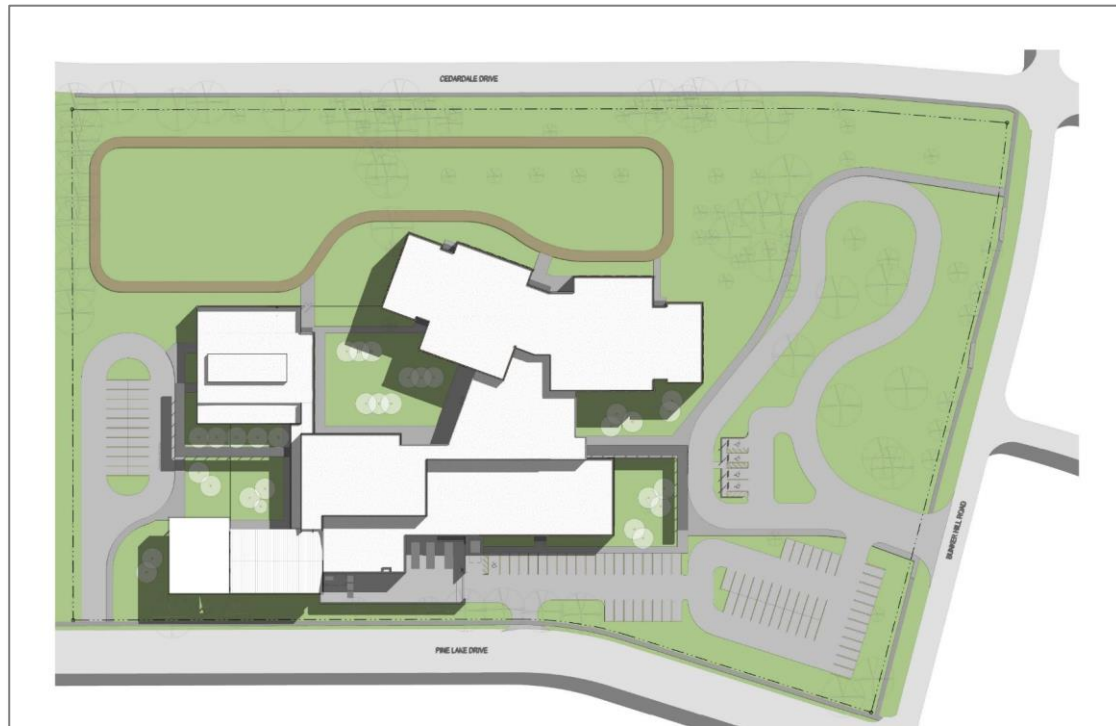

## FLOOR PLANS: Floor 1 + Floor 2

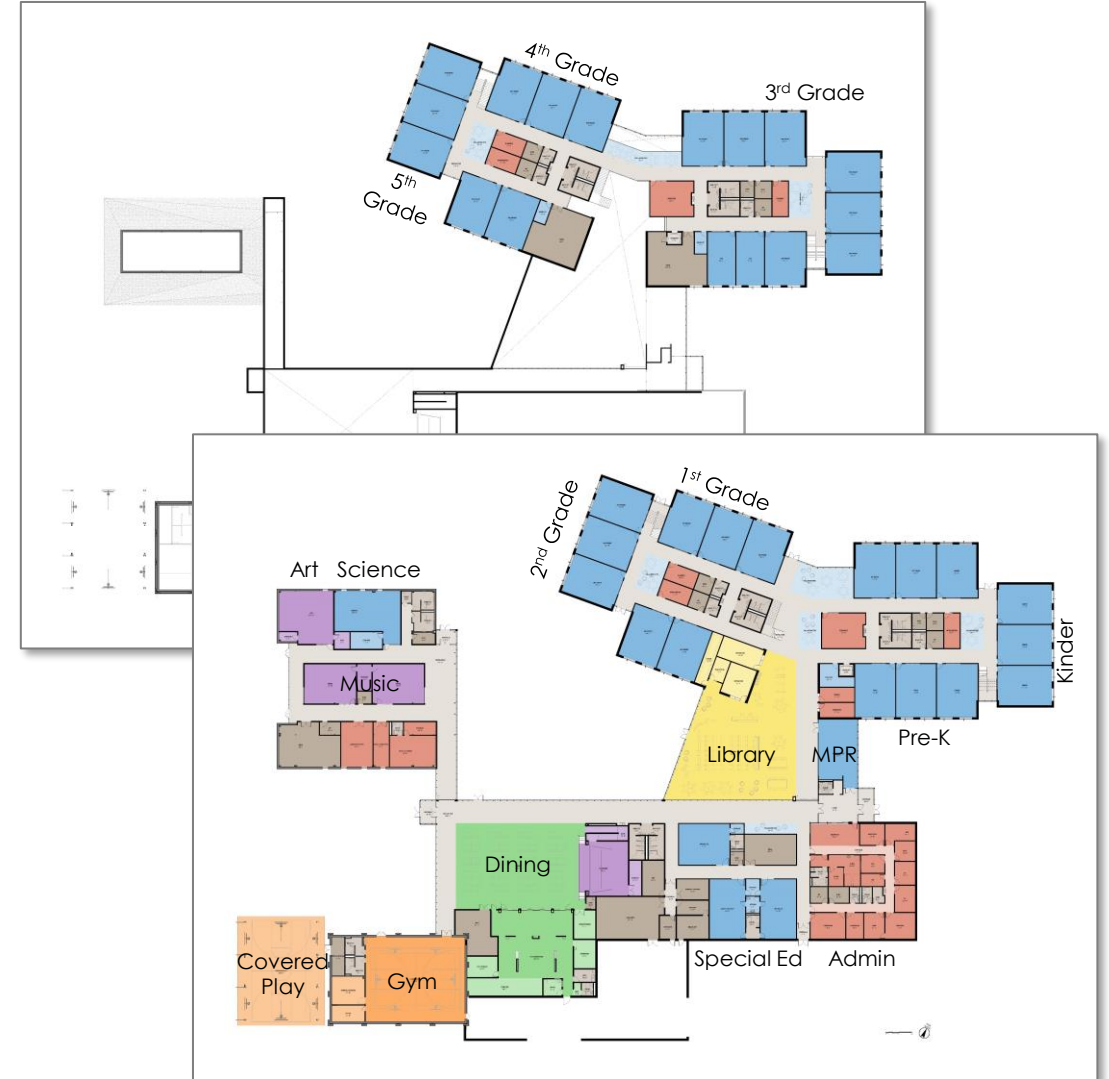



# PAT Mtg#4 Engagement: Schematic Site + Floor Plans

PAT Poll

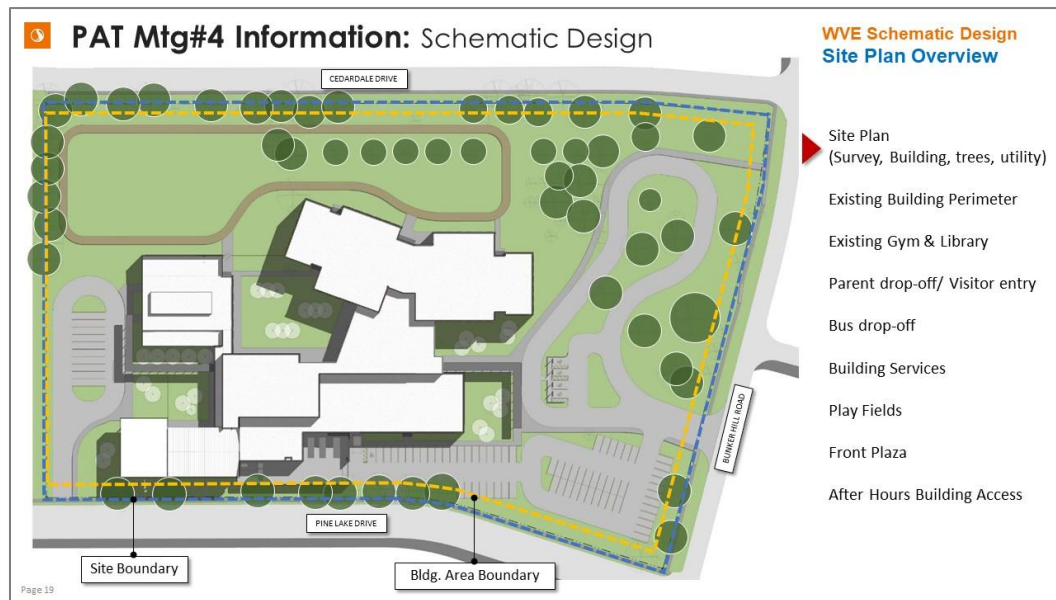

## Does the Schematic Design Respond to Guiding Principles?

### WVE DESIGN - GUIDING PRINCIPLES

**Reflect the Diversity of our Learners, Staff and Community**  
Celebrate pride in our identity.

**Provide an Open and Collaborative Learning Environment to Nurture Students, Staff, and Parents**  
Support our commitment and dedication to one another.

**Encourage Engagement and Connectivity with Nature**  
Include light-filled interiors with views and access to courtyards, gardens and trees without interrupting the operational flow.

**Welcome our Families, Neighbors and Partners**  
Invite the community to our parks, playgrounds and event spaces.

1

**Site & Context**  
Connection to Outdoors.  
Welcome Families, Neighbors, etc.

YES

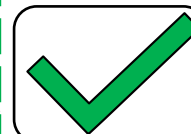

NO



2

**Building Organization**  
Indoor/Outdoor Learning  
Support Students, Staff, Parents

YES

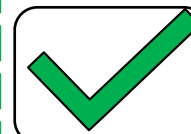

NO





# PAT Mtg#5: Schematic Design Progress

## WVE Design Progress Site Plan Updates

WOODVIEW ELEMENTARY SCHOOL

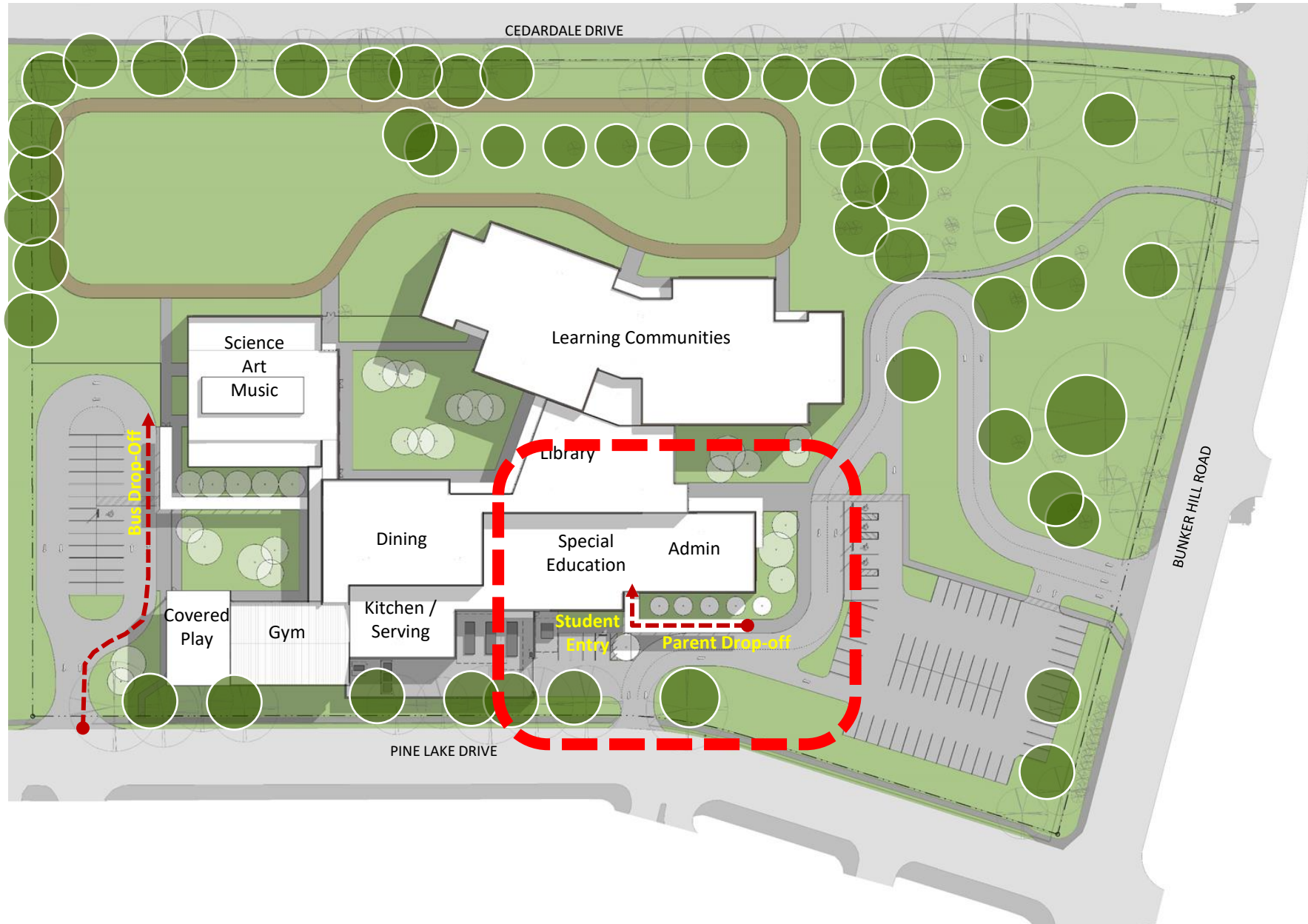

### Key Updates:

1. **Modification of Student Drop-off entry point**
2. Modification at driveway and Front Parking Lot
3. Modification of Service Drive and Service Yard and Driveway Exit to Pine Lake



# PAT Mtg#5: Schematic Design Progress

## WVE Design Progress Site Plan Updates

WOODVIEW ELEMENTARY SCHOOL

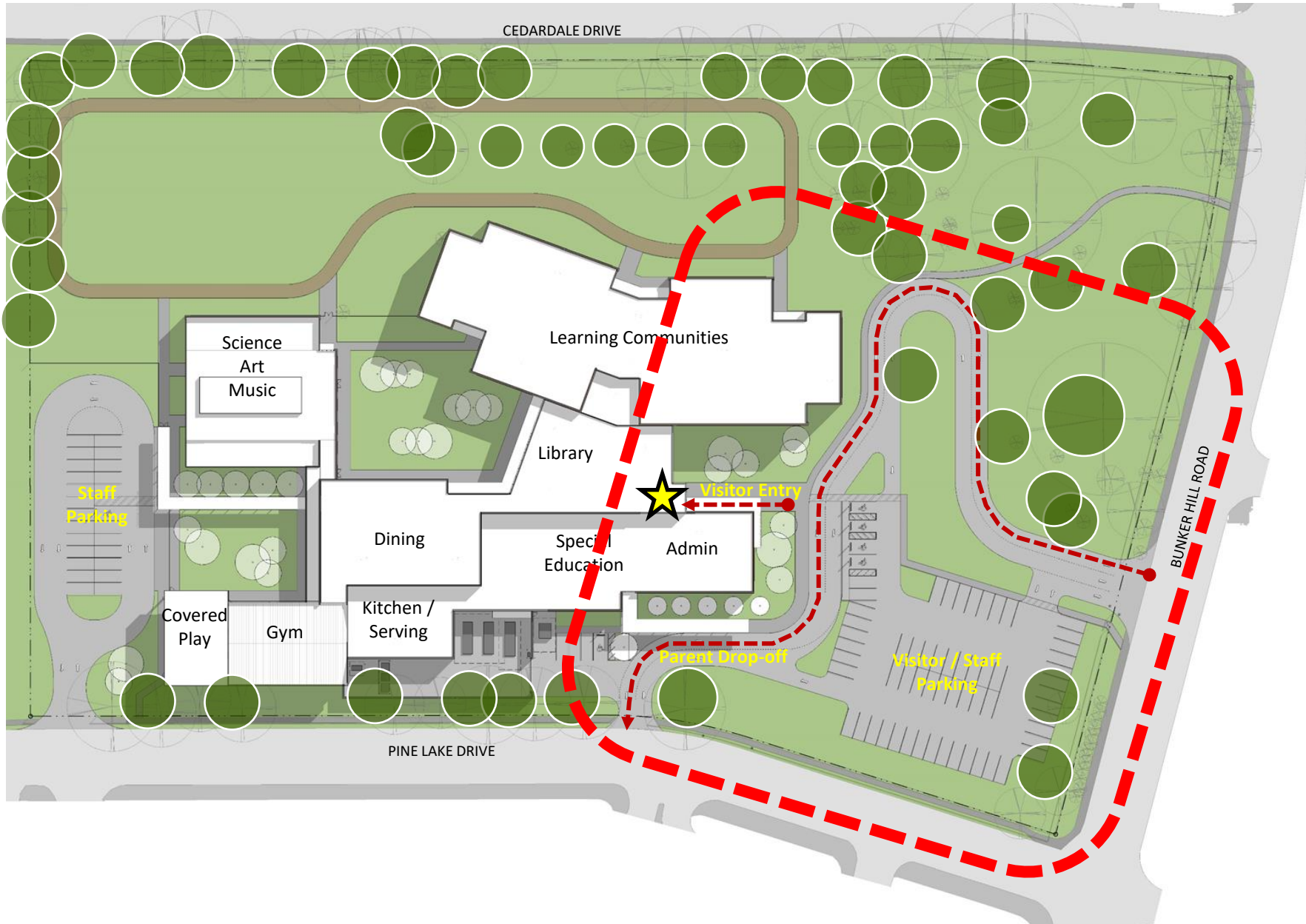

### Key Updates:

1. Modification of Student Drop-off entry point
2. **Modification at driveway and Front Parking Lot**
3. Modification of Service Drive and Service Yard and Driveway Exit to Pine Lake



# PAT Mtg#5: Schematic Design Progress

## WVE Design Progress Site Plan Updates

WOODVIEW ELEMENTARY SCHOOL

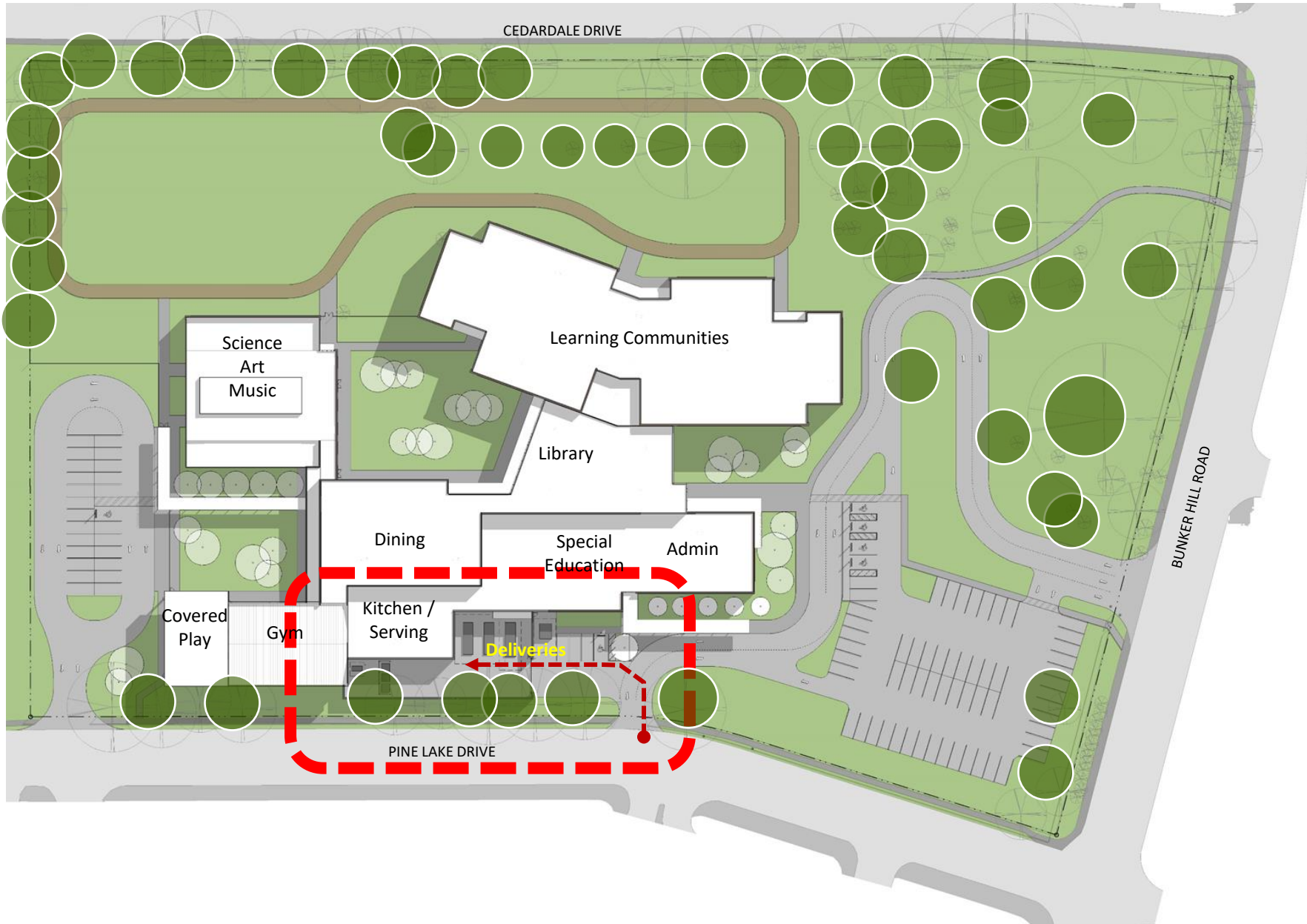

### Key Updates:

1. Modification of Student Drop-off entry point
2. Modification at driveway and Front Parking Lot
3. **Modification of Service Drive and Service Yard and Driveway Exit to Pine Lake**



# PAT Mtg#5: Schematic Design Progress | Floor Plans

## WVE Design Progress Floor Plan Updates

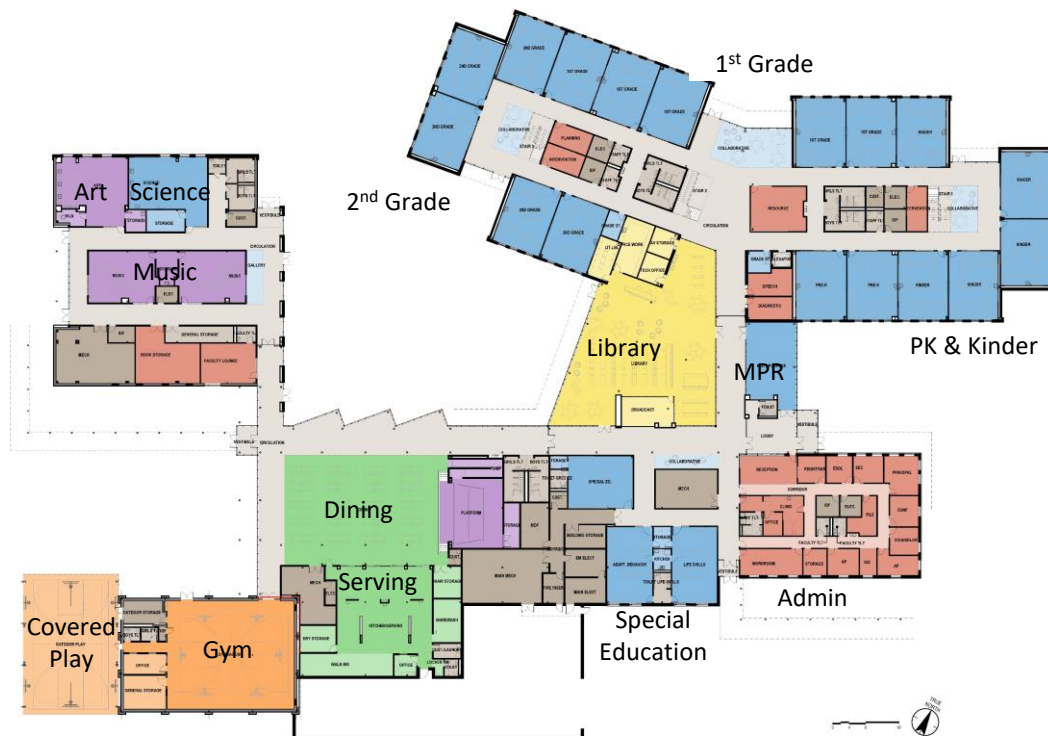

### First Floor Plan

- Administration
- Library + Multi-Purpose
- PK/K + 1<sup>st</sup> + 2<sup>nd</sup> Grade
- Educational Support Spaces
- Special Education
- Art, Science, Music
- Gym + Covered Play
- Dining / Kitchen

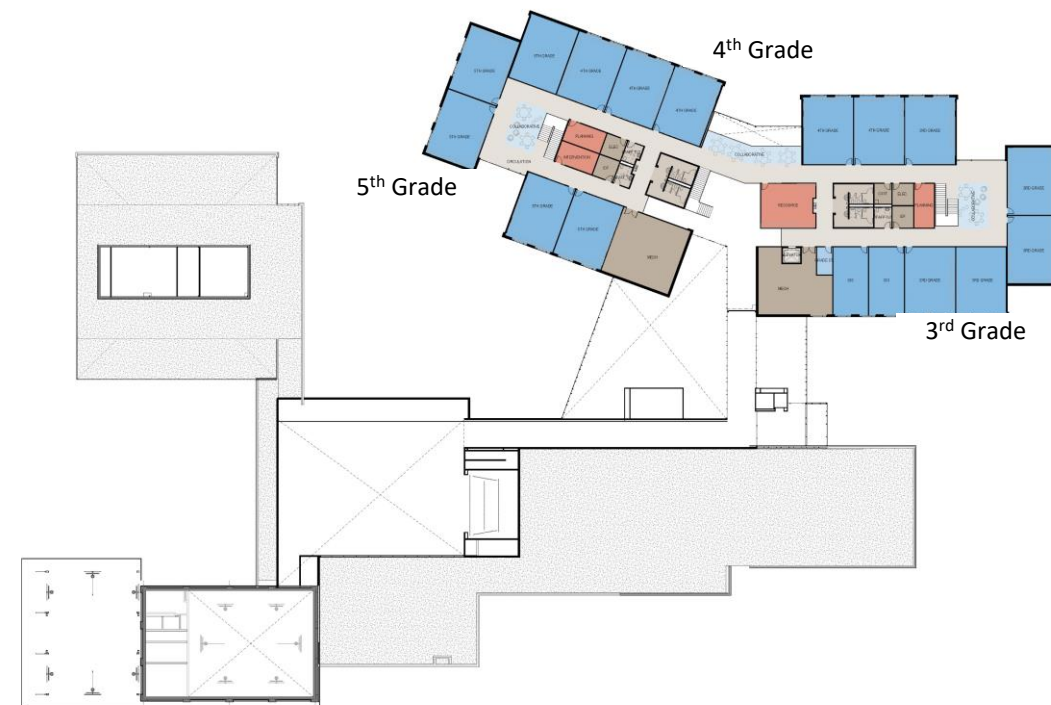

### Second Floor Plan

- 3<sup>rd</sup> + 4<sup>th</sup> + 5<sup>th</sup> Grade
- Educational Support Spaces

#### 32 Classrooms

- 2 = Pre-K
- 5 = Kinder
- 5 = 1<sup>st</sup> grade
- 5 = 2<sup>nd</sup> grade
- 5 = 3<sup>rd</sup> grade
- 5 = 4<sup>th</sup> grade
- 5 = 5<sup>th</sup> grade



## WVE Design Progress Floor Plan Updates



### Key Plan Updates:

1. Administration
2. Library & Multi-Purpose
3. Learning Communities
4. Art, Science & Music
5. Special Education
6. Dining / Gym





## WVE Design Progress Floor Plan Updates

### Key Plan Updates:

1. Administration
2. Library & Multi-Purpose
3. Learning Communities
4. Art, Science & Music
5. Special Education
6. Dining / Gym

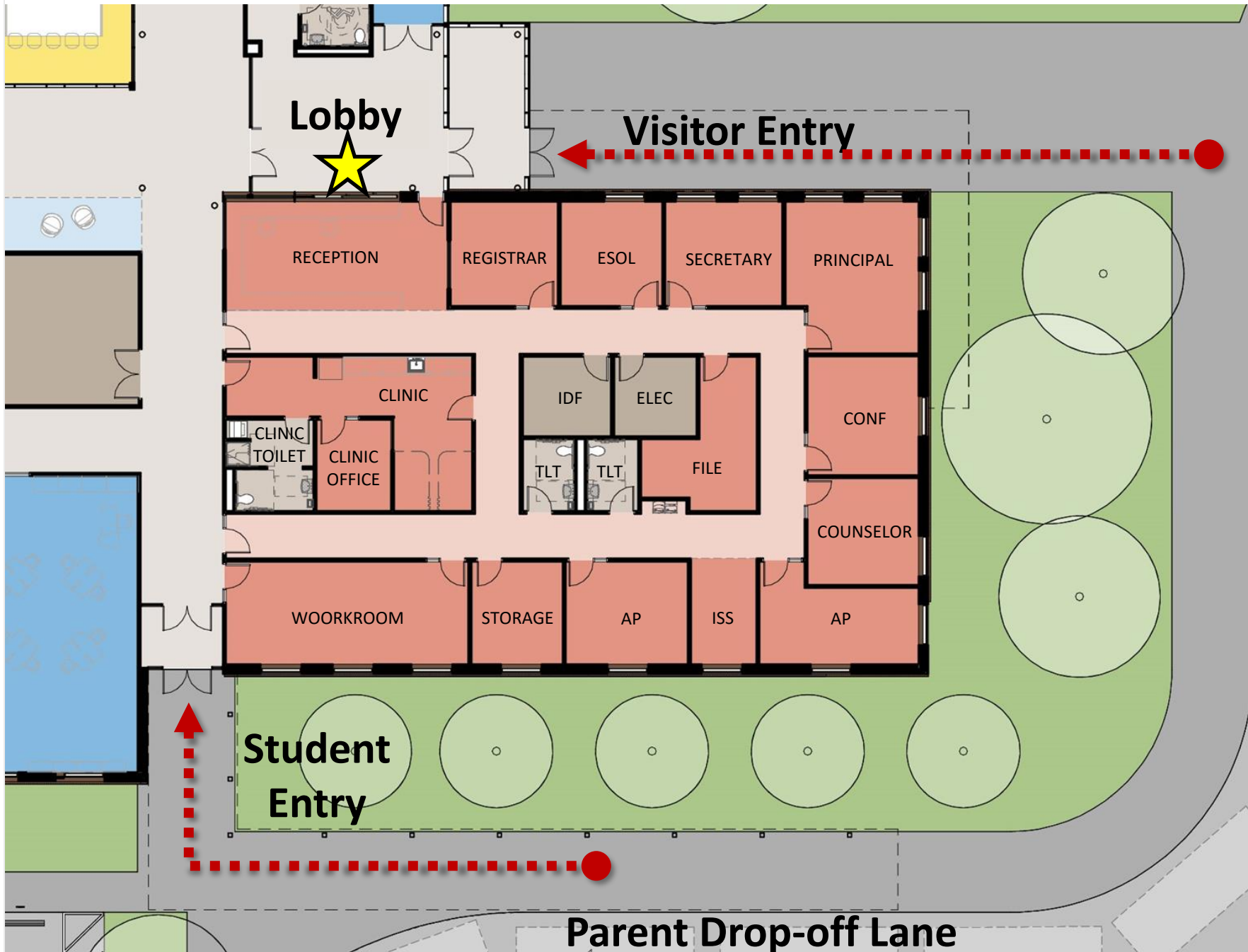



## WVE Design Progress Floor Plan Updates

### Key Plan Updates:

1. Administration
2. **Library & Multi-Purpose**
3. Learning Communities
4. Art, Science & Music
5. Special Education
6. Dining / Gym



## WVE Design Progress Floor Plan Updates

### Key Plan Updates:

1. Administration
2. Library & Multi-Purpose
3. Learning Communities
4. Art, Science & Music
5. Special Education
6. Dining / Gym



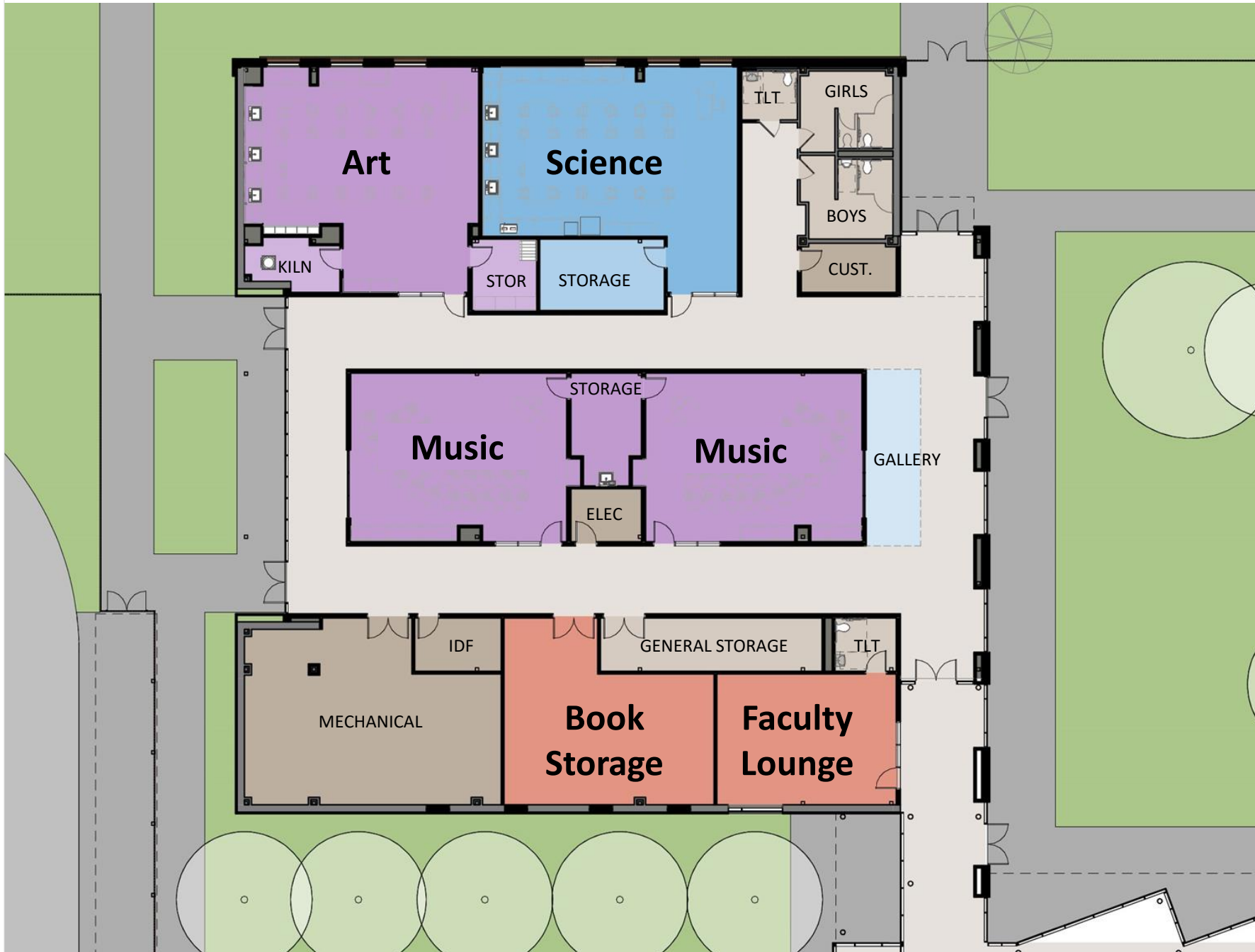

## WVE Design Progress Floor Plan Updates

### Key Plan Updates:

1. Administration
2. Library & Multi-Purpose
3. Learning Communities
4. **Art, Science & Music**
5. Special Education
6. Dining / Gym



## WVE Design Progress Floor Plan Updates

### Key Plan Updates:

1. Administration
2. Library & Multi-Purpose
3. Learning Communities
4. Art, Science & Music
5. **Special Education**
6. Dining / Gym





## WVE Design Progress Floor Plan Updates

### Key Plan Updates:

1. Administration
2. Library & Multi-Purpose
3. Learning Communities
4. Art, Science & Music
5. Special Education
6. Dining / Gym





# Item 3

## PAT MEETING #5 Exterior Expression

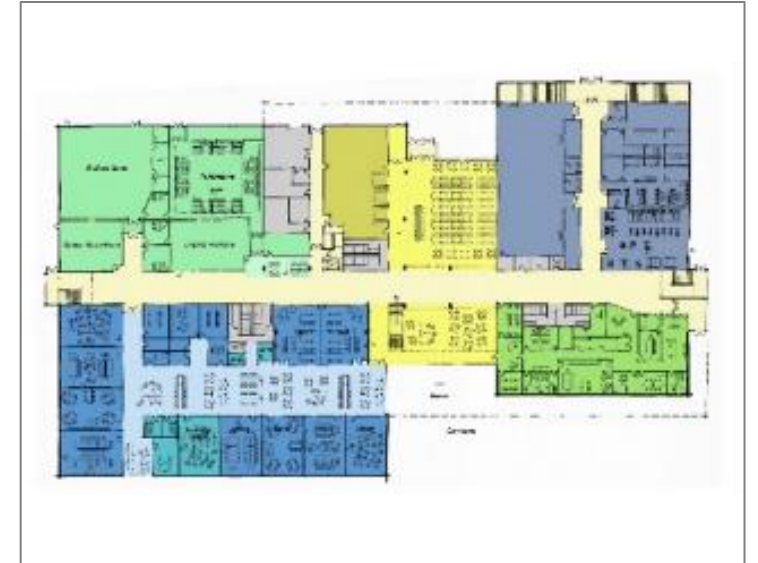
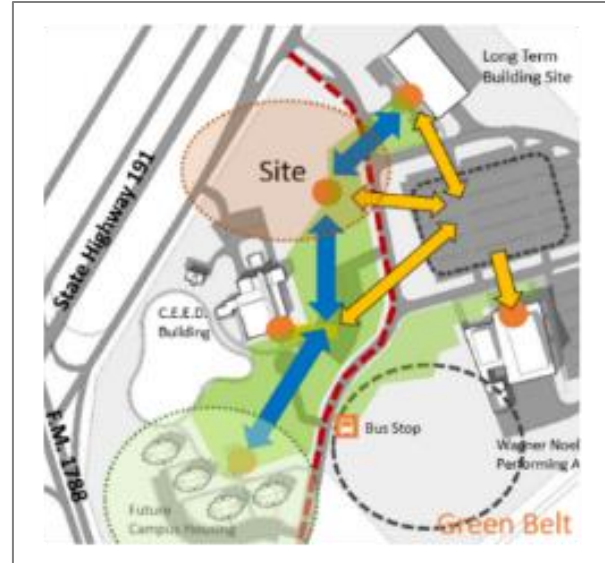

**Review Design Progress + Seek Feedback:**  
Site Plan | Floor Plan | 3D Massing

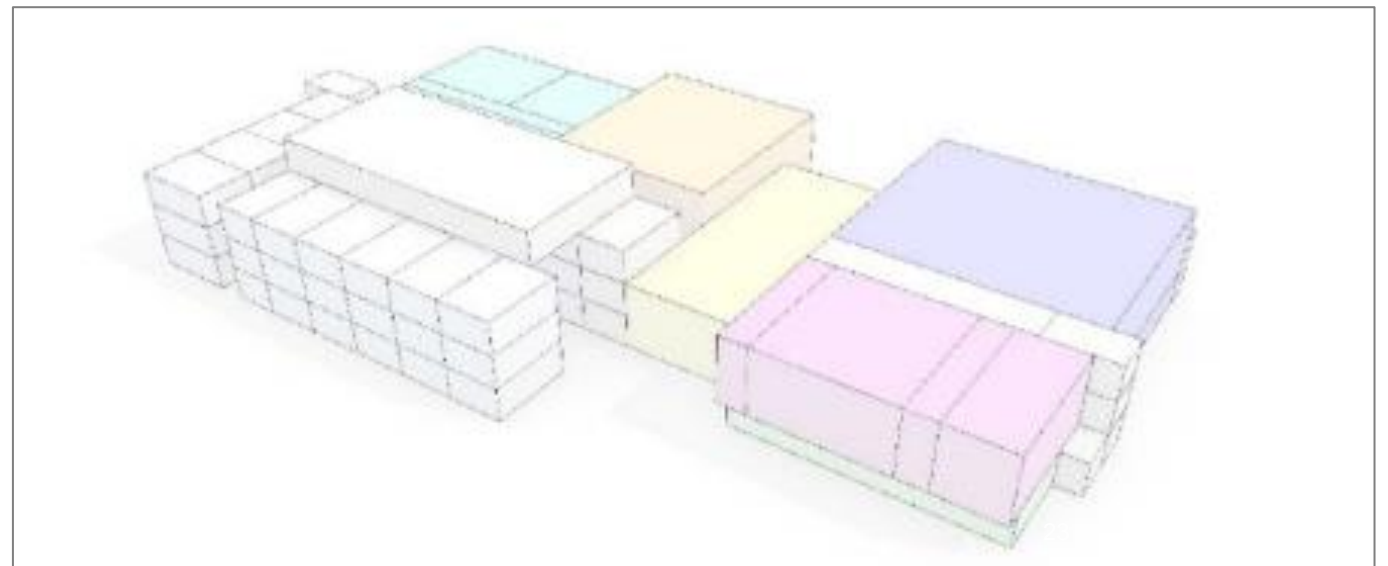



# PAT Mtg#4 Engagement: Architectural Exterior Expression

## PAT Mtg#4 Engagement: WVE Surrounding Context

### Site & Context



Variety of scale, composition colors,  
texture and uses



Traffic  
Stoplights  
Signage  
Building Signage  
Heavy Color & Graphics



Tree Lined Streets

Low scale Residential

### PAT Mtg #4 – Exterior Architectural Expression Worksheet

Name: \_\_\_\_\_

Exterior Design Element	Select Your Individual Preference			Comments on Images
1 <b>Composition:</b> As viewed from the street, what does the building communicate?	Formal <input type="checkbox"/>	Hybrid <input type="checkbox"/>	Informal <input type="checkbox"/>	What do you like <b>most</b> ?  What do you like <b>least</b> ? _____
2 <b>Tone &amp; Tenor:</b> How does composition of the building materials look/feel?	Neutral / Natural <input type="checkbox"/>	Hybrid <input type="checkbox"/>	Colorful / Vibrant <input type="checkbox"/>	What do you like <b>most</b> ?  What do you like <b>least</b> ? _____
3 <b>Shape:</b> How does building shape relate to the surrounding context?	Orthogonal & Geometric <input type="checkbox"/>	Hybrid <input type="checkbox"/>	Organic & Sculptural <input type="checkbox"/>	What do you like <b>most</b> ?  What do you like <b>least</b> ? _____
4 <b>Scale:</b> Identify Statement? Entry Approach Feel?	Vertical <input type="checkbox"/>	Neutral <input type="checkbox"/>	Horizontal <input type="checkbox"/>	What do you like <b>most</b> ?  What do you like <b>least</b> ? _____
5 <b>Materiality:</b> How do the building materials (quantity, composition, type) shape the exterior?	Multiple Types <input type="checkbox"/>	Limited Range <input type="checkbox"/>	Single Type <input type="checkbox"/>	What do you like <b>most</b> ?  What do you like <b>least</b> ? _____



# PAT Mtg#4 Engagement: Architectural Expression PAT Feedback

**1. Composition**  
As viewed from the street, what does the building communicate?

**Formal:** Institutional, Public & Civic



Formal Entry



Repetitive Pattern



Symmetrical

**Informal:** Casual, Relaxed & Approachable



Informal Entry



Balanced Composition



Shape & Movement



Playful & Fun

Page 48

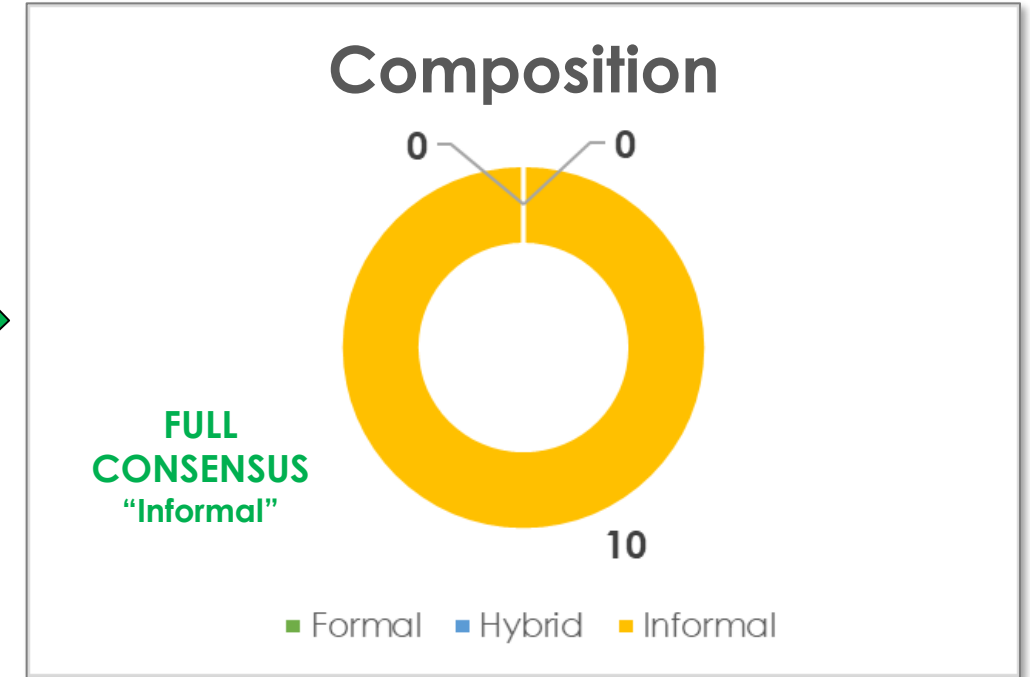

## What Do You Like the Most?

- The playful movement fit for K-5
- The openness, windows, and color
- Diverse and creative
- A fun place to learn

## What Do You Like the Least?

- Too formal feels boring
- Not as modern as it should be
- Formal symmetrical entry



# PAT Mtg#4 Engagement: Architectural Expression PAT Feedback

## 2. Tone & Tenor

How does the composition of building materials look and feel?

**Neutral Tones & Natural Materials:** Compliment the Landscape = Warm, Blended, Natural



Metals and, Glass      Metal, Wood, Glass      Masonry, Glass, Stone      Masonry, Metal, Glass

**Colorful Tones & Vibrant Materials:** Contrast the Landscape = Bright, Vibrant, Colorful



Masonry, Metal, Glass      Metal, Wood, Glass      Metal, Glass      Masonry, Metal, Glass

Page 49

## What Do You Like the Most?

- Modern blend of color and materials
- Blends better with the neighborhood
- Bright colors to engage students
- More welcoming to kids and community

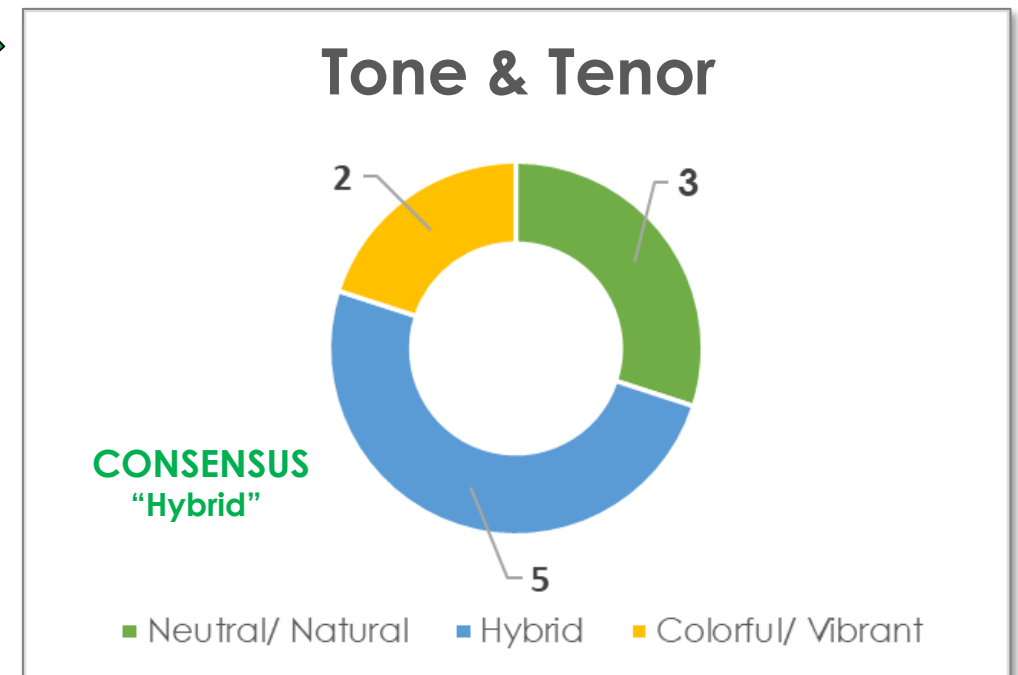

## What Do You Like the Least?

- Too much color sticks out
- Too artistic can be a distraction for kids
- Too vibrant



# PAT Mtg#4 Engagement: Architectural Expression PAT Feedback

**3. Shape**  
How does the building shape relate to the surrounding context?

**Orthogonal & Geometric:** Simple Geometric Lines



Framed Entry    Traditional Shapes    Modern Geometry    Layered Entry

**Organic & Sculptural:** Sloped Roof Lines    Attention Getting = Shape



Tall, Vertical Entry    Bold Entry    Angular Shapes    Sculptural Roof Lines

Page 50

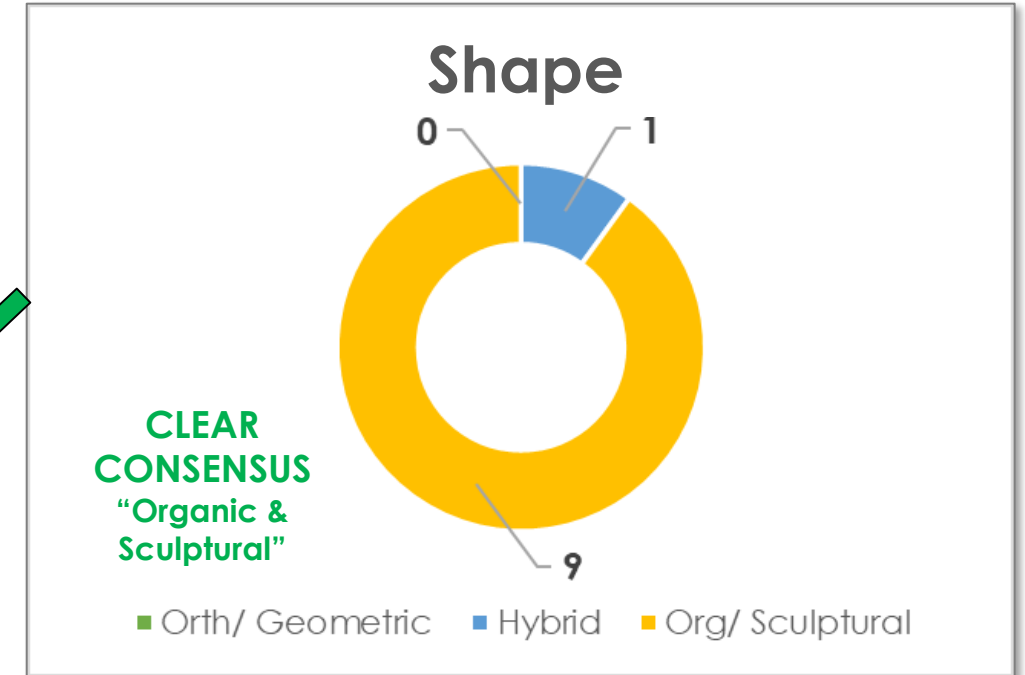

## What Do You Like the Most?

- Tall inviting entry
- Organic and sculptural
- Creative & organic to blend with neighborhood
- Different layers are fun and inviting

## What Do You Like the Least?

- Too traditional is dated
- Traditional and boring
- Uninviting



# PAT Mtg#4 Engagement: Architectural Expression PAT Feedback

## 4. Scale

View from a Distance – What is the identity statement for the building?  
Front Entry Experience – How does the front entry approach feel?

### Vertical

Vertical Entry Feature  
Attention Getting Object viewed from a distance

### Neutral

Balanced Composition  
Sculptural Element balanced by horizontal entry

### Horizontal

Horizontal Composition  
Horizontal Planes blend with natural landscape

Page 51

## What Do You Like the Most?

- Entry with lots of windows
- Represents our diverse community
- More modern vertical elements
- A welcoming feel
- Balancing sculptural and horizontal elements

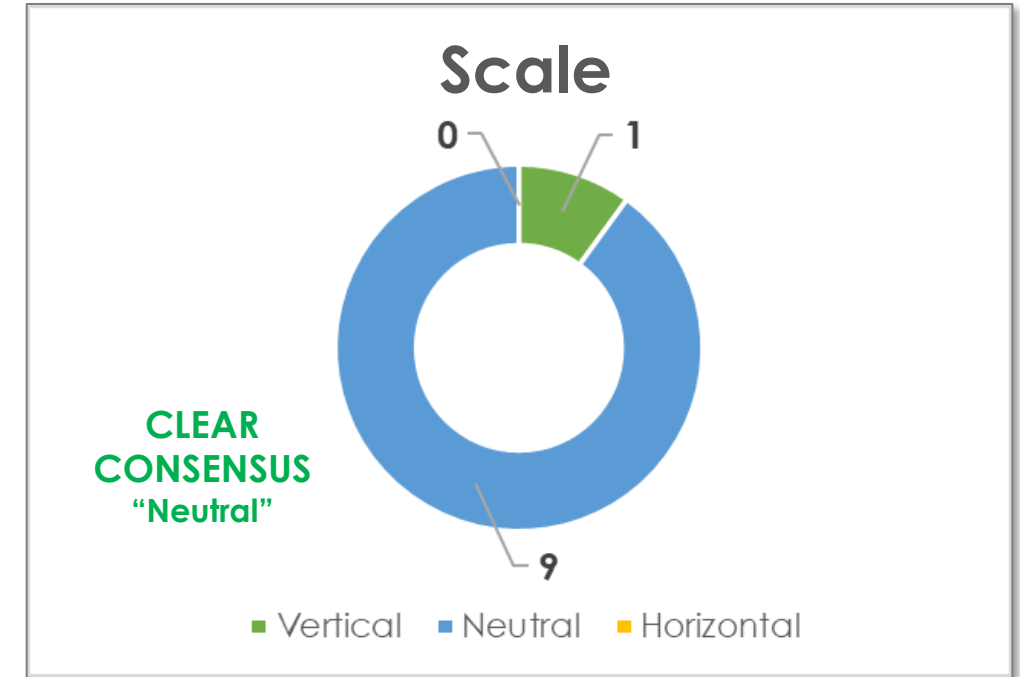

## What Do You Like the Least?

- Old dated vertical entry
- Too many horizontal planes
- Horizontal is too simple



# PAT Mtg#4 Engagement: Architectural Expression PAT Feedback

**5. Materiality**  
How do the building materials (quantity, composition and type) shape the exterior?

**Multiple Types of materials**  
  
**Materials Shape Massing**  
Large Shapes, Multiple Materials break down the building scale (Masonry, Glass, Metal, Wood)

**Limited Range of materials**  
  
**Field Material with Color Accents**  
Field Material = Brick  
Accents = Strikes of Color

**Single Type of material**  
  
**Single Field Material**  
Brick Field Material = One Material  
Limited Accents (Texture, Shape)

Page 52

## What Do You Like the Most?

- Cohesive multiple materials
- Dynamic and breaking scales in the building
- Modern clean windows
- Diverse materials in the context of the neighborhood

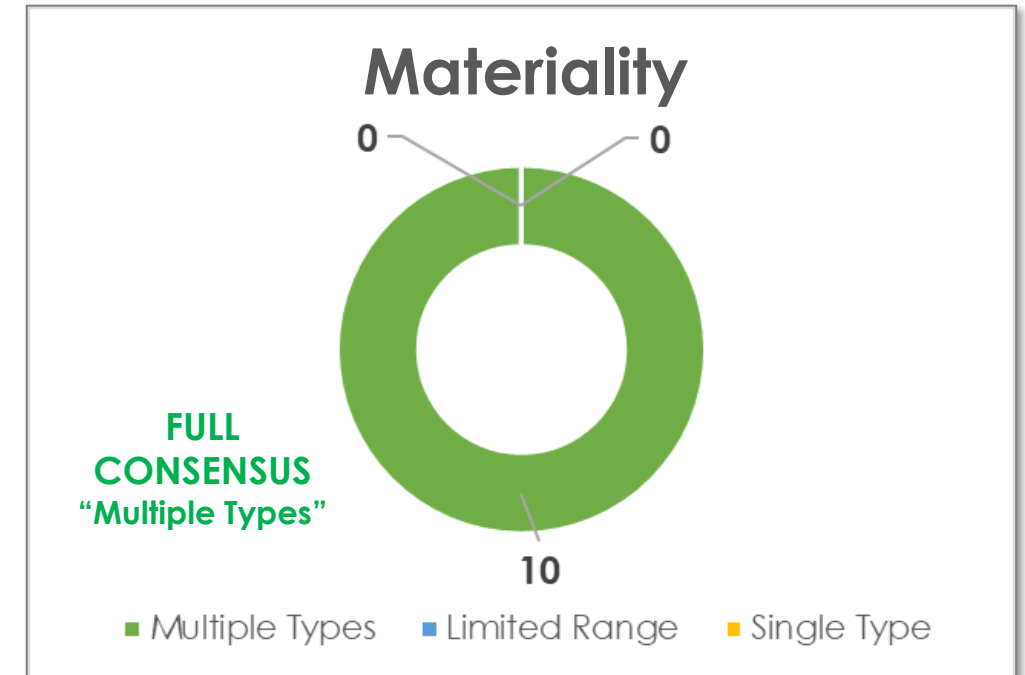

## What Do You Like the Least?

- “single” is too plane for our community
- “single” is uninviting
- “single” is too dull
- Overuse of materials



# PAT Mtg#4 Engagement: PAT Results | Individual Responses



## PAT Input - Results

### Full Consensus

Composition  
Materiality

### Strong Consensus

Shape  
Scale

### Consensus

Tone & Tenor

## PAT Mtg #4 – Exterior Architectural Expression Worksheet

Name: \_\_\_\_\_

Exterior Design Element	Select Your Individual Preference	Comments on Images
<b>1 Composition:</b> As viewed from the street, what does the building communicate?	Formal 0           Hybrid 0           Informal 10	What do you like <u>most</u> ?  What do you like <u>least</u> ?
<b>2 Tone &amp; Tenor:</b> How does composition of the building materials look/feel?	Neutral / Natural 3           Hybrid 5           Colorful / Vibrant 2	What do you like <u>most</u> ?  What do you like <u>least</u> ?
<b>3 Shape:</b> How does building shape relate to the surrounding context?	Orthogonal & Geometric 0           Hybrid 1           Organic & Sculptural 9	What do you like <u>most</u> ?  What do you like <u>least</u> ?
<b>4 Scale:</b> Identify Statement? Entry Approach Feel?	Vertical 1           Neutral 9           Horizontal 0	What do you like <u>most</u> ?  What do you like <u>least</u> ?
<b>5 Materiality:</b> How do the building materials (quantity, composition, type) shape the exterior?	Multiple Types 10           Limited Range 0           Single Type 0	What do you like <u>most</u> ?  What do you like <u>least</u> ?



# PAT Mtg#4 Engagement: PAT Consensus | Exterior Expression

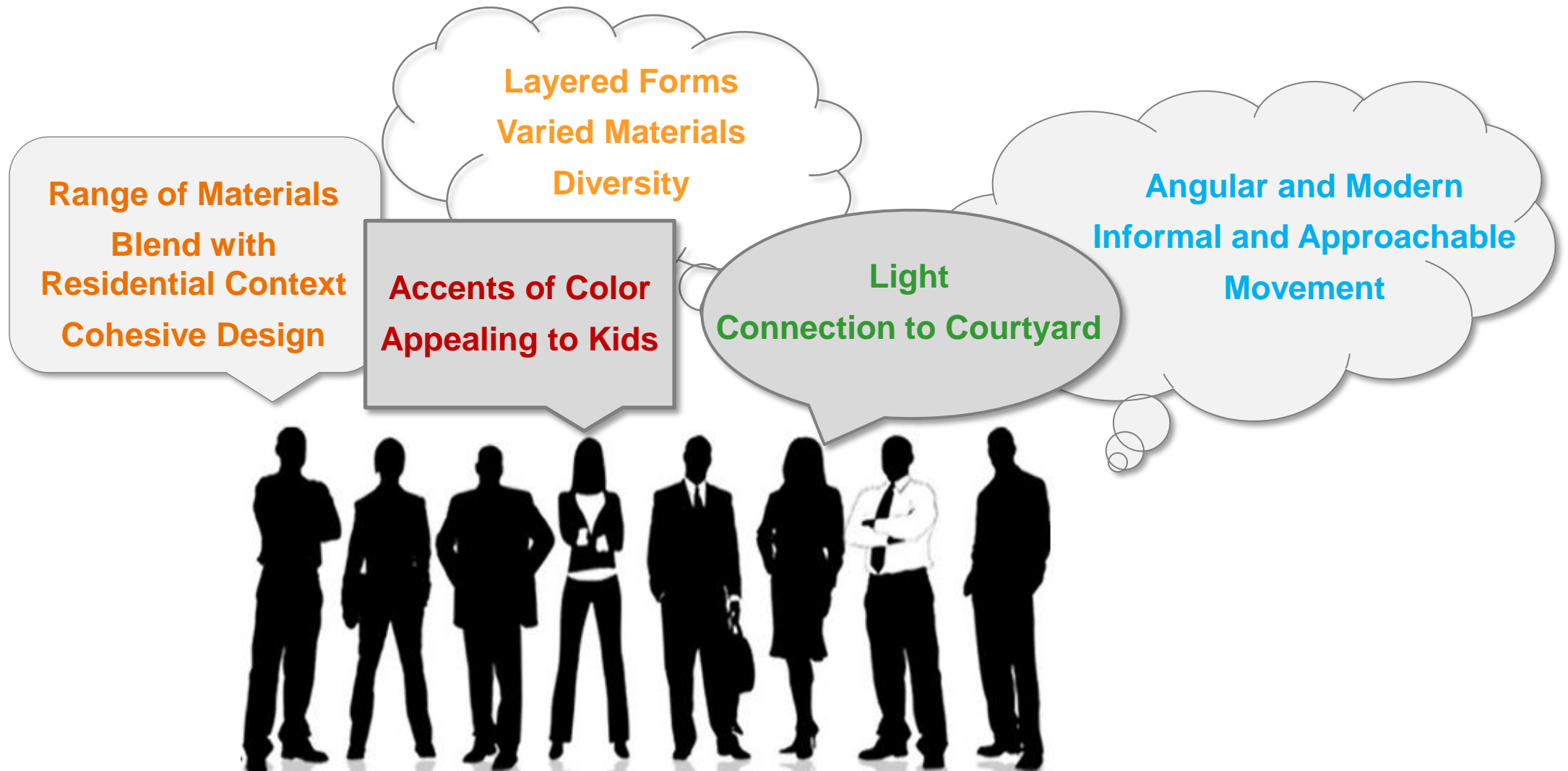

## PAT Consensus – Exterior Expression Elements

Composition | Tone & Tenor | Shape | Scale | Materiality



## WOODVIEW ES DESIGN PRINCIPLES

1. The selection of building materials **unifies** the design and **reflects the residential neighborhood**.
2. The **informal composition** and **modern angular forms** encourage discovery and creativity for the students.
3. Accents of **colors** appealing to kids are **fun and inviting**.
4. **Layered forms** and varied materials represent the **diversity** of the WVE school community.
5. **Ample glazing** reveals the dynamic movement through the school while providing **abundant daylight** to interior spaces.



# PAT Mtg#5: Design Progress | Preliminary Exterior Views

**PAT Feedback  
Influenced the  
Exterior Design**

- **Shape, Movement, Diversity** (Composition)
- **Taller vertical entry** (Shape)
- **Modern variety of shapes** (Scale)

**Street View from Bunker Hill**



**The selection of building materials unifies the design and reflects the residential neighborhood.**



# PAT Mtg#5: Design Progress | Preliminary Exterior Views

**PAT Feedback  
Influenced the  
Exterior Design**

- **Different layers are fun and inviting (Shape)**
- **Draw attention to entry with tall windows (Scale)**
- **Diversity of glass, masonry, and metal (Tone & Tenor)**

**Front Entry Plaza**



**The informal composition and modern angular forms encourage discovery and creativity for the students**



# PAT Mtg#5: Design Progress | Preliminary Exterior Views

**PAT Feedback  
Influenced the  
Exterior Design**

- **Neutral blend with houses** (Tone & Tenor)
- **Neutral and balanced allows diversity** (Scale)
- **Some amount of accent color** (Tone & Tenor)

**View from Cedardale**



**Accents of colors appealing to kids are fun and inviting**



# PAT Mtg#5: Design Progress | Preliminary Exterior Views

**PAT Feedback  
Influenced the  
Exterior Design**

- **Inviting and encourages imagination** (Composition)
- **Balanced and diverse design** (Scale)
- **Diversity in design shape and color** (Materiality)

**Learning Courtyard**

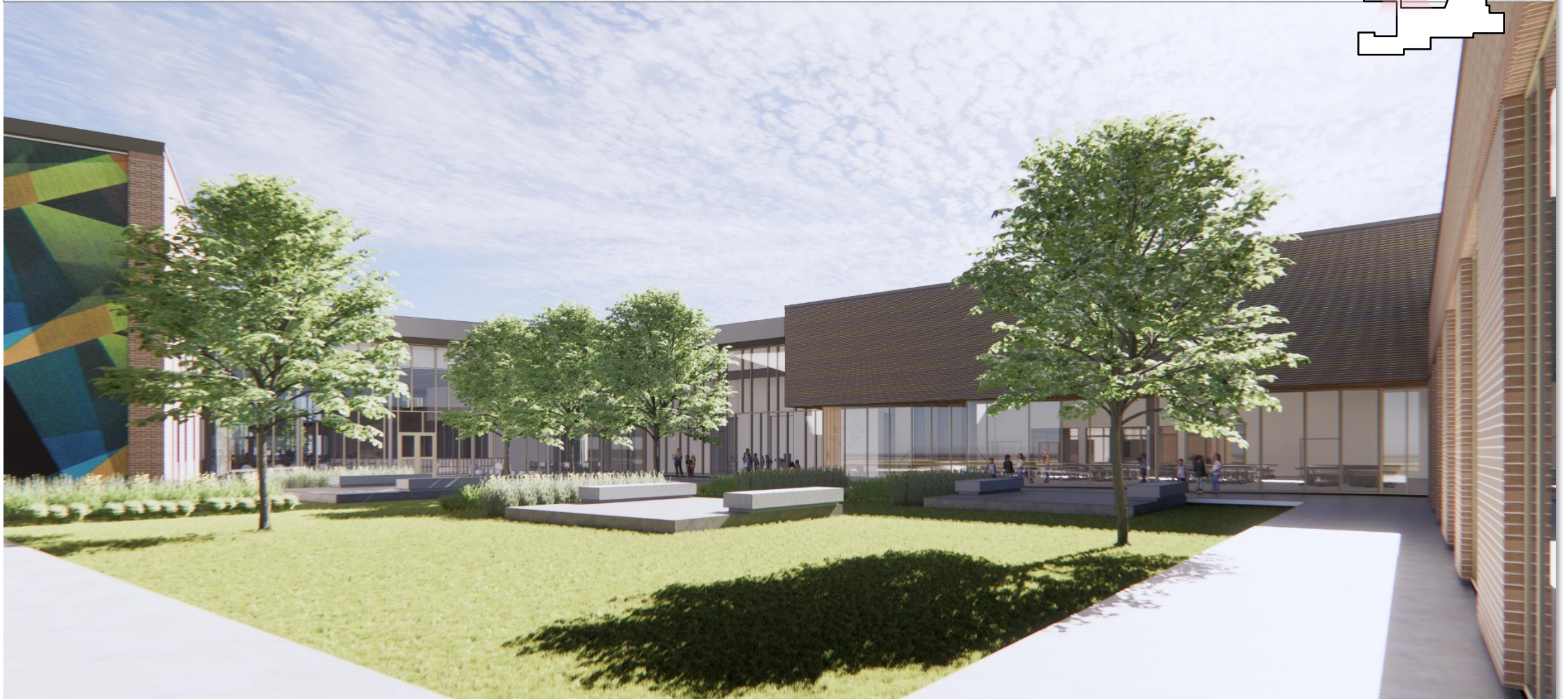
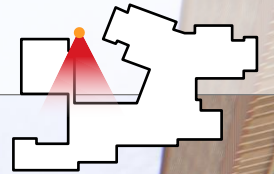

**Layered forms and varied materials represent the diversity of the WVE school community**



# PAT Mtg#5: Design Progress | Preliminary Exterior Views

**PAT Feedback  
Influenced the  
Exterior Design**

- **Shape, Movement, Diversity** (Composition)
- **Bright colors and playful** (Tone & Tenor)
- **Breaking the scales with different materials** (Materiality)

**Learning Courtyard**

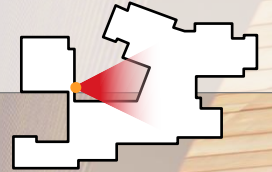

**Ample glazing reveals the dynamic movement through the school while providing abundant daylight to interior spaces**



# PAT Mtg#5: Design Progress | Building Massing

WOODVIEW ELEMENTARY SCHOOL





# PAT Mtg#5: Design Progress | Building Massing

WOODVIEW ELEMENTARY SCHOOL





**PAT Mtg#5: Design Progress | Preliminary Exterior Views**

PAT Feedback Influenced the Exterior Design

- Shape, Movement, Diversity (Composition)
- Taller vertical entry (Shape)
- Modern variety of shapes (Scale)

Street View from Bunker Hill



The informal composition and modern angular forms encourage discovery and creativity for the students

Page 33

**PAT Mtg#5: Design Progress | Preliminary Exterior Views**

PAT Feedback Influenced the Exterior Design

- Shape, Movement, Diversity (Composition)
- Bright colors and playful (Tone & Tenor)
- Breaking the scales with different materials (Materiality)

Learning Courtyard

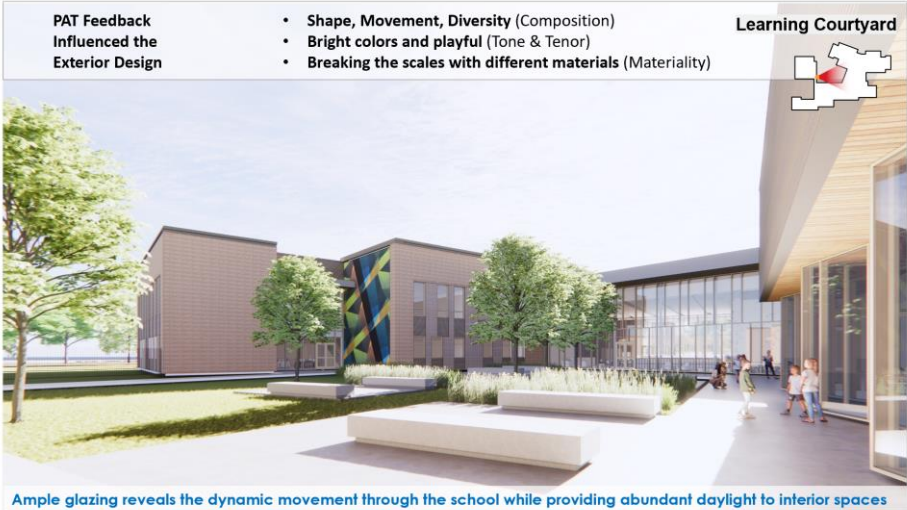

Ample glazing reveals the dynamic movement through the school while providing abundant daylight to interior spaces

Page 37

## Does the Exterior Design Progress Respond to the WVE Design Principles?

### WOODVIEW ES DESIGN PRINCIPLES

1. The selection of building materials **unifies** the design and **reflects the residential neighborhood**.
2. The **informal composition** and **modern angular forms** encourage discovery and creativity for the students.
3. Accents of **colors** appealing to kids are **fun and inviting**.
4. **Layered forms** and varied materials represent the **diversity** of the WVE school community.
5. **Ample glazing** reveals the dynamic movement through the school while providing **abundant daylight** to interior spaces.

YES

☐

NO

☐

# Item 4

## PAT MEETING #5 Interior Expression

### Explore Interior Architectural Expression “Elements”

Walls | Floors | Ceiling | Features – Texture, Pattern, Transparency

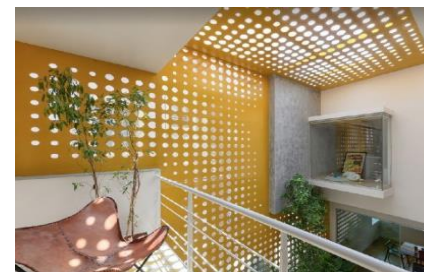

Color/Contrast | Shape/Scale | Pattern/Variation | Materiality



## “Rules” of Engagement Discussion:

We are seeking PAT Input on the INTERIOR Architectural Expression

These images are NOT the proposed design

Stantec will highlight the “Elements / Attributes” of the image shown

## Review / Discuss 4 “Attributes” from Selected Images:

Color & Contrast    Shape & Scale    Pattern & Variation    Materiality

PAT Feedback: Individual Completion of Interior Expression Worksheet



# PAT Mtg#5: Preliminary Interior View | School Lobby with Courtyard View

WOODVIEW ELEMENTARY SCHOOL



From Lobby

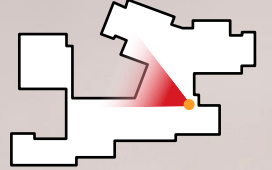



# PAT Mtg#5: Preliminary Interior View | Library with Views to Exterior

WOODVIEW ELEMENTARY SCHOOL



Library

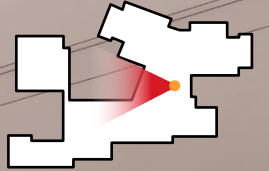



# PAT Mtg#5: Preliminary Interior View | Dining Space with Courtyard View

WOODVIEW ELEMENTARY SCHOOL



Dining

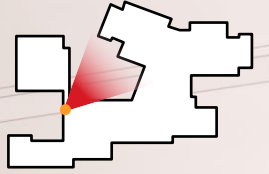



# PAT Mtg#5: Preliminary Interior View | Dining Space with Courtyard View

WOODVIEW ELEMENTARY SCHOOL





# PAT Mtg#5: Preliminary Interior View | Flex Space with Outdoor Views

WOODVIEW ELEMENTARY SCHOOL



Collaboration

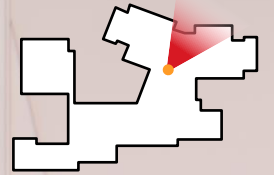



# PAT Mtg#5: Preliminary Interior View | Flex Space with Courtyard View

WOODVIEW ELEMENTARY SCHOOL



Flex Space

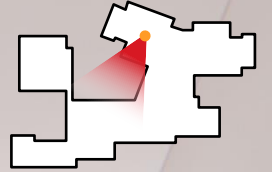



# 1. Color and Contrast

How do the colors and contrast influence the character of the space?

## Natural Tones with Accents of Color



**Natural Tones**  
High Contrast



**Natural Tones**  
Low Contrast



**Accents**  
Medium Contrast



**Color Wash**  
Low Contrast

## Vibrant and Full-spectrum Color

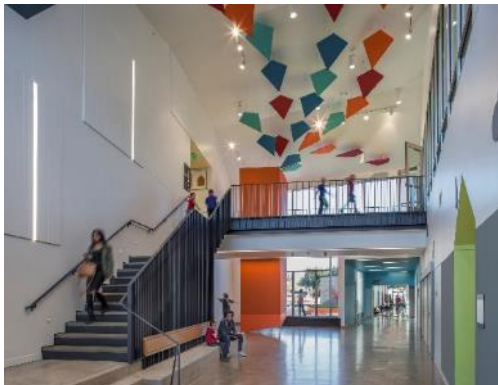

**Bright Color**  
High Contrast



**Bright Color**  
Medium Contrast



**Saturated**  
Low Contrast



## 2. Shape and Scale

What kind of experience do the shapes and their scale create?

### Geometric and Linear



**Large-scale**  
Rectangles



**Mixed-scale**  
Rectangles



**Large-scale**  
Advanced Geometries

### Organic and Curvilinear



**Large-scale**  
Single



**Balance**  
Angular/Curvilinear



**Small-scale**  
Multiple



# 3. Pattern and Variation

How do the patterns relate to or reinforce the building design and the site?

## Linear and Predictable



Linear  
**Limited Variation**



Linear and Rectilinear  
**Varied**



Rectilinear  
**Varied, with Contrast**



Rectilinear  
**Predictable, Stand-alone**

## Natural and Random



Linear / Random



Linear + Random



Linear + Random



Blended



# 4. Materiality

How does the material selection relate to the site, the building and the function of the interior?

## Similar to Building Materials



Glass, Metal, Masonry



Glass, Metal, Wood, Masonry



Glass, Metal, Tile, Stone

## Expanded Range of Interior Materials



Glass, Metal, Wood, Stone,  
Tile



Masonry, Wood, Carpet,  
Textiles



Wood, Tile, Polished Floor,  
Textiles



# PAT Mtg#5 Engagement: Individual Response Worksheet

## PAT Input



## INTERIOR Expression

Engagement Activity:

10-15 min Individual Input

Select YOUR Preferred Choice for each of the INTERIOR Expression 4 Design Elements:

- Color & Contrast
- Shape & Scale
- Pattern & Variation
- Materiality











Provide Comments on what **ELEMENTS** you like the most/least in the image(s) you have seen.

We will collect these worksheets and see where we have consensus from the PAT.

**THANK YOU** for your feedback in shaping the design of the New Woodview ES!

### WVE PAT Mtg #5 – Interior Architectural Expression Worksheet

Name: \_\_\_\_\_

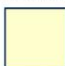
Interior Design Element	Select Your Individual Preference	Comments on Images
<b>1 Color &amp; Contrast:</b> How do the colors and contrast influence the character of the space?	Natural Tones w/ Accent Color  Hybrid  Vibrant and Full Spectrum Color 	What do you like <u>most</u> ?  What do you like <u>least</u> ?
<b>2 Shape &amp; Scale:</b> What kind of experience do the shapes and their scale create?	Geometric / Linear  Hybrid  Organic / Curvilinear 	What do you like <u>most</u> ?  What do you like <u>least</u> ?
<b>3 Pattern &amp; Variation:</b> How do the patterns relate to or reinforce the building design and the site?	Linear / Predictable  Hybrid  Natural / Random 	What do you like <u>most</u> ?  What do you like <u>least</u> ?
<b>4 Materiality:</b> How does the material selection relate to the site, the building and the function of the interior?	Similar to Building Materials  Hybrid  Expanded Range of Interior Materials 	What do you like <u>most</u> ?  What do you like <u>least</u> ?



# Item 5

**NEXT STEPS**





# PAT Engagement – Process Overview | Status Update

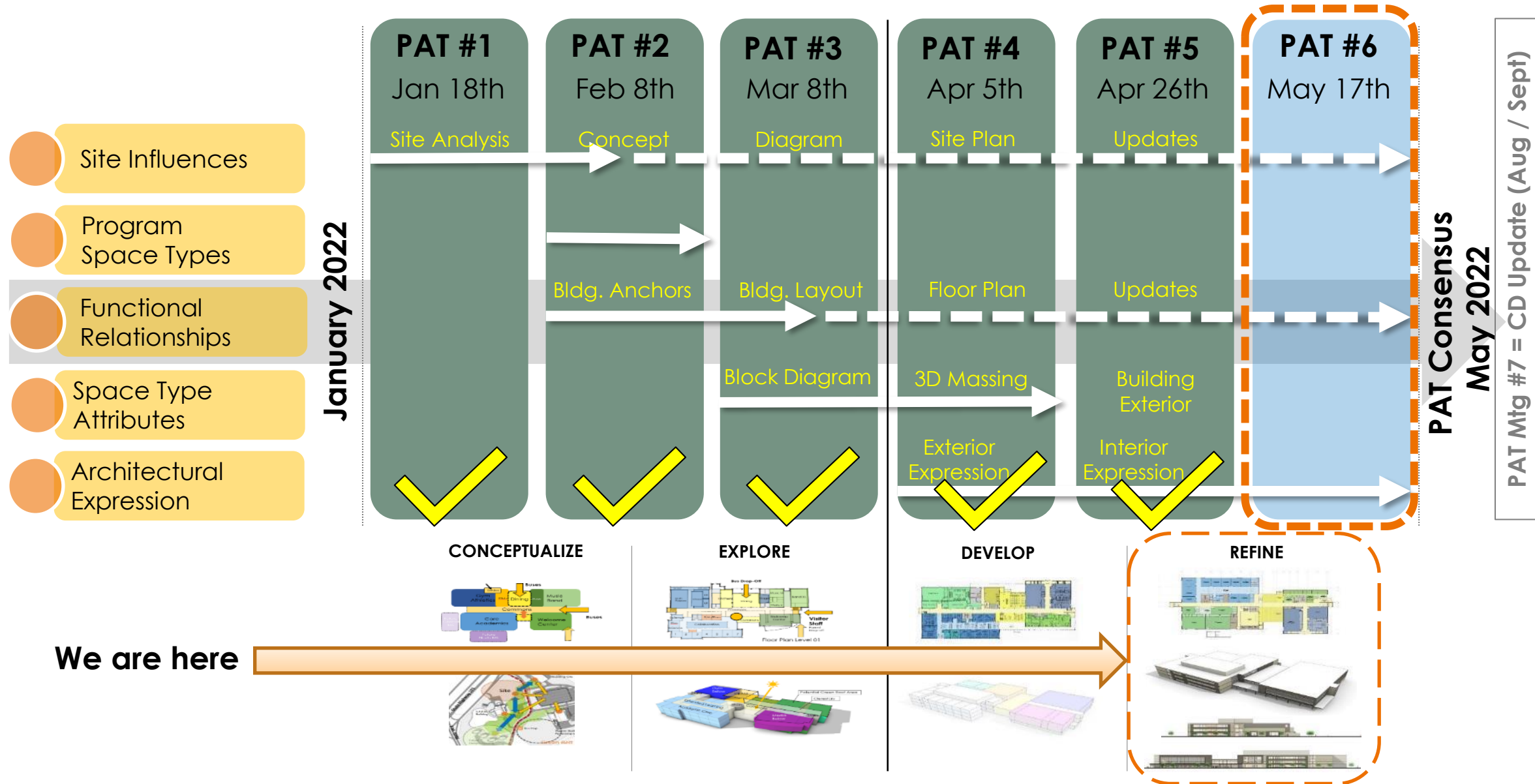



# PAT Meeting #5 – What's Happening Next?



**SEEK PAT CONSENSUS**  
on Design Recommendation

**PAT Mtg#5 Engagement: Exterior Design Progress** **PAT Poll**

**PAT Mtg#5: Design Progress | Preliminary Exterior Views**

**RF Feedback**  
Influenced the Exterior Design

- Shape, Movement, Diversity (Composition)
- Color and Material (Form & Function)
- Modern variety of shapes (Scale)

**Street View from Bunker Hill**

The informal composition and modern angular forms encourage discovery and creativity for the students.

**PAT Mtg#5: Design Progress | Preliminary Exterior Views**

**RF Feedback**  
Influenced the Exterior Design

- Shape, Movement, Diversity (Composition)
- Color and Material (Form & Function)
- Breaking the scales with different materials (Materiality)

**Learning Courtyard**

Ample glazing reveals the dynamic movement through the school while providing abundant daylight to interior spaces.

**Does the Exterior Design Progress Respond to the WVE Design Principles?**

**WOODVIEW ES DESIGN PRINCIPLES**

1. The selection of building materials unifies the design and reflects the residential neighborhood.
2. The informal composition and modern angular forms encourage discovery and creativity for the students.
3. Accents of colors appealing to kids are fun and inviting.
4. Layered forms and varied materials represent the diversity of the WVE school community.
5. Ample glazing reveals the dynamic movement through the school while providing abundant daylight to interior spaces.

**YES** **NO**

☐ ☐

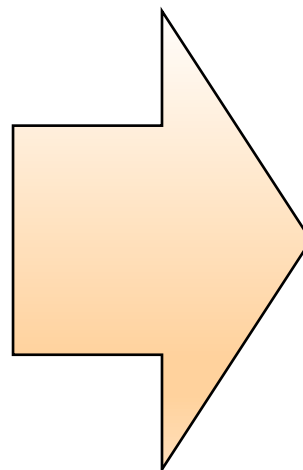

**PAT Mtg#5 Engagement: Individual Response Worksheet**

**PAT Input**

**INTERIOR Expression**

**Engagement Activity:**  
10-15 min Individual Input

Select YOUR Preferred Choice for each of the INTERIOR Expression 4 Design Elements:

- Color & Contrast
- Shape & Scale
- Pattern & Variation
- Materiality

Provide Comments on what ELEMENTS you like the most/least in the image(s) you have seen.

We will collect these worksheets and see where we have consensus from the PAT.

THANK YOU for your feedback in shaping the design of the New Woodview ES!

**WVE PAT Mtg #5 – Interior Architectural Expression Worksheet**

Name: \_\_\_\_\_

Design Element	Color & Contrast	Shape & Scale	Pattern & Variation	Materiality	Comments and Notes
1. Color & Contrast: How do the colors and textures influence the character of the space?	<input type="checkbox"/> Natural <input type="checkbox"/> Neutral <input type="checkbox"/> Bold	<input type="checkbox"/> Natural <input type="checkbox"/> Neutral <input type="checkbox"/> Bold	<input type="checkbox"/> Natural <input type="checkbox"/> Neutral <input type="checkbox"/> Bold	<input type="checkbox"/> Natural <input type="checkbox"/> Neutral <input type="checkbox"/> Bold	What do you like best?
2. Shape & Scale: How do the shapes and scales influence the character of the space?	<input type="checkbox"/> Geometric <input type="checkbox"/> Organic <input type="checkbox"/> Natural	<input type="checkbox"/> Geometric <input type="checkbox"/> Organic <input type="checkbox"/> Natural	<input type="checkbox"/> Geometric <input type="checkbox"/> Organic <input type="checkbox"/> Natural	<input type="checkbox"/> Geometric <input type="checkbox"/> Organic <input type="checkbox"/> Natural	What do you like best?
3. Pattern & Variation: How do the patterns and textures influence the character of the space?	<input type="checkbox"/> Solid <input type="checkbox"/> Patterned <input type="checkbox"/> Textured	<input type="checkbox"/> Solid <input type="checkbox"/> Patterned <input type="checkbox"/> Textured	<input type="checkbox"/> Solid <input type="checkbox"/> Patterned <input type="checkbox"/> Textured	<input type="checkbox"/> Solid <input type="checkbox"/> Patterned <input type="checkbox"/> Textured	What do you like best?
4. Materiality: How do the materials influence the character of the space?	<input type="checkbox"/> Solid <input type="checkbox"/> Patterned <input type="checkbox"/> Textured	<input type="checkbox"/> Solid <input type="checkbox"/> Patterned <input type="checkbox"/> Textured	<input type="checkbox"/> Solid <input type="checkbox"/> Patterned <input type="checkbox"/> Textured	<input type="checkbox"/> Solid <input type="checkbox"/> Patterned <input type="checkbox"/> Textured	What do you like best?





**See you at PAT Mtg #6**

**May 17, 2022  
3:30 PM**

Woodview  
Elementary School

**THANK YOU!**