

# Cedar Brook Elementary School Addition and Renovations

Project Advisory Team Meeting #7

# MEETING AGENDA

- + Welcome and Introductions
- + Project Description
- + Project Status Update
- + Scope of Work
- + Next Steps

# PROJECT TEAM

- + Spring Branch ISD (SBISD)
- + Cedar Brook Elementary (CBE)
- + Project Advisory Team (PAT)
- + Huckabee (Architects)
- + Satterfield and Pontikes (Construction Manager @ Risk)

# PROJECT DESCRIPTION

- + Our charge is to bring the Cedar Brook Elementary School campus as close to current district standards as possible and to approach upgrades to the campus in a way that will serve SBISD and Cedar Brook community for the next twenty-years.
- + The purpose of our fact-finding investigations, project advisory team meetings and visioning sessions was to pinpoint design goals and priorities.
- + The meetings resulted in providing a new Addition with six (6) new classrooms, a science lab and two (2) music rooms and the renovation of the interior of the existing building.

# PROJECT ADVISORY TEAM CHARGE

- + **Project Advisory Team (PAT)** – is a select group of parents, community members, school staff, SBISD personnel and Bond Committee liaison.
  - Each Project Advisory Team's (PAT) members are charged with providing input into planning and design development for their school's renovation project in the 2017 Bond Program.
  - The PAT works collaboratively and cooperatively with the architect and SBISD Project Manager to conceptualize, develop and refine the project's final goals and design.
  - The PAT met in a series of six meetings beginning in January 2019 and completing in May 2019.
  - The PAT reached its recommendations through consensus on a variety of proposed design areas.

# PROJECT STATUS UPDATE

①

SCHEMATIC DESIGN PHASE – DECEMBER 2018 – APRIL 2019



②

DESIGN DEVELOPMENT PHASE – APRIL 2019 – JUNE 2019



③

CONSTRUCTION DOCUMENT PHASE – JUNE 2019 – AUGUST 2019



④

PROCUREMENT PHASE – AUGUST 2019 – SEPTEMBER 2019



⑤

CONSTRUCTION PHASE – OCTOBER 2019 – AUGUST 2021



# SCOPE OF WORK

# BUILDING SITE PLAN

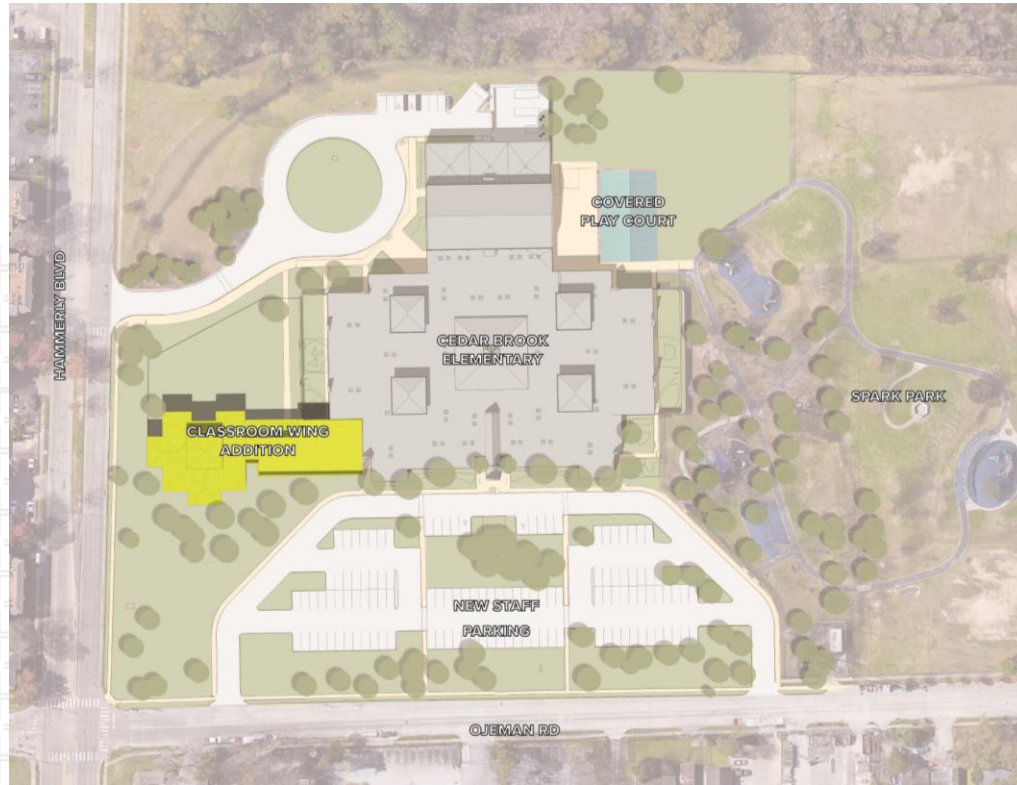

- New Faculty / Staff Parking (36 new spaces / 136 total spaces)
- New Classroom Wing Addition
- Mechanical System Upgrades



# OVERALL BUILDING PLAN WITH NEW ADDITION

2019

Feb. — April — June — Aug. — Oct. — Dec.

2021

Feb. — April — June — Aug. — Oct. — Dec.

October 2019

August 2021



- Skylight Replacement & Library Renovation
- Clerestory Windows & Collaboration Renovation
- Restroom Renovation
- Cafeteria/Gym Renovation
- Entry Renovation
- Mechanical/HVAC Improvements
- New Fall Protection Surface
- New Classroom Addition

- + Roof Repair
- + Technology Improvements
- + Replace Existing Lay-In Ceilings
- + Site Improvements/Relocate Staff Parking Lot

# INTERIOR TOP PRIORITIES

1. Classrooms – Match district standards for the teaching wall to maximize teaching and display/pin-up areas.
2. Library – Perimeter glass partitions and acoustical treatment.
3. Library – Create multi-functional zones with flexible furniture. Small, versatile reading and conference room space.
4. Collaboration – More natural light in the spaces and provide visibility from the Classrooms.
5. Collaboration – Writable wall surfaces, display areas, and active technology walls.

# MAIN LOBBY AND ENTRY

- Improved Interior Lighting
- New Reception Counter
- Security Upgrades at Vestibules
- New Environmental Graphics
- New Waiting Area Furniture

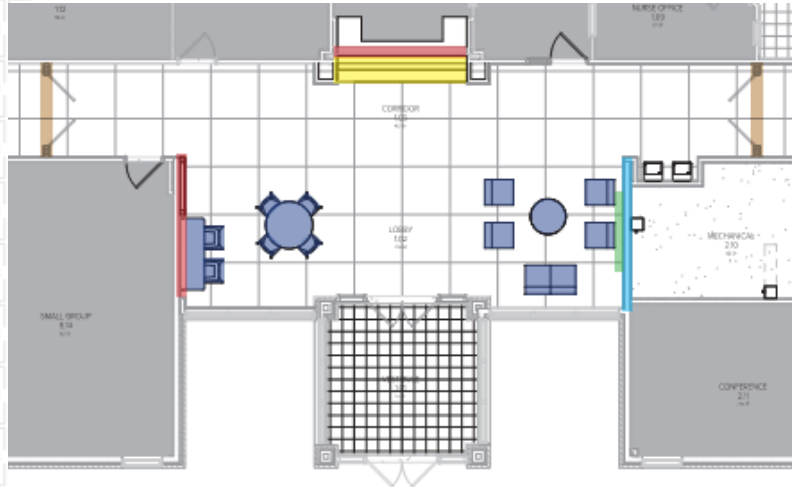

# LIBRARY AND BROADCAST STUDIO

- Improved Lighting and Acoustics
- Creative Reading Zones
- Flexible Furniture
- Enhanced Meeting Spaces
- New Broadcast Studio
- Improved Technology Throughout

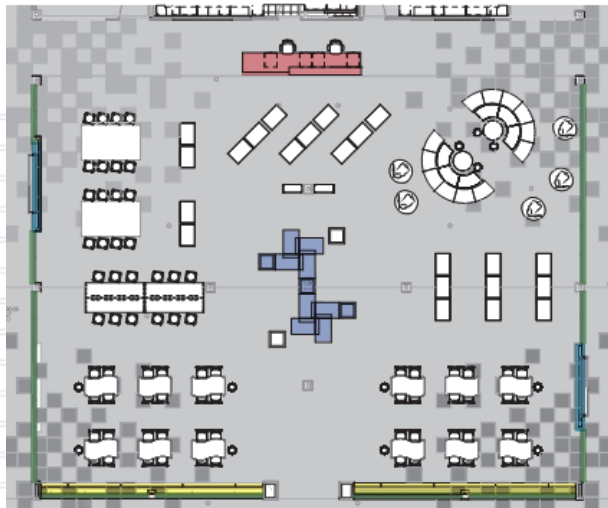

# CLASSROOMS AND COLLABORATION AREAS

- Natural Lighting in Collaboration Spaces
- New Active Walls in Classrooms
- New Finishes in Classrooms
- Neighborhood Branding
- New Environmental Graphics
- Student Restroom Renovations
- New Flexible Furniture in Collaboration Spaces
- Replacement of Classroom Doors
- Door and Hardware Upgrades





# MASTER FINISH PLAN – FLOOR PATTERN

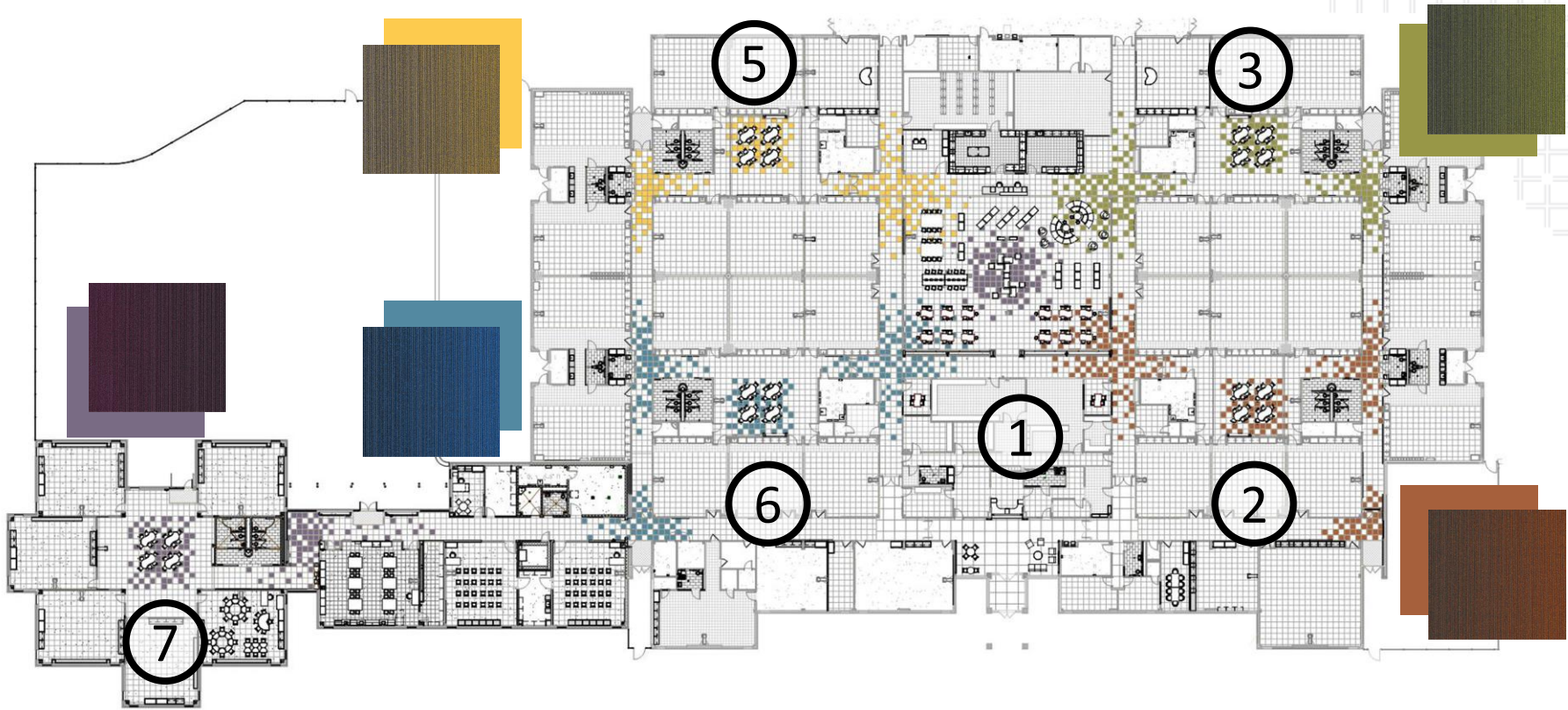

# ENVIRONMENTAL GRAPHICS – AREA 2 & 3

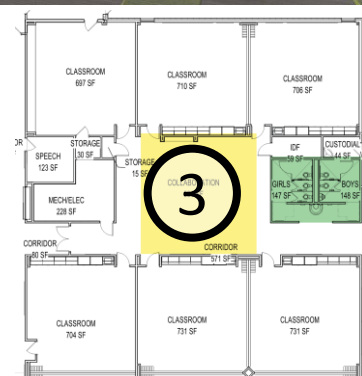

# ENVIRONMENTAL GRAPHICS – AREA 5 & 6

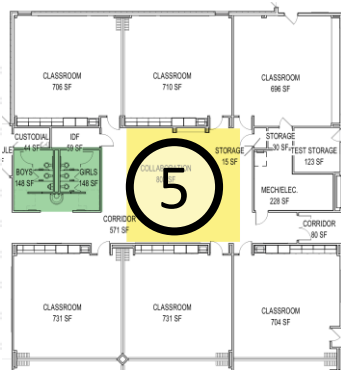

# ENVIRONMENTAL GRAPHICS – AREA 7



# CAFETERIA AND GYMNASIUM

- Enhanced Acoustics in Gym and Cafeteria
- Replacement of Operable Partition
- Mechanical System Upgrades
- New Outside Air Units
- New 90-Ton Chiller
- Replacement of Standing Seam Metal Roof



# DIGITAL MATERIAL BOARD – INTERIOR FINISHES

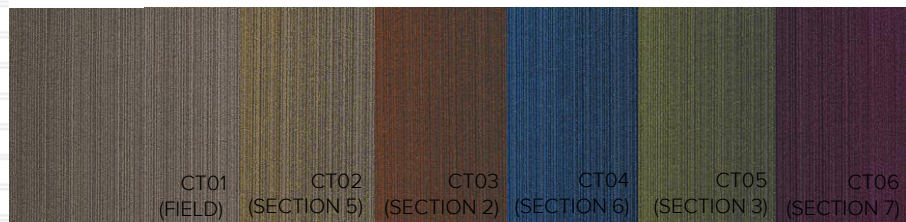
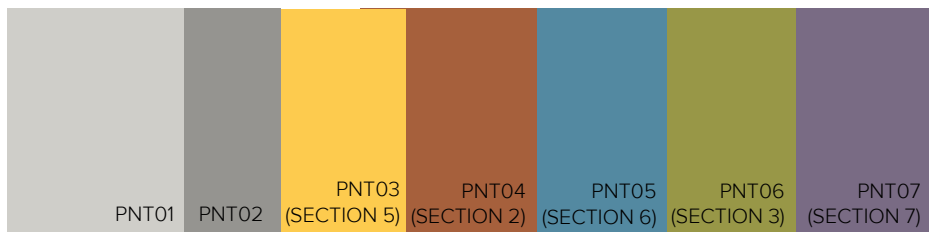

# FURNITURE SELECTION

5<sup>TH</sup> GRADE CLASSROOM

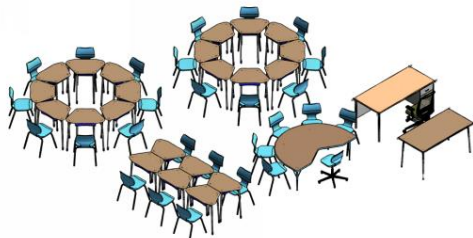
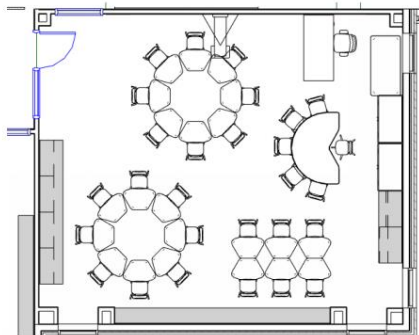

Itemized List  
 24 – Student Desks  
 29 – Student Chairs  
 1 – Kidney Table  
 1 – 30"x72" Table  
 1 – 30"x66" Teacher Desk  
 1 – Teacher Task Chair  
 1 – Teacher Classroom Chair

5<sup>TH</sup> GRADE CLASSROOM



Smith System  
 Flavors 18"sh 4 Leg Chair  
 Seat: Charcoal; Frame: Chrome



Smith System  
 Silhouette Arc-8 Desk, no Casters  
 Laminate: High Rise; Edge: Charcoal;  
 Frame: Platinum



Smith System  
 Silhouette Arc-8 Desk, no Casters  
 Laminate: High Rise; Edge: Charcoal;  
 Frame: Platinum



# FURNITURE SELECTION

## 5TH GRADE CLASSROOM



Hon  
Volt Task Chair w/Height Adj., Arms  
Back: Black Mesh; Seat: Black  
Leather

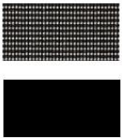

Hon  
34000 Series 30"x66" Single Pedestal Desk  
Laminate: Loft, Edge: Loft, Body: Platinum  
Metallic



Smith System  
Interchange 30"x72" table, no Casters  
Laminate: High Rise, Edge: Charcoal,  
Frame: Platinum



Smith System  
Flavors Hi Adj. Chair  
Seat: Charcoal; Frame: Black



Smith System  
Flavors 4 Leg Chair  
Seat: Charcoal; Frame: Chrome



## COLLABORATION AREAS

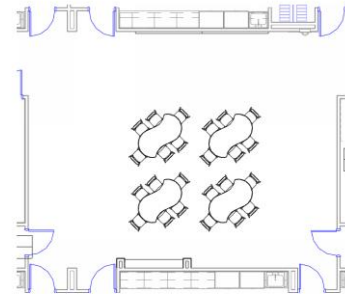

Smith System  
Squiggle Table  
Laminate: High Rise, Edge: Charcoal,  
Frame: Platinum



# FURNITURE SELECTION

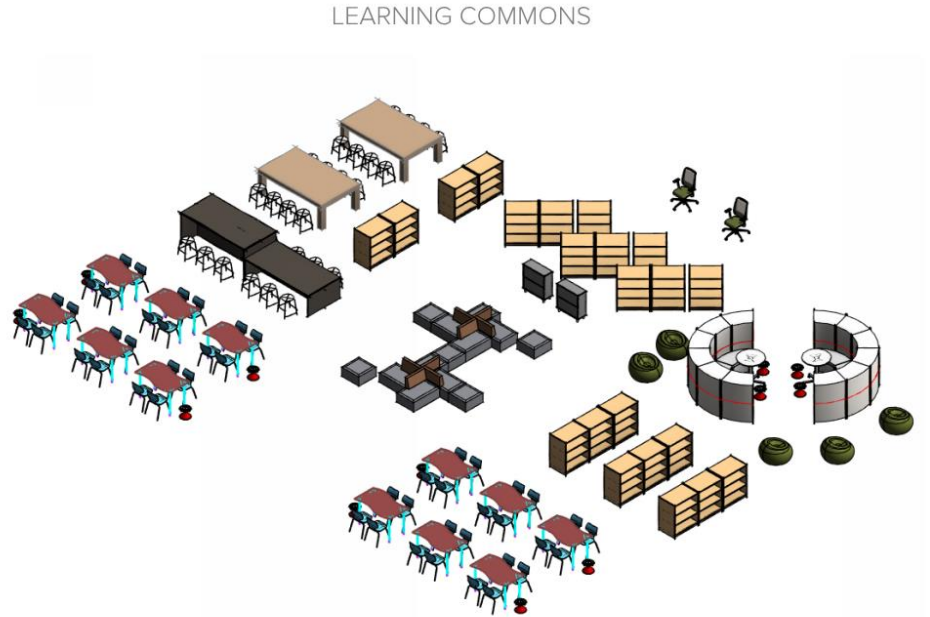
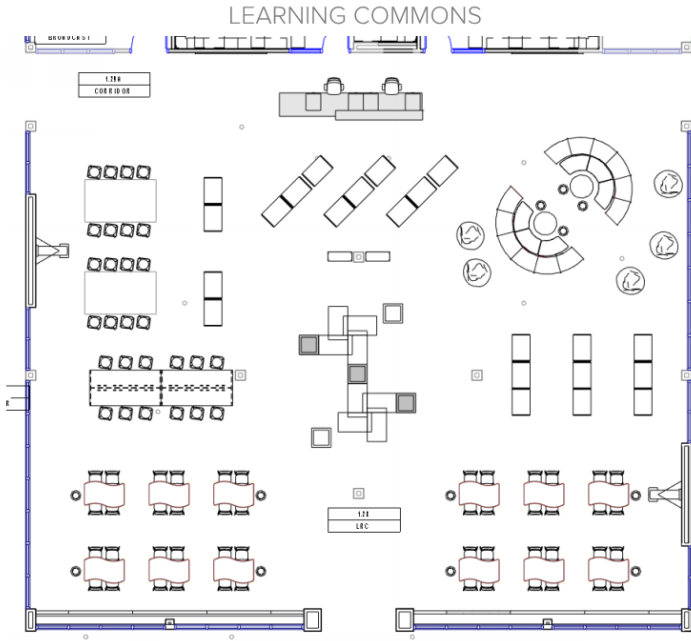

# FURNITURE SELECTION

## LEARNING COMMONS



Smith System  
Flavors 18"sh 4 Leg Chair  
Seat: Charcoal; Frame: Chrome



Alumi  
Ogee Breeze 30"x54" table, no Casters  
Laminate: High Rise; Edge: Gray; Frame: Metallic



VS  
Solo Stool  
Seat: Natural; Frame: Arctic



Existing Apple Table



JSI  
Reef Paneled Table 48"x96"  
Top: Clear (Matte) on Ash Solid Wood Plank; Laminate  
End Panels: TBD; Modesty Panel: Slate Gray



KI Hub  
Back: cf Stinson – Marquetry, color  
Zest; Seat: Pallas – Aphrodite, color  
Storm Cloud; Frame: Chrome



## LEARNING COMMONS



FomCore  
30" dia round Ottoman w/laminate top  
Sides: Pallas – Aphrodite, color Storm  
Cloud; Laminate: Wilsonart –  
Kensington Maple



FomCore  
Arc Ottoman  
Sides: Pallas – Aphrodite,  
color Nile



VS  
Hokki Stool  
Plastic: Black Grey



# FURNITURE SELECTION

## LEARNING COMMONS



Tesco  
Picture Book Shelving (with Backs)  
Wood: Maple; Finish: Natural



Jaxx  
Midtown Lounger  
Vinyl: Charcoal



Alumni  
Explorer Music Pitch Chair  
Plastic: Graphite; Frame: Metallic

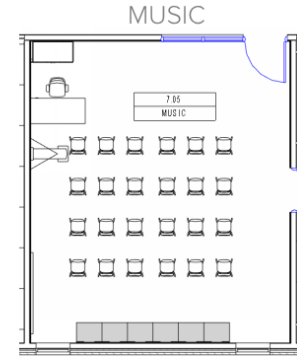
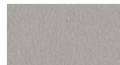

Hon  
34000 Series 30"x66" Single Pedestal Desk  
Laminate: Loft; Edge: Loft; Body: Platinum  
Metallic



Hon  
Volt Task Chair w/Height Adj. Arms  
Back: Black Mesh; Seat: Black  
Leather



# FURNITURE SELECTION

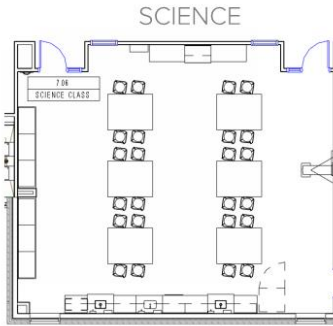

48"x 60" Open Frame  
Science Table  
Epoxy top, Wood Legs



VS  
Solo Stool  
Seat: Natural; Frame:  
Arctic



Smith System  
Flavors 4 Leg 18" sh Chair  
Flavors 28" sh Fixed Height Stool  
Seat: Charcoal; Frame: Chrome



KI Hub  
Armless Lounge Chairs & Sofa  
Back: Momentum – Hearsay, color Quarry;  
Seat: Pallas – Aphrodite, color Black Tide;  
Frame: Chrome



Smith System  
Sauggie Table  
Laminate: High Rise; Edge: Charcoal;  
Frame: Platinum



# FURNITURE SELECTION

## AP OFFICE

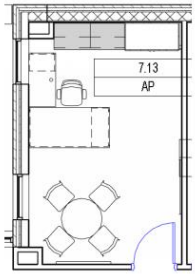

Hon  
Concinnity L-Shape Desk  
(l) BBF, (r) FF, Smooth Flat Edge,  
Canopy Pull, Frosted Modesty  
(l) 36" dia Preside Table w/X-Base  
Laminate: Pinnacle; Pulls: Platinum



Global  
Vion Mesh Medium Back Syncro-Tilt  
Task Chair w/Ht & Width Adj. Arms  
Back: Stone Mesh; Seat: Momentum –  
Millennium, color Onyx



Global  
Vion Mesh Low Back Arm Chair  
Back: Stone Mesh; Seat: Momentum –  
Millennium, color Onyx

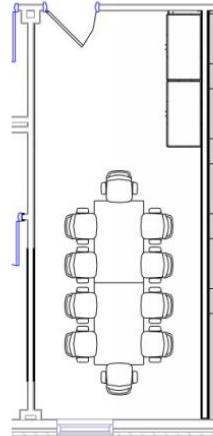

## CONFERENCE ROOM



Hon  
Preside Rectangular Table with T-Base  
Laminate: Pinnacle; Base: Platinum



Hon  
Volt Task Chair w/Mesh Back, and Ht  
Adj. Arms  
Back: Black Mesh; Seat: Black Leather



# NEW CLASSROOM WING ADDITION



# NEW CLASSROOM WING ADDITION



# NEXT STEPS

# PHASE OF CONSTRUCTION

11/19 - 08/20

06/20 - 08/20 (Summer)

06/21 - 08/21 (Summer)

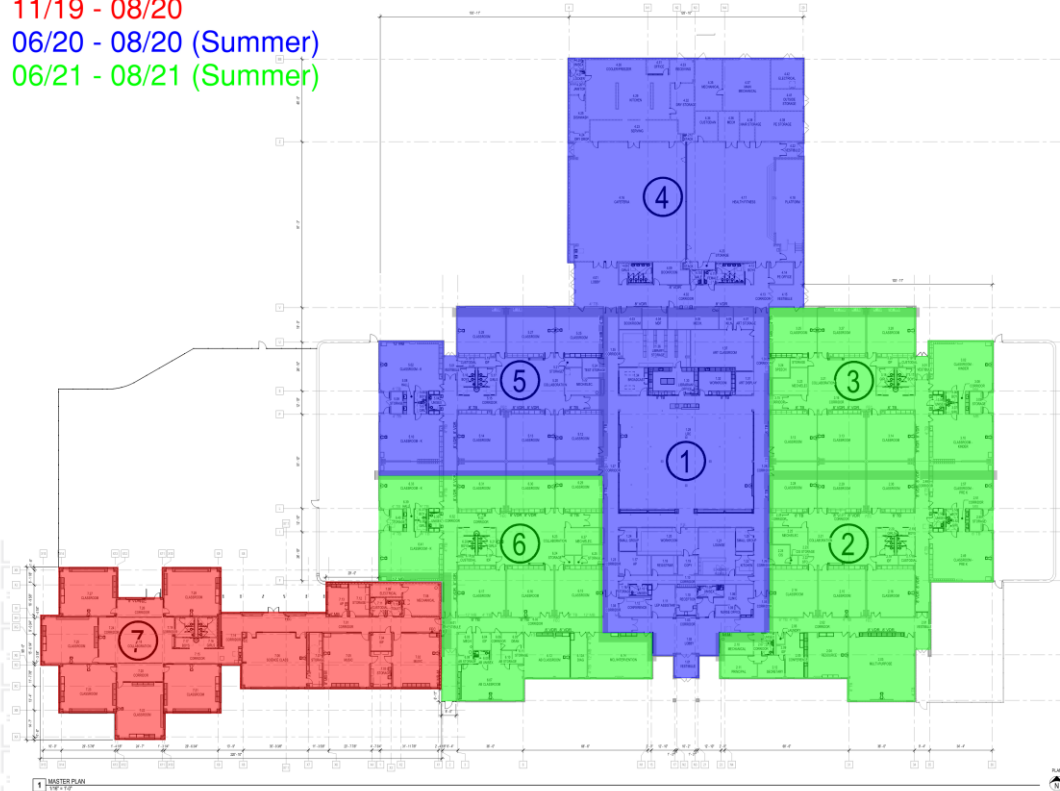

# DISCUSSION