



Memorial Drive Elementary

Project Advisory Team
Meeting #2
February 1, 2022



Introductions

SPRING BRANCH ISD

Thayer Hutcheson	Memorial Drive Elementary, Principal
Travis Stanford	Associate Superintendent for Operations
Max Buja	Planning & Construction, Director
David Valerius	Planning & Construction, Project Manager
Noel Moreno	Planning & Construction, Project Manager

STANTEC ARCHITECTURE

Jennifer Henrikson	Architect - Principal
Tracy Eich	Architect - Senior Design Principal
Gary Dunn	Architect - Senior Project Manager
Gin Kappler-Peeler	Architect - Senior Project Manager
Gretchen Diesel	Interior Designer - Senior Interior Designer



MDE Project Advisory Team (PAT) - Composition

17 Participants



PAT Committee Composition

Principal
Assistant Principal
CIT Staff
CIT Staff
CIT Staff
CIT Staff
CIT Staff
CIT Parent
CIT Parent
CIT Parent
CIT Parent
Parent Lottery Rep
Parent Lottery Rep
Staff Lottery Rep
CIT Business Rep
CIT Community Rep
Non-Bordering HOA Rep

11 = Memorial Drive ES
Staff + CIT Staff / Parent

03 = Lottery
Parent + Staff

03 = Community
Business + Piney Point Village + HOA

Introduce any PAT Members that were not at PAT Mtg#1



Agenda

1. **PAT Process:** Project/Process Status Update
2. **PAT Mtg #1 Engagement-1: Recap**
Design & Educational Vision
MDE Design Guiding Principles
3. **PAT Mtg #1 Engagement-2: Recap**
Site Organization Elements
4. **PAT Mtg #2 Engagement: Table Activity**
Building Anchors
5. **Next Steps:** What's Happening Next

Item 1

PAT PROCESS OVERVIEW Project / Process Status Update





New Memorial Drive Elementary School - Project Scope

- **Replacement of Memorial Drive Elementary School** with new building and site elements
- **Approx. 88,000 SF** building per SBISD Educational Specifications
- **Off Site Transition:** Campus will relocate to South Transition Campus from January 2023 thru May 2024
- **18-20 months** total construction period
- **August 2024 = New MDE opens**



PAT Engagement – Project Advisory Team (PAT) Charge

OVERVIEW

A Project Advisory Team (PAT) will be chartered for the planning of a replacement for **Memorial Drive Elementary School** under the school's project in the 2017 Bond Program.

CHARGE

The PAT will work collaboratively and cooperatively with the architect and SBISD Project Manager **to conceptualize, develop and refine the project's goals and design.**

The PAT will advise on recommendations regarding the interior and exterior appearance of the replacement of Memorial Drive Elementary School.

The PAT will reach a proposed recommendation through consensus.

These recommendations will be presented to the Superintendent + Board of Trustees for approval.
The Board of Trustees may act upon the recommendations developed with PAT input by approving, amending, altering or not approving all or any part of the recommendations.

Areas of focus from which the PAT should refrain include recommendations regarding school programs, policies and procedures, boundaries of district facilities, instructional arrangements and/or educational pedagogy decided upon and/or subject to District, State and Federal laws.



PAT Engagement – Process Overview | Status Update

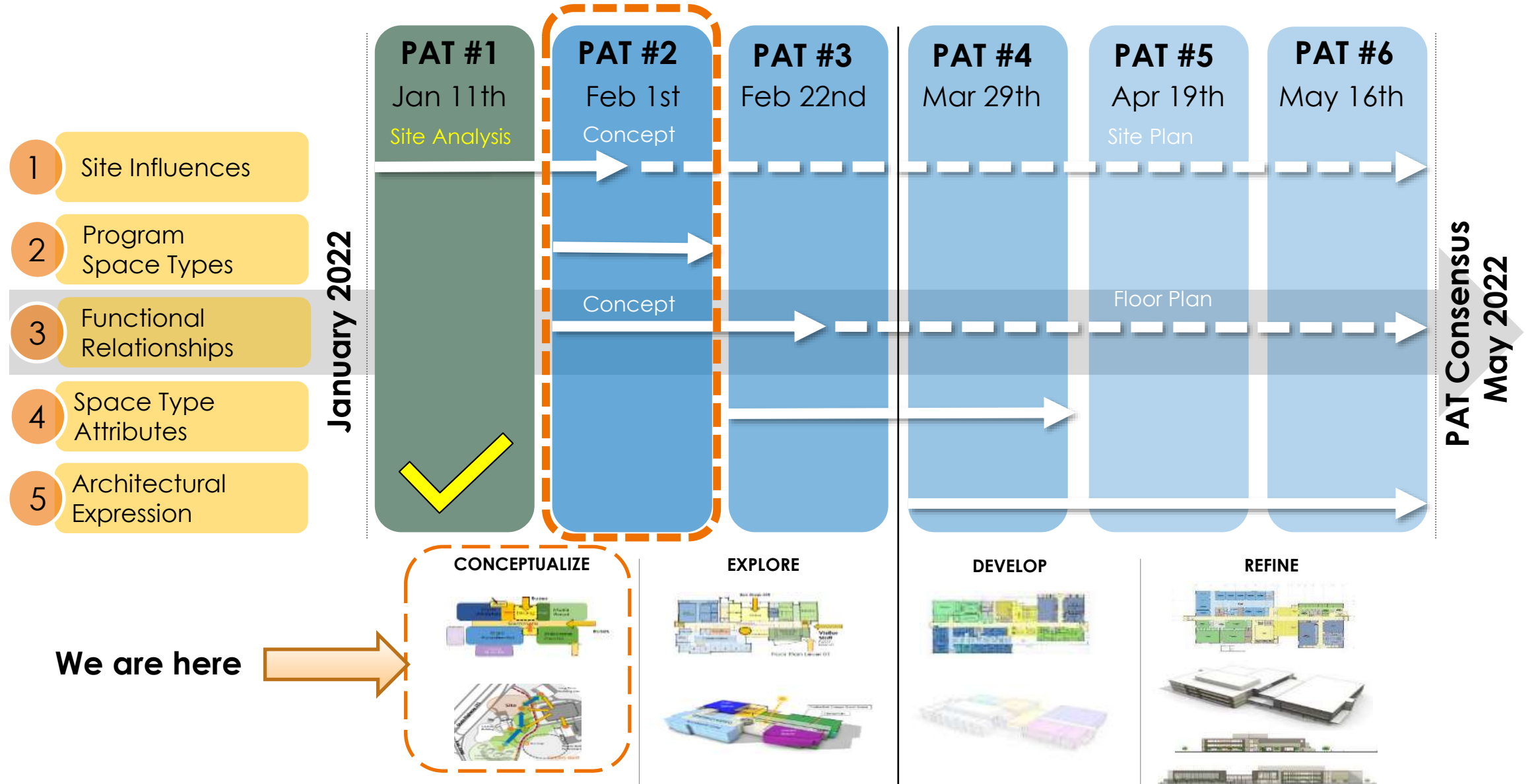

Item 2

PAT MEETING #1 - RECAP PAT Engagement-1 Visioning

The image displays five overlapping forms titled "PAT Mtg #1 - Design Vision Notes" and "PAT Mtg #1 - Educational Vision Notes". Each form contains handwritten notes in various colors (blue, green, red, black) organized into sections: "TOPIC", "NOTES", and "Q/A".

Design Vision Notes (Top Left):

- TOPIC:** Design Vision Notes
- NOTES:**
 - 1. Design Vision Notes: What do we want the school to be? (Community, Family oriented)
 - 2. Describe what you would like to see in the future (Small neighborhood School enriched w/ lots of traditions)
 - 3. Describe what you would like to see in the future (Outdoor spaces to learn, read, play, think, grow, & fun)
- Q/A:**
 - 1. What is your favorite physical aspect of the existing campus? (Innovative, inspiring, but staff & admin - small school population means "everyone knows your name" - build pride in our community & how we support students)
 - 2. What is your least favorite physical aspect of the existing campus? (None)
 - 3. What is your favorite physical aspect of the existing campus? (None)

Design Vision Notes (Top Right):

- TOPIC:** Design Vision Notes
- NOTES:**
 - 1. Cohesive / Collaborative
 - 2. Family-oriented / happy
 - 3. "home-like" / not sterile / warm
- Q/A:**
 - 1. What is your favorite physical aspect of the existing campus? (The outdoor spaces and natural setting that everyone takes happens for all students - possibly due to not having a common hallway/spaces)
 - 2. What is your least favorite physical aspect of the existing campus? (None)
 - 3. What is your favorite physical aspect of the existing campus? (None)

Educational Vision Notes (Bottom Left):

- TOPIC:** Educational Vision Notes
- NOTES:**
 - 1. What do we want the school to be? (Civic MEETING SPACE)
 - 2. Describe what you would like to see in the future (1) ME THE TEACHERS, 2) ME THE PARENTS, 3) ME THE TEACHERS AGAIN)
 - 3. Describe what you would like to see in the future (SAME AS BEFORE BUT BETTER)
- Q/A:**
 - 1. What is your favorite physical aspect of the existing campus? (None)
 - 2. What is your least favorite physical aspect of the existing campus? (None)
 - 3. What is your favorite physical aspect of the existing campus? (None)

Educational Vision Notes (Bottom Right):

- TOPIC:** Educational Vision Notes
- NOTES:**
 - 1. What do we want the school to be? (Outdoor & indoor spaces, playground, garden, community room, etc.)
 - 2. Describe what you would like to see in the future (Spaces that allow kids to learn inside & outside, flexible furniture)
 - 3. Describe what you would like to see in the future (Specialty spaces where -> not still so 24/7 + comfortable for kids, less people stress + more collaborative, happy)
- Q/A:**
 - 1. What is your favorite physical aspect of the existing campus? (None)
 - 2. What is your least favorite physical aspect of the existing campus? (None)
 - 3. What is your favorite physical aspect of the existing campus? (None)



PAT Mtg#1 Engagement-1: Design Vision Responses

PAT
Response

- 1 Share three words which **describe the personality & character** of Memorial Drive Elementary.

Traditional, Inviting, Feels like a home
Small, Friendly, Rural
Community

- 2 Describe what makes Memorial Drive Elementary uniquely Memorial Drive?

Small neighborhood school; Everyone knows one another; Connectedness
We are a family committed to one another; Kids are every teacher's kids
Social hub for students and parents; Destination for social interaction
Mixed grade level collaboration

- 3 What is your MOST favorite physical aspect of the existing campus you would like to preserve?

Trees; Open spaces; Outdoor classrooms; Green space
Light from outside
Front porch



PAT Mtg#1 Engagement-1: Educational Vision Responses

PAT
Response

- 1 Describe how the **building can help support** both, **Student engagement + Community** activities.

Library as the heart of the school
Learning on display
Spaces for the community
Welcoming
Access to outdoor learning

- 2 Name **three things** that **help create a modern 21st Century Teaching & Learning** environment that helps to support and foster a successful program.

Movable furniture
Spaces for kids to be kids
Shared collaborative spaces

- 3 Describe **your vision** for the new Memorial Drive Elementary.

Combination of new and old; The same, but better
Traditional, timeless; Make it feel like forever
Understated with the newest technology



PAT Mtg#2 Engagement: Vision Responses into Guiding Principles

PAT Mtg#1 Engagement-1: Design Vision Responses PAT Response

1. Share three words which describe the personality & character of Memorial Drive Elementary.
Traditional, Inviting, Feels like a home
Small, Friendly, Rural
Community

2. Describe what makes Memorial Drive Elementary uniquely Memorial Drive?
Small neighborhood school; Everyone knows one another; Connectedness
We are a family committed to one another; Kids are every teacher's kids
Social hub for students and parents; a destination for social interaction
Mixed grade level collaboration

3. What is your MOST favorite physical aspect of the existing campus you would like to preserve?
Trees; Open spaces; Outdoor classrooms; Green space
Light from outside
Front porch

PAT Mtg#1 Engagement-1: Educational Vision Responses PAT Response

1. Describe how the building can help support both: Student engagement + Community activities.
Library as the heart of the school
Learning on display
Spaces for the community
Welcoming
Access to outdoor learning

2. Name three things that help create a modern 21st Century Teaching & Learning environment that helps to support and foster a successful program.
Movable furniture
Spaces for kids to be kids
Shared collaborative spaces

3. Describe your vision for the new Memorial Drive Elementary.
Combination of new and old; The same, but better
Traditional, timeless; Make it feel like forever
Understated with the newest technology

PAT Input

MDE DESIGN GUIDING PRINCIPLES



PAT Mtg#2 Engagement: PAT INPUT on Guiding Principles

MDE DESIGN - GUIDING PRINCIPLES

Preserve the Intimate Wooded Setting

Maintain the legacy trees and the small neighborhood school character.

Celebrate our Community

Connect the community during school and after.

Encourage Our Commitment to One Another

Support and promote a caring close-knit family environment that encourages parent and community involvement.

Perpetuate Our Traditions

Keep the qualities of tradition, community and family in the new design with 21st century teaching and learning spaces.

Demonstrate Our Values

Focus on building student character and promoting the development of the individual as a future citizen.

Item 3

PAT MEETING #1 - RECAP
PAT Engagement-2
Site Organization Elements



Site Analysis – Site Constraints

In PAT Meeting #1 - We Reviewed Current Site Constraints:

1. City Required Setbacks
2. Perimeter Fencing + Legacy Tree Locations
3. Traffic Patterns including Drop Off / Pick Up Location + Parking Locations

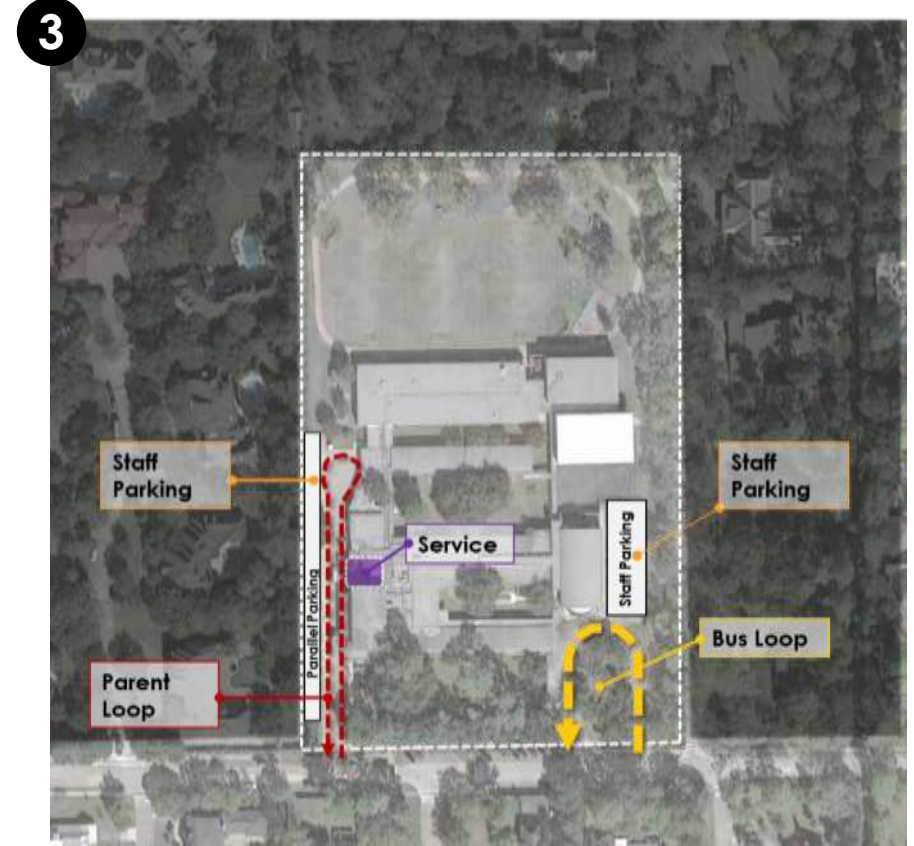



Site Analysis – Site Characteristics

In PAT Meeting #1 - We Reviewed Characteristics of the Site:

These characteristics create the unique DNA of Memorial Drive ES



Characteristics of the site

1. Legacy Trees
2. Canopy of live Oaks
3. Clearing in the Pines
4. West edge of Campus
5. East edge of campus
6. School Identity
7. Play Fields
8. Building Services
9. On site Parking
10. Community Plaza





Community Plaza – Culture of community engagement + Park like quality



In PAT Meeting #1 - We asked the PAT to evaluate 3 Site Organization Options

Each Table evaluated /ranked options and reported out their TOP #1 Choice describing why



**Building at
Front of Site**



**Building at
Back of Site**



**Building at
Side of Site**



PAT Engagement

Validation of Design Direction

Site Organization Design Options:

- A. Building at Front
- B. Building at Back
- C. Building at Side

At your Table:

- Review Options
- Discuss Pros
- Discuss Cons
- Reach Consensus

Rank the Design Options below each image:

- # 1. First Choice
2. Second Choice
3. Third Choice

Provide a brief explanation for each of your choices

A

Building at Front

1

UNANIMOUS Top Choice

- Same But New
- Playground in backyard / secure
- Trees Saved!
- Parking Hidden
- Front Porch "hangout" preserved

B

Building at Back

3

Last Choice

- Building in strange location
- Don't like Play Fields in front
- Front Porch "hang out" too far into site

C

Building at Side

2

Second Choice

- Parking too visible
- Building too close to homes
- Like Play Field pushed back
- Takes away neighborhood ambiance

PAT Response

Item

4

**PAT MEETING #2
ENGAGEMENT**
Building Anchors

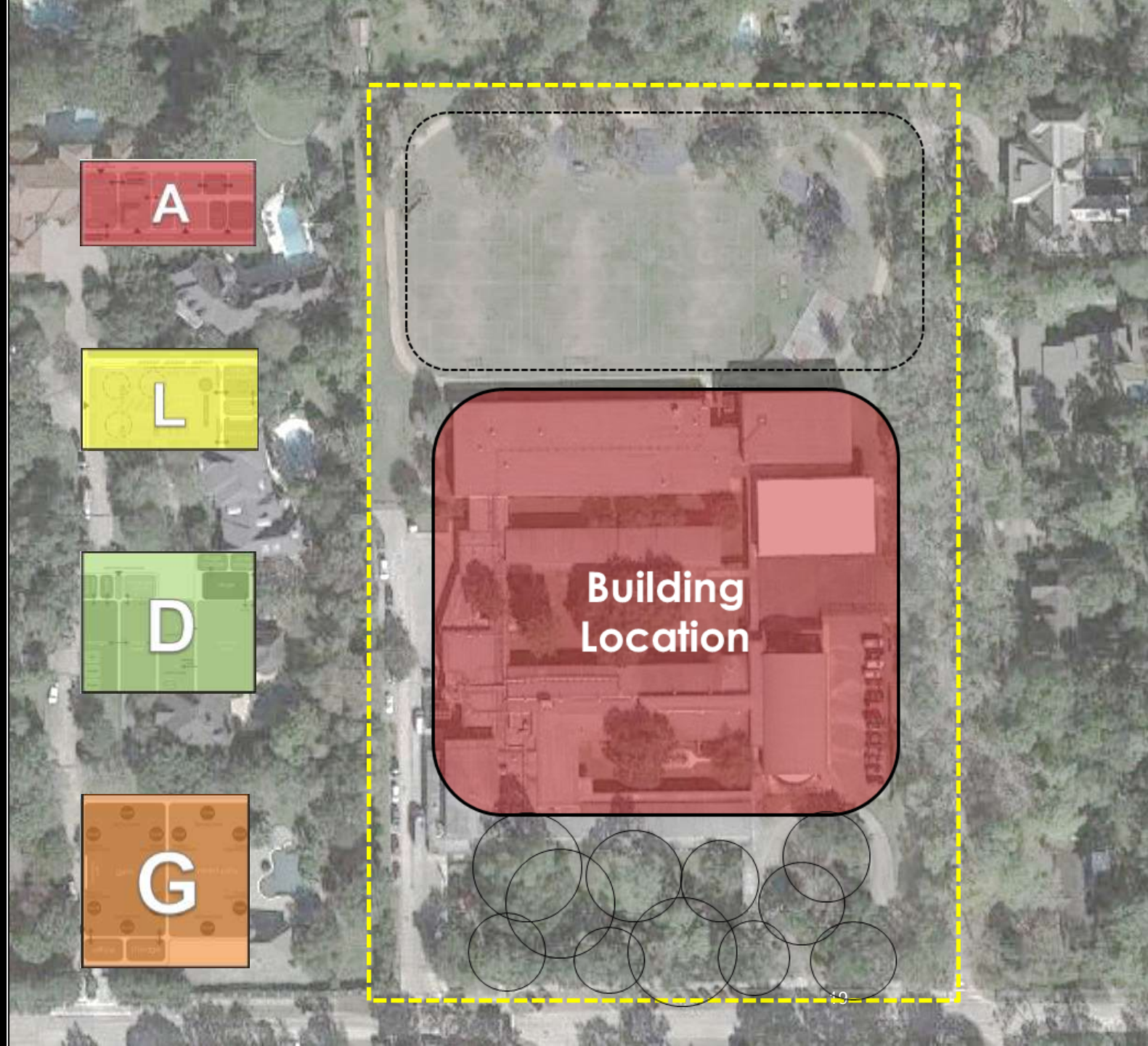



PAT Mtg#2 Engagement: Preparation

In preparation for the PAT Mtg#2 Engagement Activity:

We will share with you some **KEY INGREDIENTS** regarding the building function and site constraints you should keep in mind as you complete the activity.

1. BUILDING FUNCTION

What is happening **Inside the building** that will influence the placement of the building anchors.

2. SITE CONSTRAINTS

What site constraints exists **Outside the building** that will influence the placement of the building anchors.





PAT Mtg#2 Engagement: Preparation – Building Functions

In preparation for the PAT Mtg#2 Engagement Activity:

We will share with you some **KEY INGREDIENTS** regarding the building function and site constraints you should keep in mind as you complete the activity.

1. BUILDING FUNCTION

What is happening **Inside the building** that will influence the placement of the building anchors.





PAT Mtg#2 Engagement: Preparation – Building Function

The following 4 Building Anchors will shape the design of the New Memorial Drive ES
The SBISD Educational Specifications describe key attributes and traits for each building anchor.

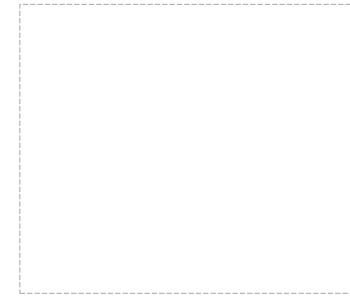
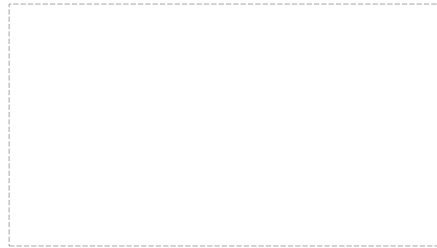

ADMINISTRATION:

- Main Entry for Visitors
- Front Office / Clinic
- Typical location for Parent Drop-off / Pick-up



PAT Mtg#2 Engagement: Preparation – Building Function

The following 4 Building Anchors will shape the design of the New Memorial Drive ES
The SBISD Educational Specifications describe key attributes and traits for each building anchor.



ADMINISTRATION:

- Main Entry for Visitors
- Front Office / Clinic
- Typical location for Parent Drop-off / Pick-up



LIBRARY / MEDIA CENTER:

- Centrally located within Learning Communities
- Connection to Outdoors
- Community Access

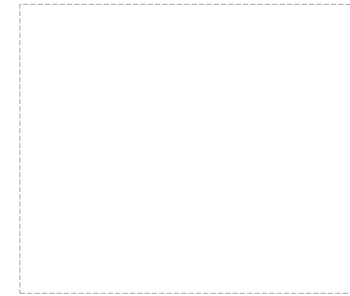



PAT Mtg#2 Engagement: Preparation – Building Function

The following 4 Building Anchors will shape the design of the New Memorial Drive ES
The SBISD Educational Specifications describe key attributes and traits for each building anchor.

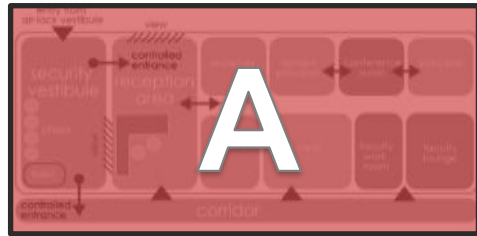

ADMINISTRATION:

- Main Entry for Visitors
- Front Office / Clinic
- Typical location for Parent Drop-off / Pick-up



LIBRARY / MEDIA CENTER:

- Centrally located within Learning Communities
- Connection to Outdoors
- Community Access

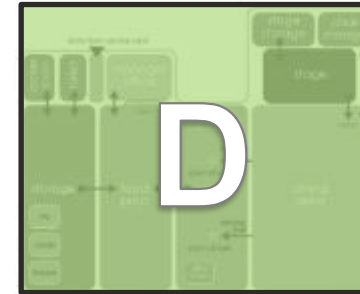

DINING COMMONS:

- Service Access
- Staging area for Drop-off / Pick-up
- Community Access





PAT Mtg#2 Engagement: Preparation – Building Function

The following 4 Building Anchors will shape the design of the New Memorial Drive ES
The SBISD Educational Specifications describe key attributes and traits for each building anchor.



ADMINISTRATION:

- Main Entry for Visitors
- Front Office / Clinic
- Typical location for Parent Drop-off / Pick-up



LIBRARY / MEDIA CENTER:

- Centrally located within Learning Communities
- Connection to Outdoors
- Community Access

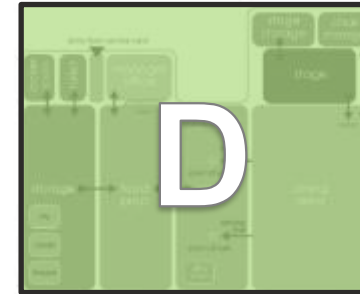

DINING COMMONS:

- Service Access
- Staging area for Drop-off / Pick-up
- Community Access



GYMNASIUM

- PE Play Space
- Access to Covered Play & Play Fields
- Community Access



PAT Mtg#2 Engagement: Preparation – Site Constraints

In preparation for the PAT Mtg#2 Engagement Activity:

We will share with you some **KEY INGREDIENTS** regarding the building function and site constraints you should keep in mind as you complete the activity.

1. BUILDING FUNCTION

What is happening Inside the building that will influence the placement of the building anchors.

2. SITE CONSTRAINTS

What site constraints exists Outside the building that will influence the placement of the building anchors.

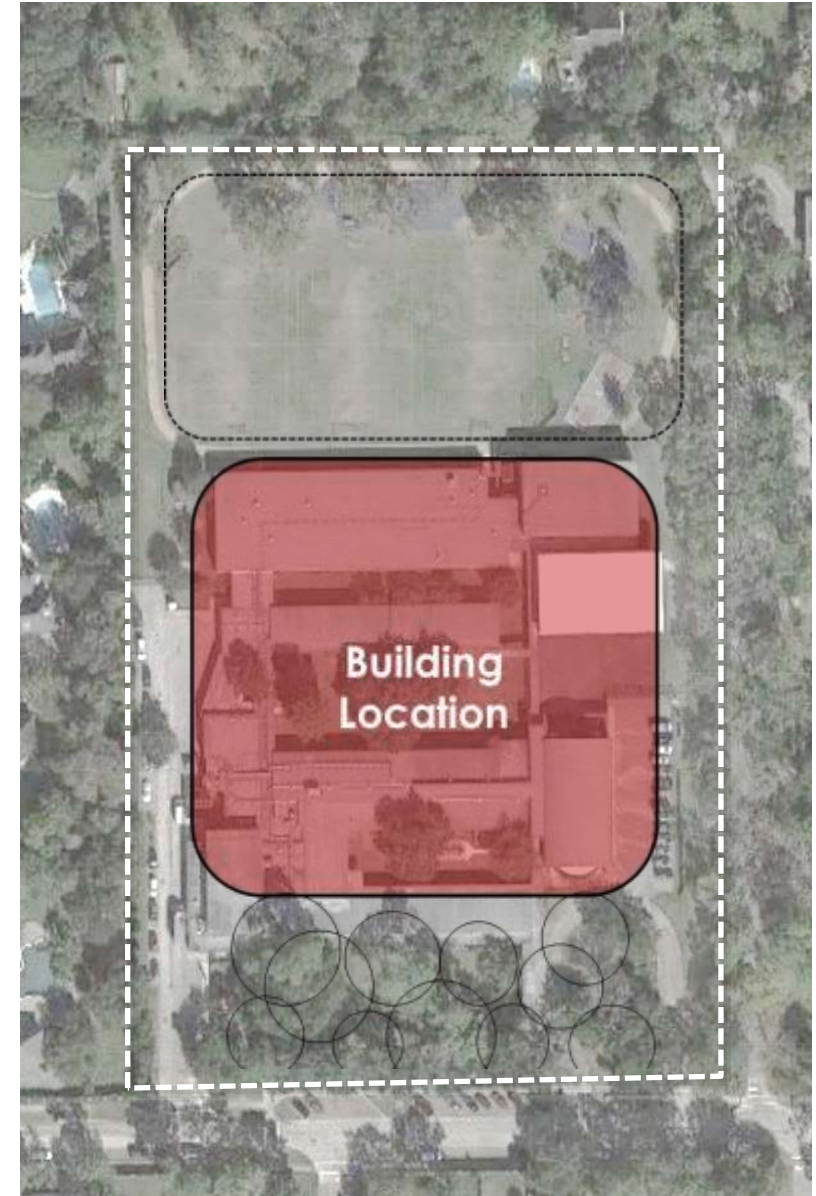

PAT Mtg#1 - “CONSENSUS”



PAT Mtg#2 Engagement: Preparation – Site Constraints

MEMORIAL DRIVE ELEMENTARY SCHOOL

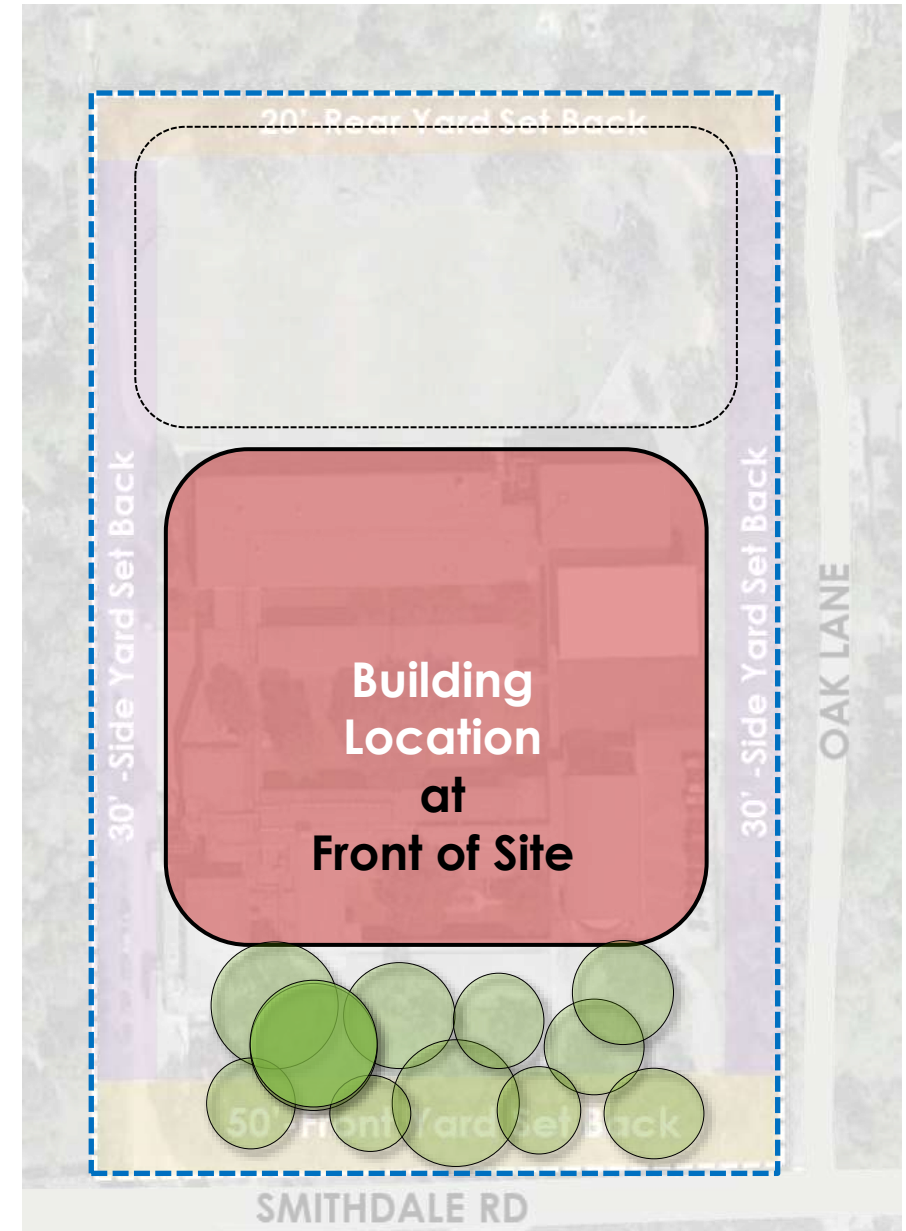
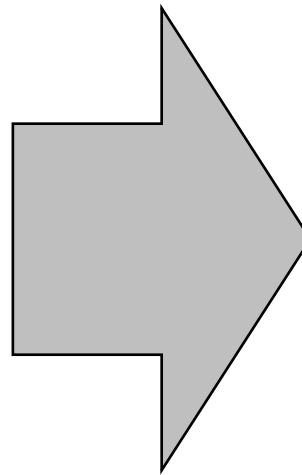
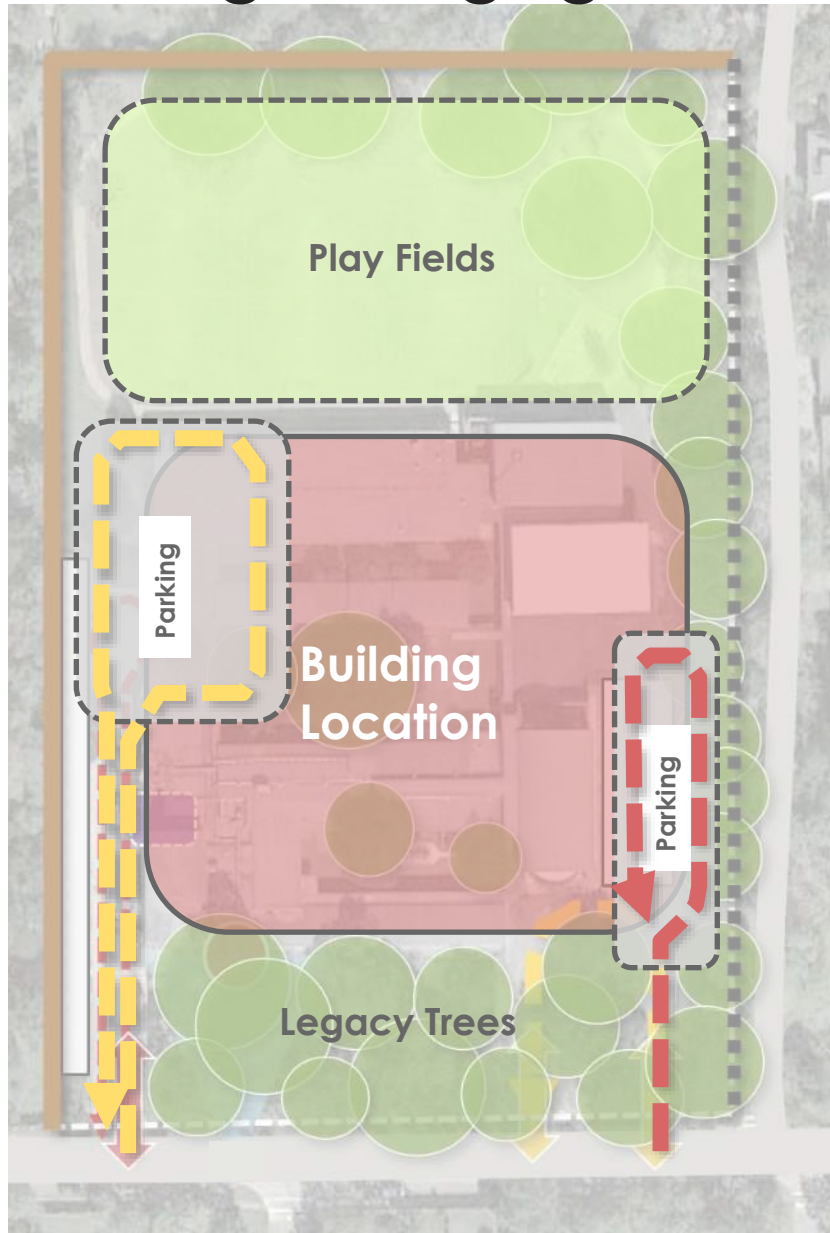

PAT Mtg#1 - "CONSENSUS"



PAT Mtg#2 Engagement: Preparation – Site Constraints

MEMORIAL DRIVE ELEMENTARY SCHOOL

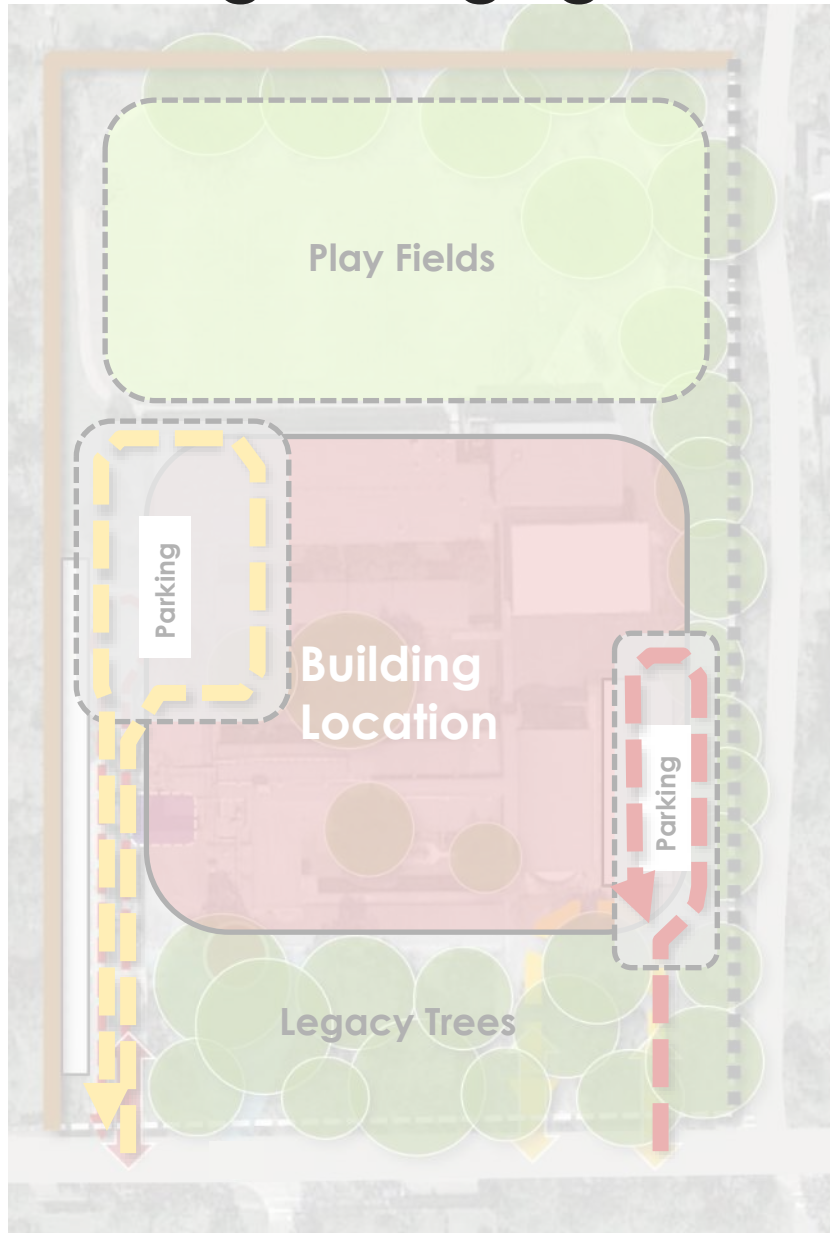

PAT Mtg#1 - "CONSENSUS"

Legacy
Trees

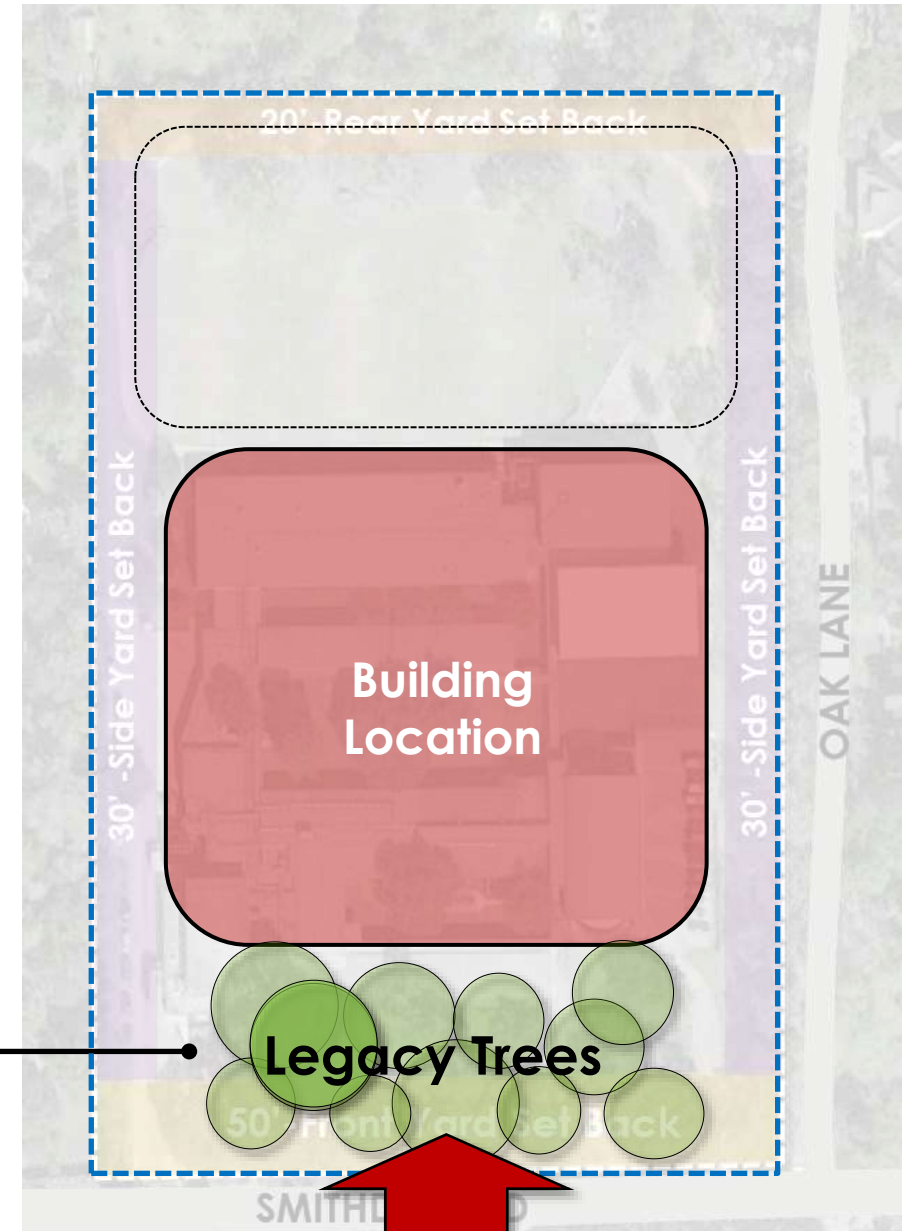

Legacy
Trees

MDE Identity



PAT Mtg#2 Engagement: Preparation – Site Constraints

MEMORIAL DRIVE ELEMENTARY SCHOOL

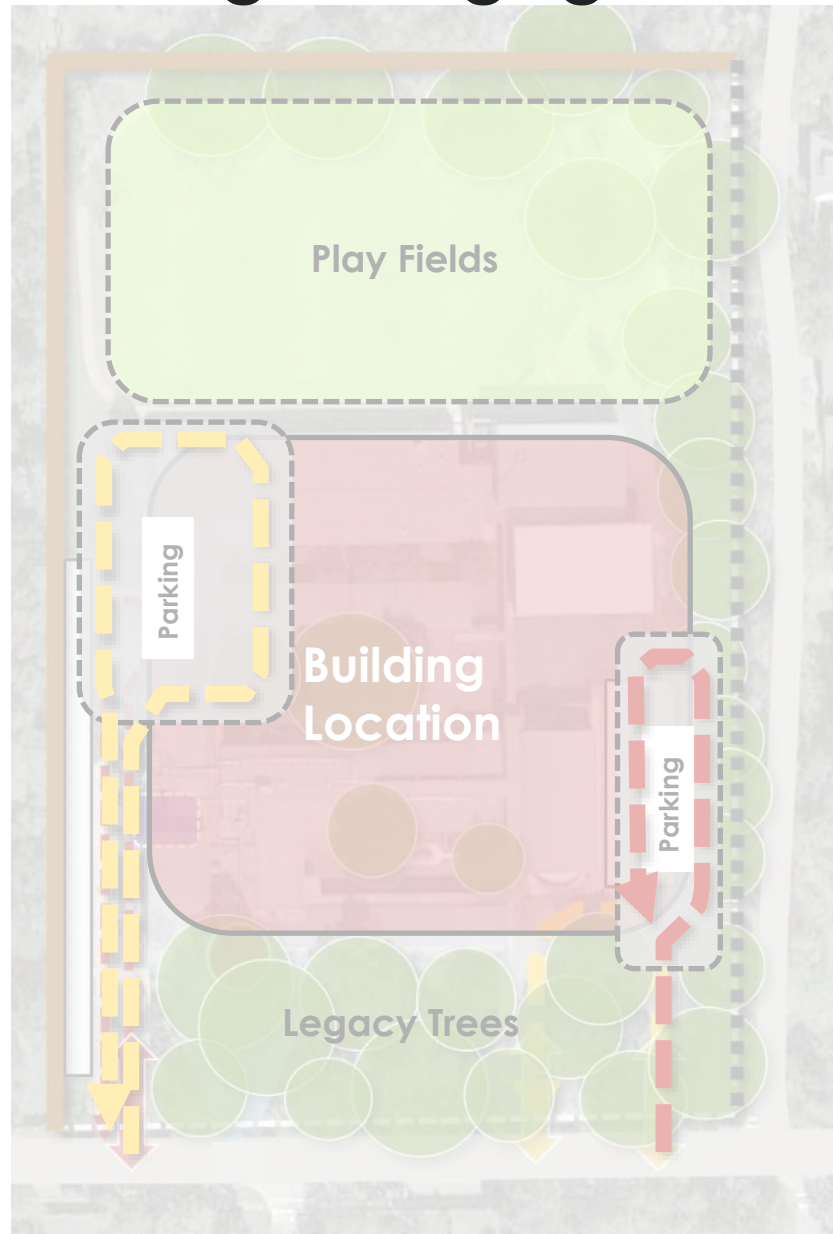

PAT Mtg#1 - "CONSENSUS"

Play
Fields

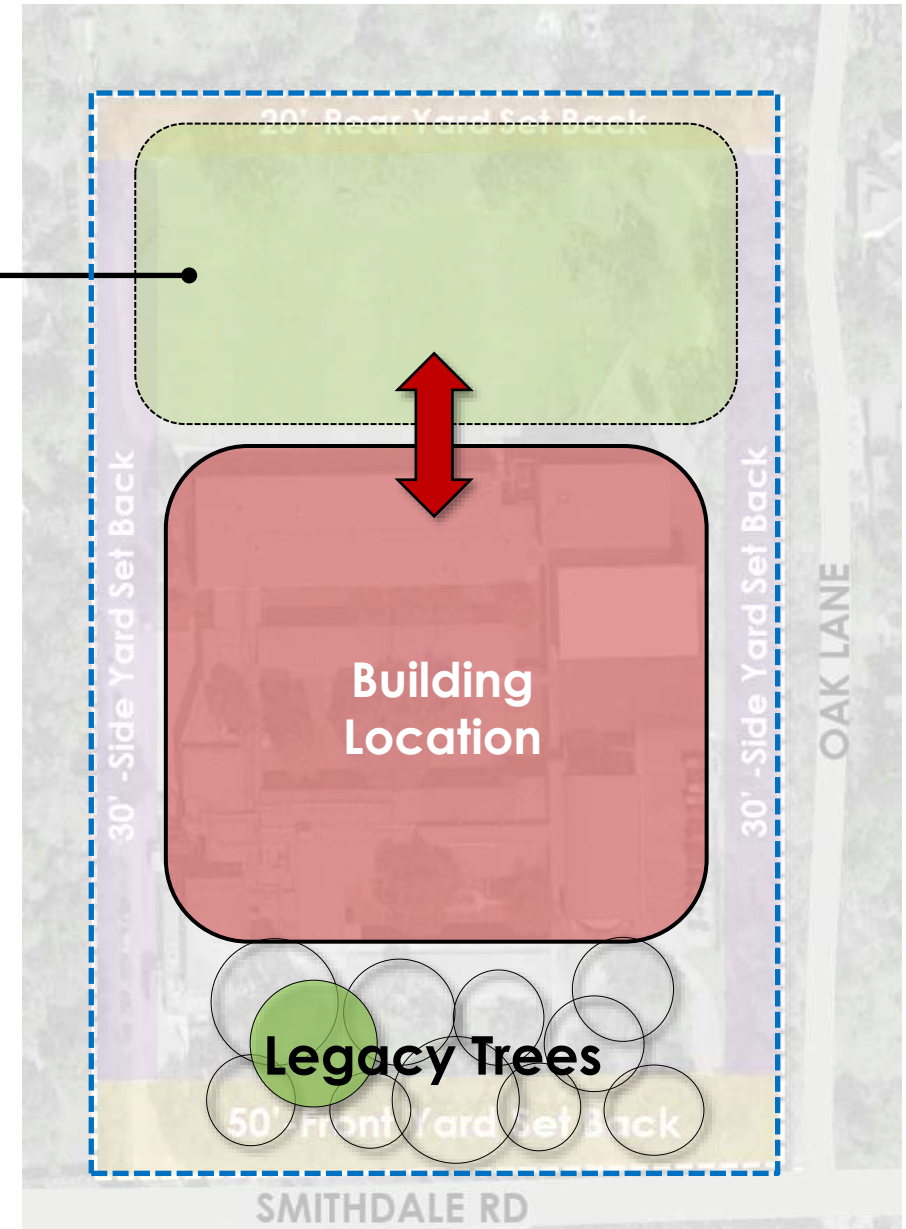



PAT Mtg#2 Engagement: Preparation – Site Constraints

MEMORIAL DRIVE ELEMENTARY SCHOOL



PAT Mtg#1 - "CONSENSUS"

Parking

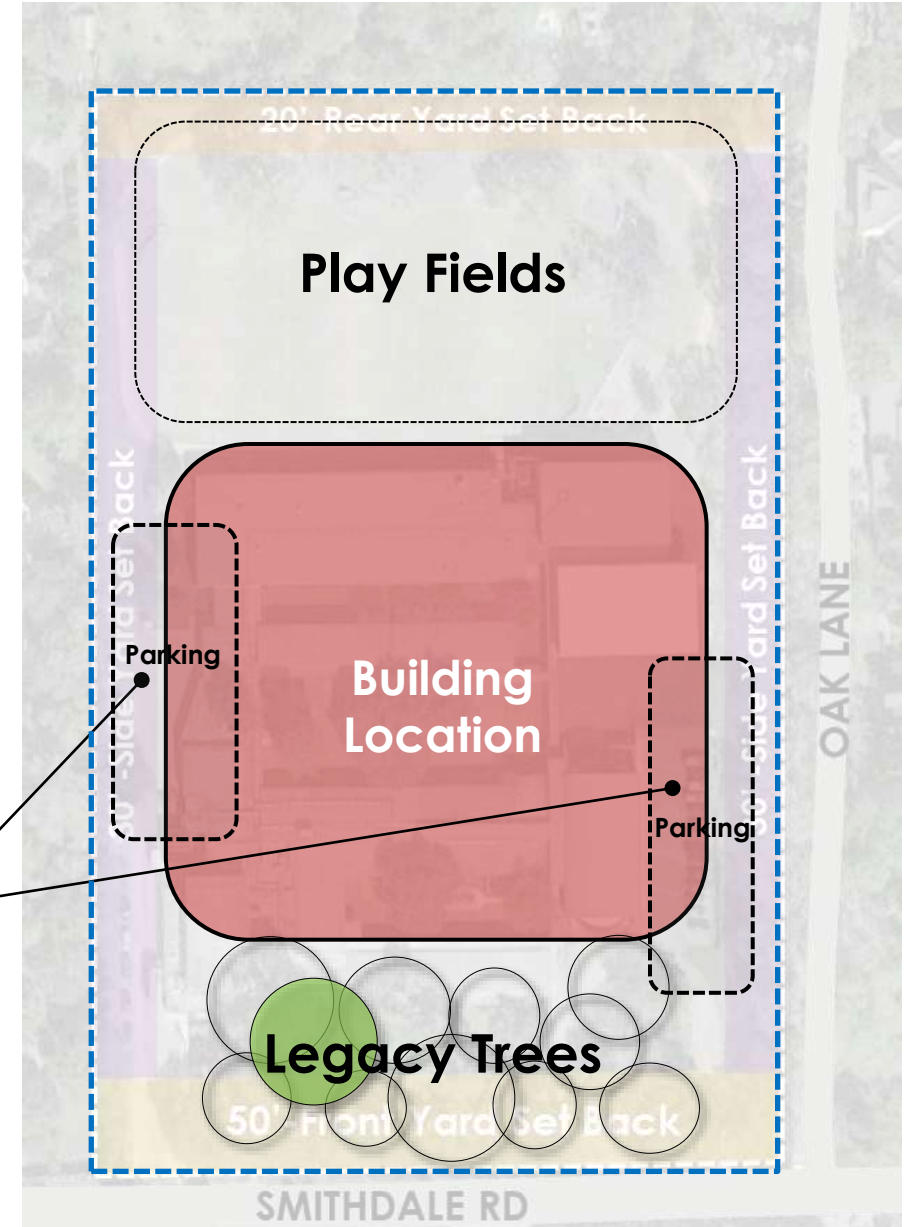



PAT Mtg#2 Engagement: Preparation – Site Constraints

MEMORIAL DRIVE ELEMENTARY SCHOOL



PAT Mtg#1 - "CONSENSUS"

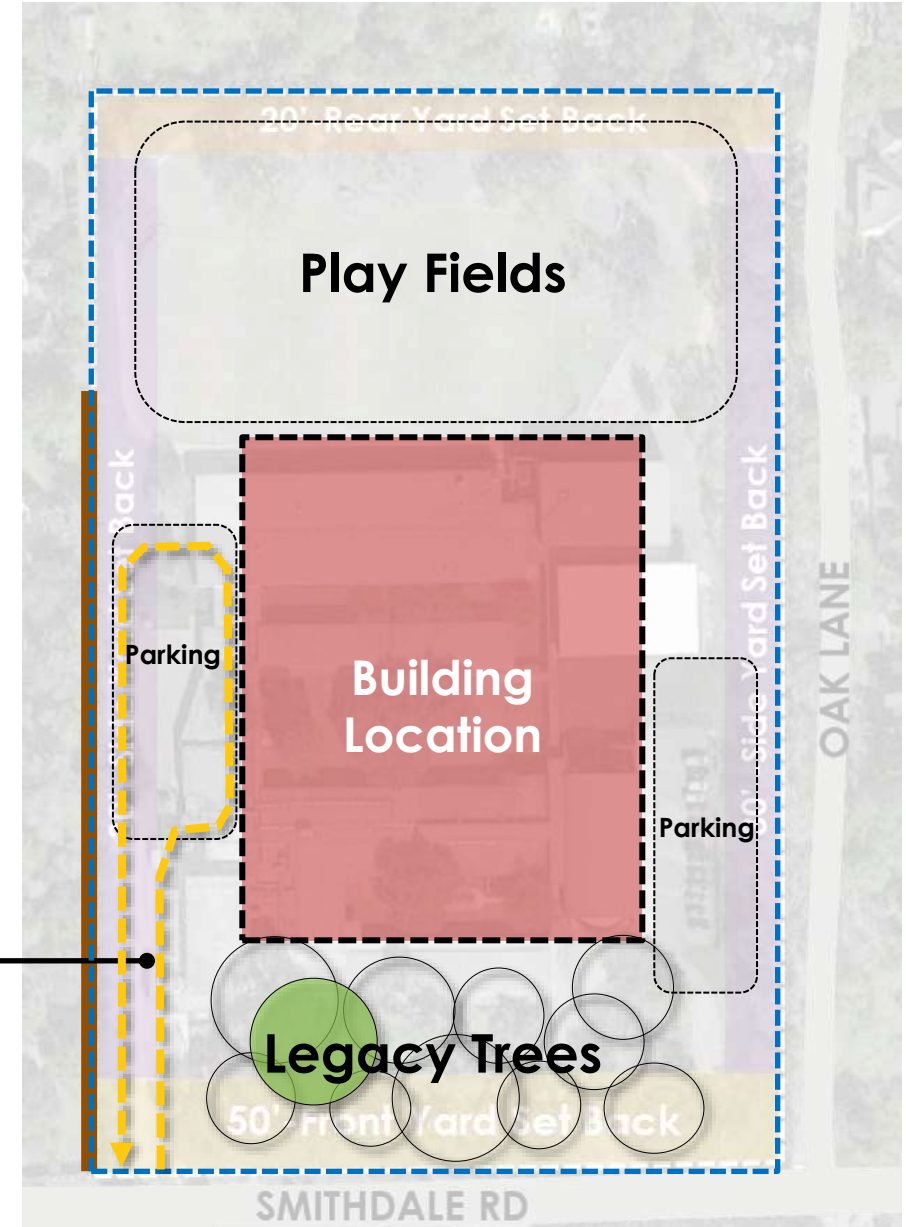



PAT Mtg#2 Engagement: Preparation – Site Constraints

MEMORIAL DRIVE ELEMENTARY SCHOOL



PAT Mtg#1 - "CONSENSUS"

Parent Drop-off
Visitor Parking

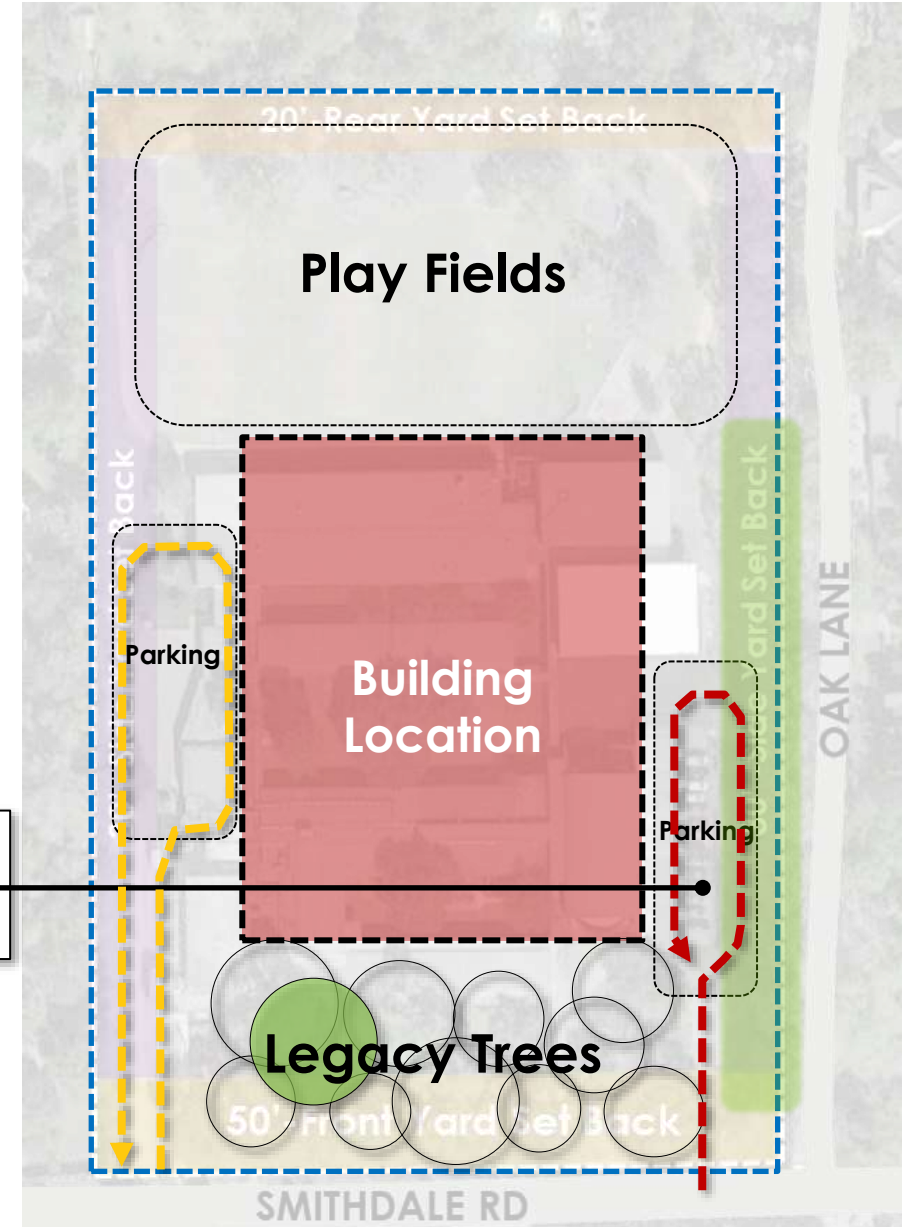



PAT Mtg#2 Engagement: Preparation – Site Constraints

MEMORIAL DRIVE ELEMENTARY SCHOOL



PAT Mtg#1 - "CONSENSUS"

Front Porch
"Social
Connector"

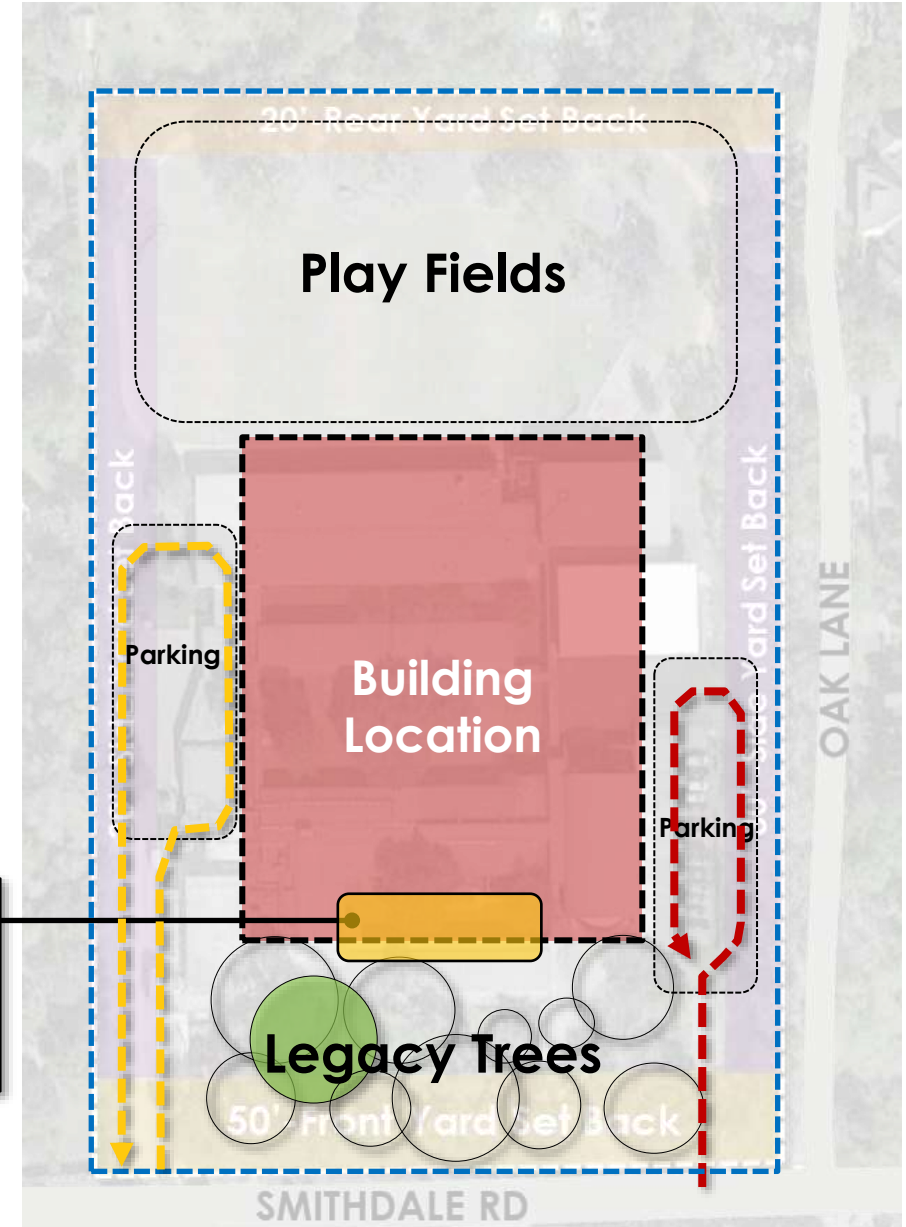



PAT Mtg#2 Engagement: Preparation – Site Constraints

MEMORIAL DRIVE ELEMENTARY SCHOOL

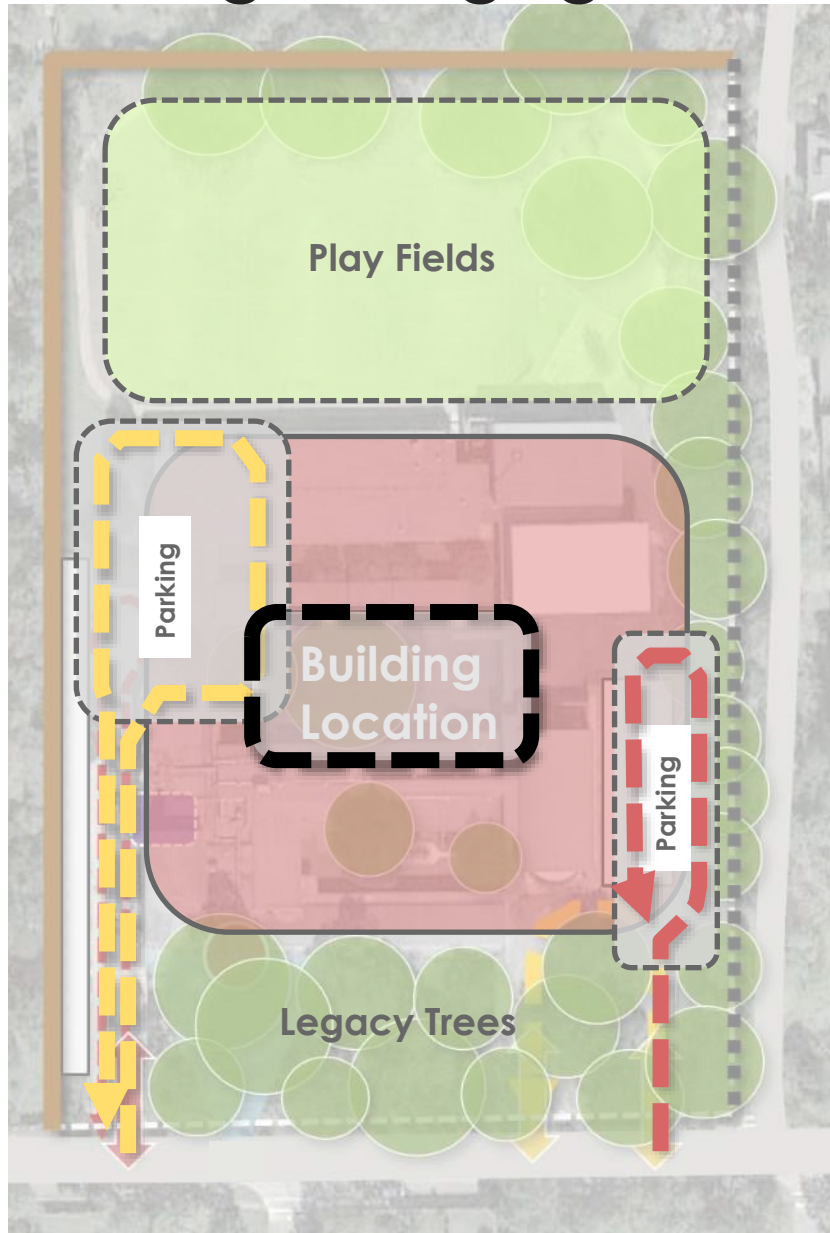

PAT Mtg#1 - "CONSENSUS"

Court-Yard
Outdoor Learning

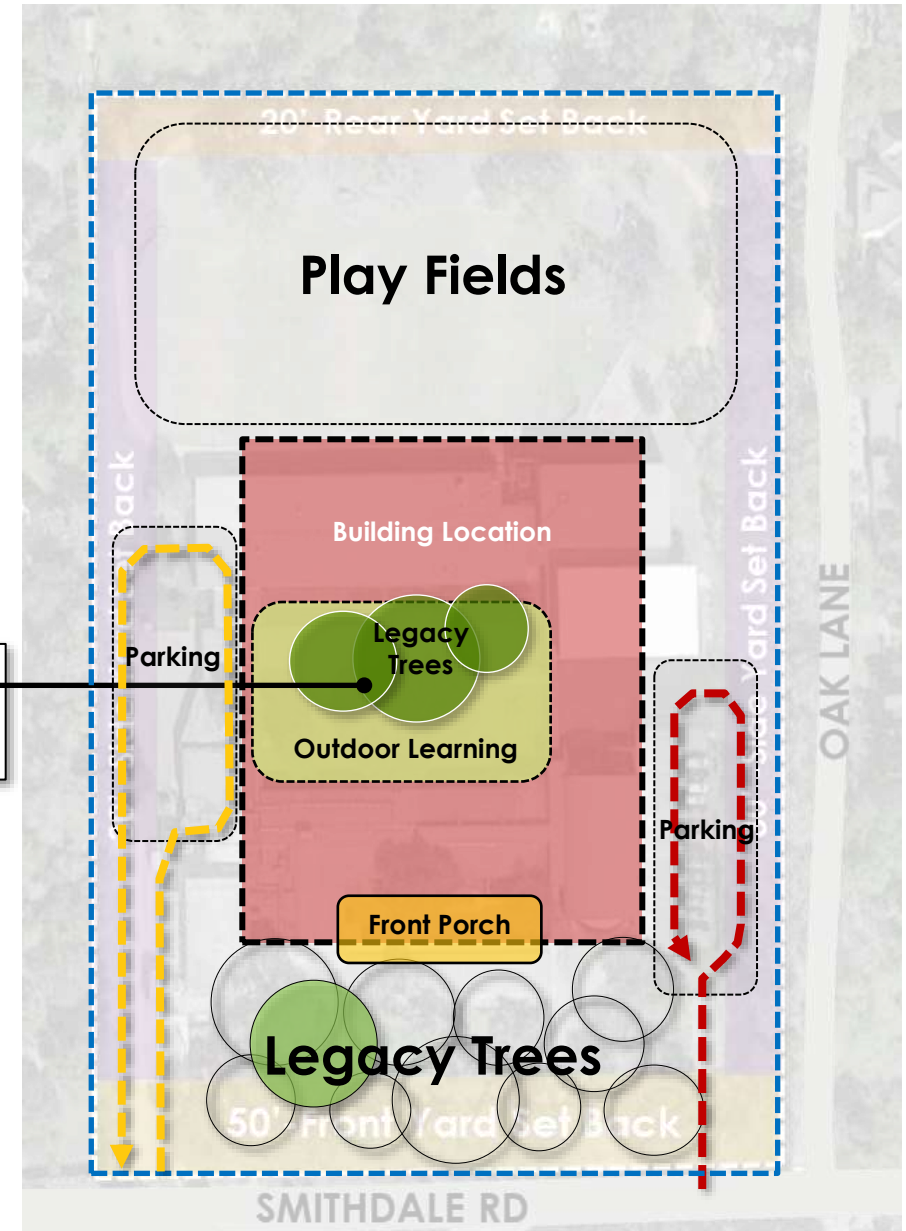



PAT Mtg#2 Engagement: Preparation – Site Constraints

MEMORIAL DRIVE ELEMENTARY SCHOOL

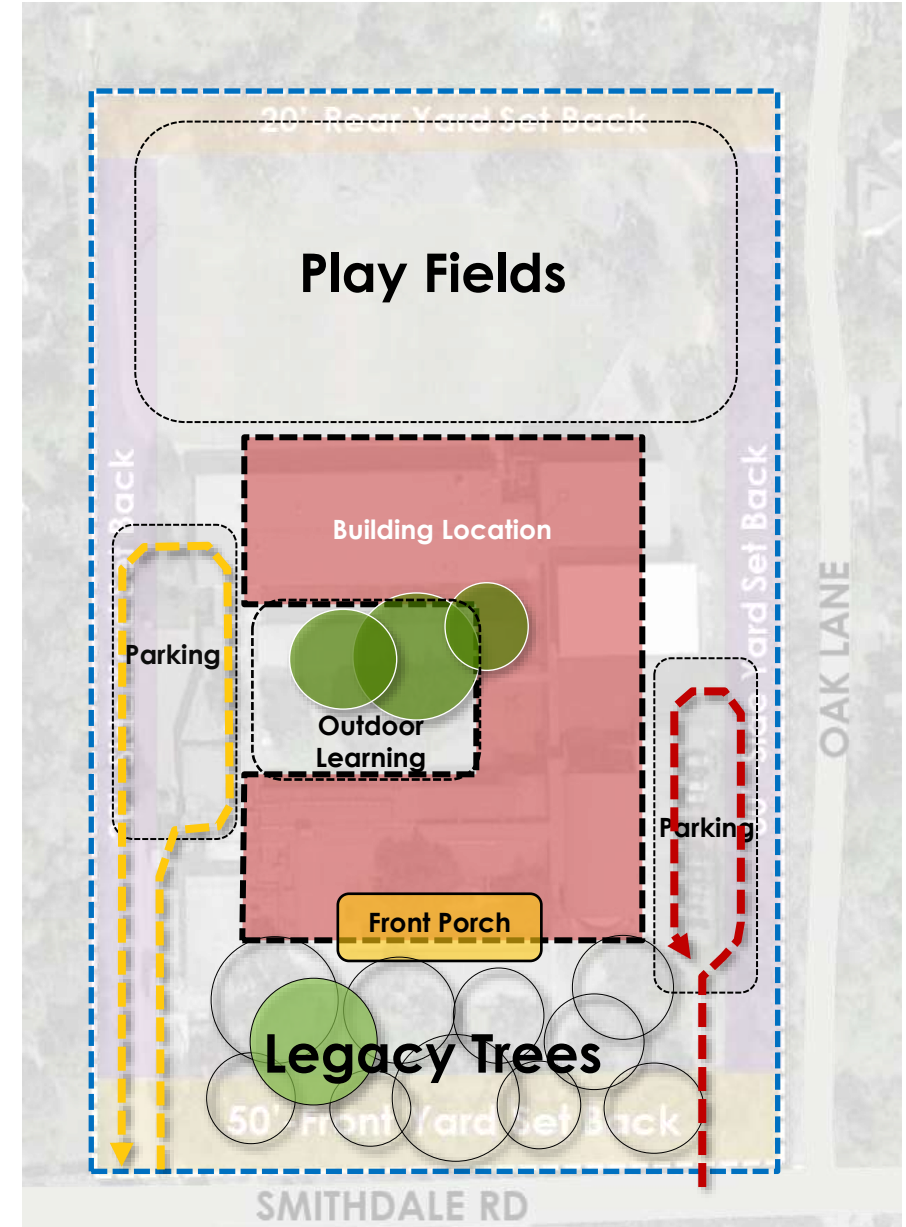

PAT Mtg#1 - "CONSENSUS"



PAT Mtg#2 Engagement: Preparation – Site Constraints

MEMORIAL DRIVE ELEMENTARY SCHOOL



PAT Mtg#1 - "CONSENSUS"

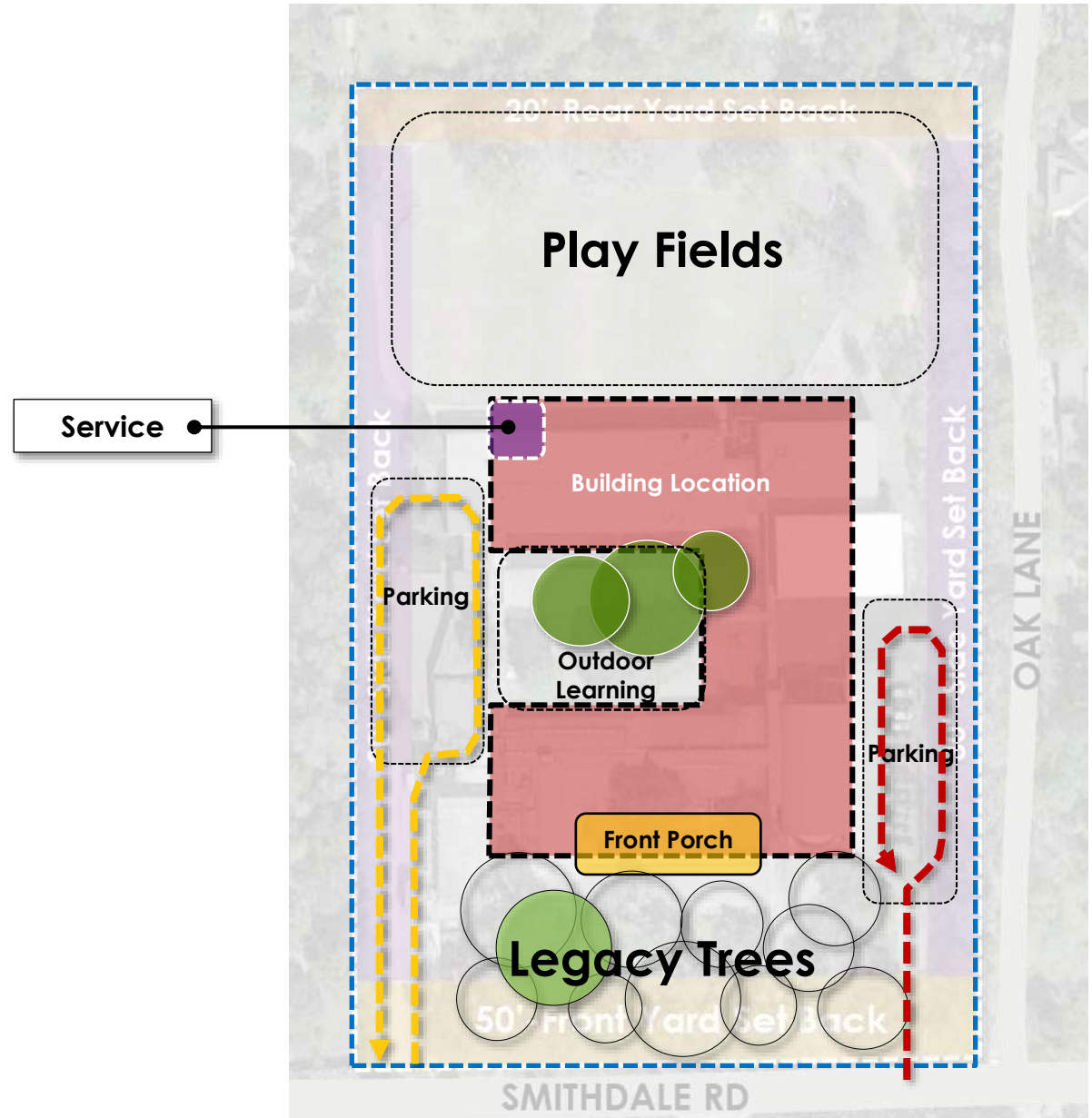



PAT Mtg#2 Engagement: Preparation – Site Constraints

MEMORIAL DRIVE ELEMENTARY SCHOOL

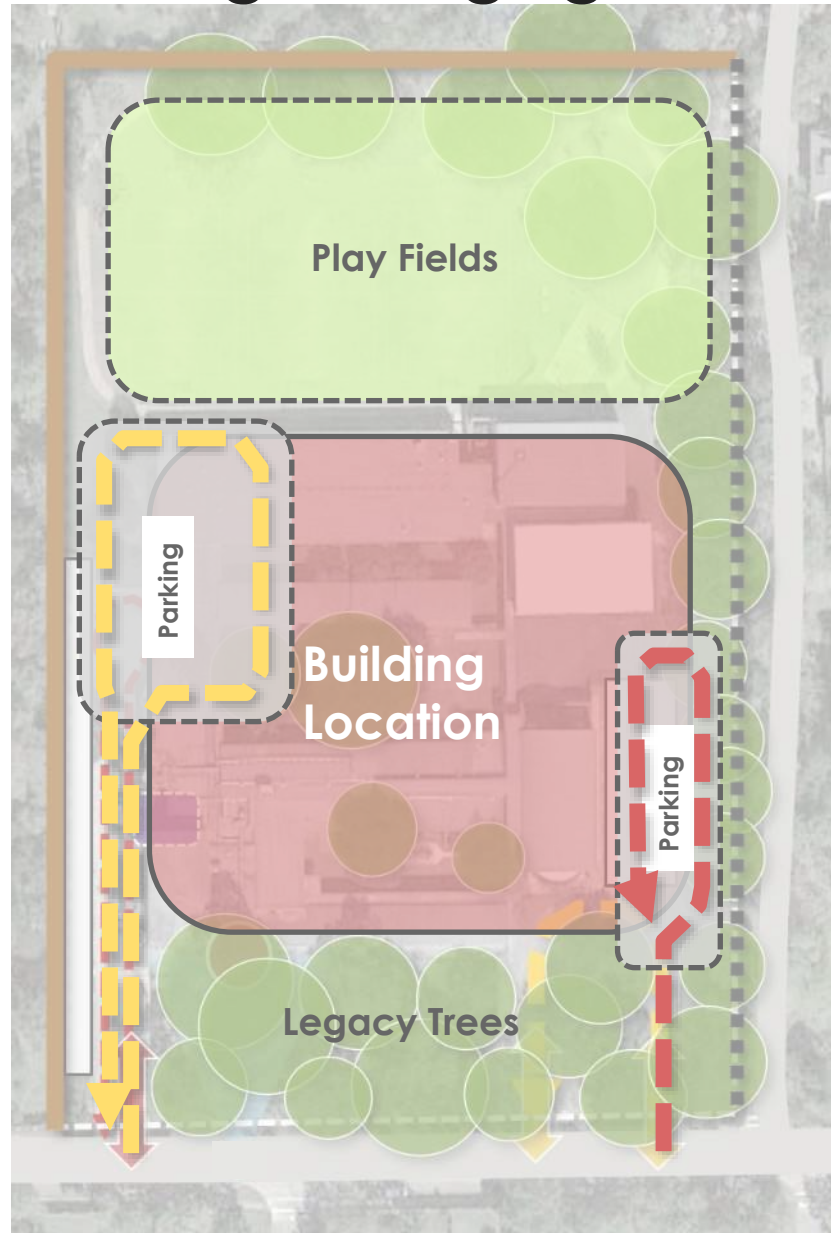

PAT Mtg#1 - "CONSENSUS"

Evaluate
Existing Buildings

Gym + Library
Renovate
or Repurpose

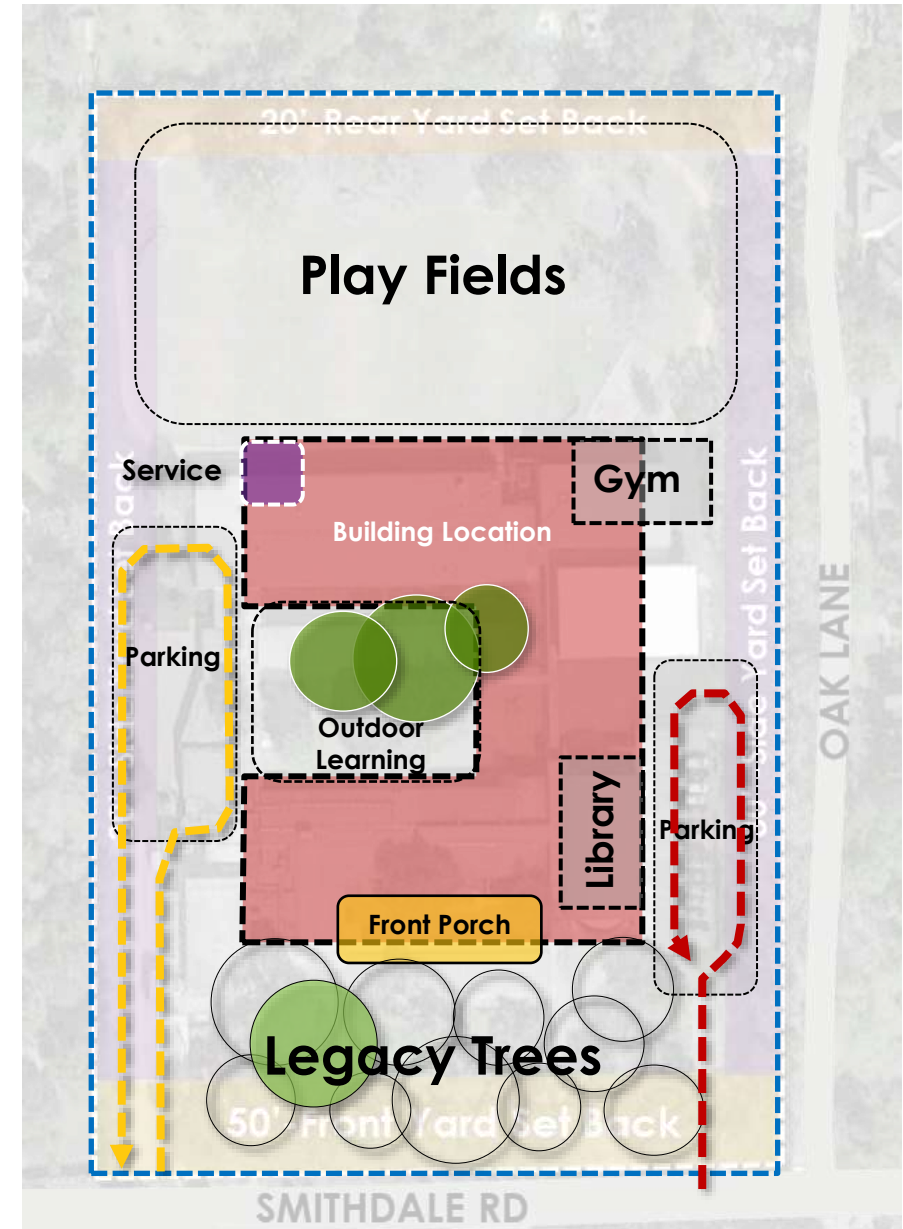



PAT Mtg#2 Engagement: Building Anchors Exercise

PAT Activity



35 mins for Engagement Activity:

10 minutes of Group/Table work

25 minutes of Reporting out (5 mins /per table)

At your Table:

- Discuss Building Functions
- Discuss Site Constraints
- Place the 4 Building Anchors
- Reach Consensus
- **Be Ready to Report Out Your Solution**

“Anchors” for Site / Building Design

1. Administration

- Main Entry
- Front Office / Clinic
- Drop Off/Pick Up Staging

2. Library / Media Center

- Central to Learning Communities
- Connection to Outdoors
- Community Access

3. Dining Commons

- Service Access
- Drop Off/Pick Up Staging
- Community Access

4. Activity Gym

- PE Space
- Covered Play + Play Fields
- Community Access

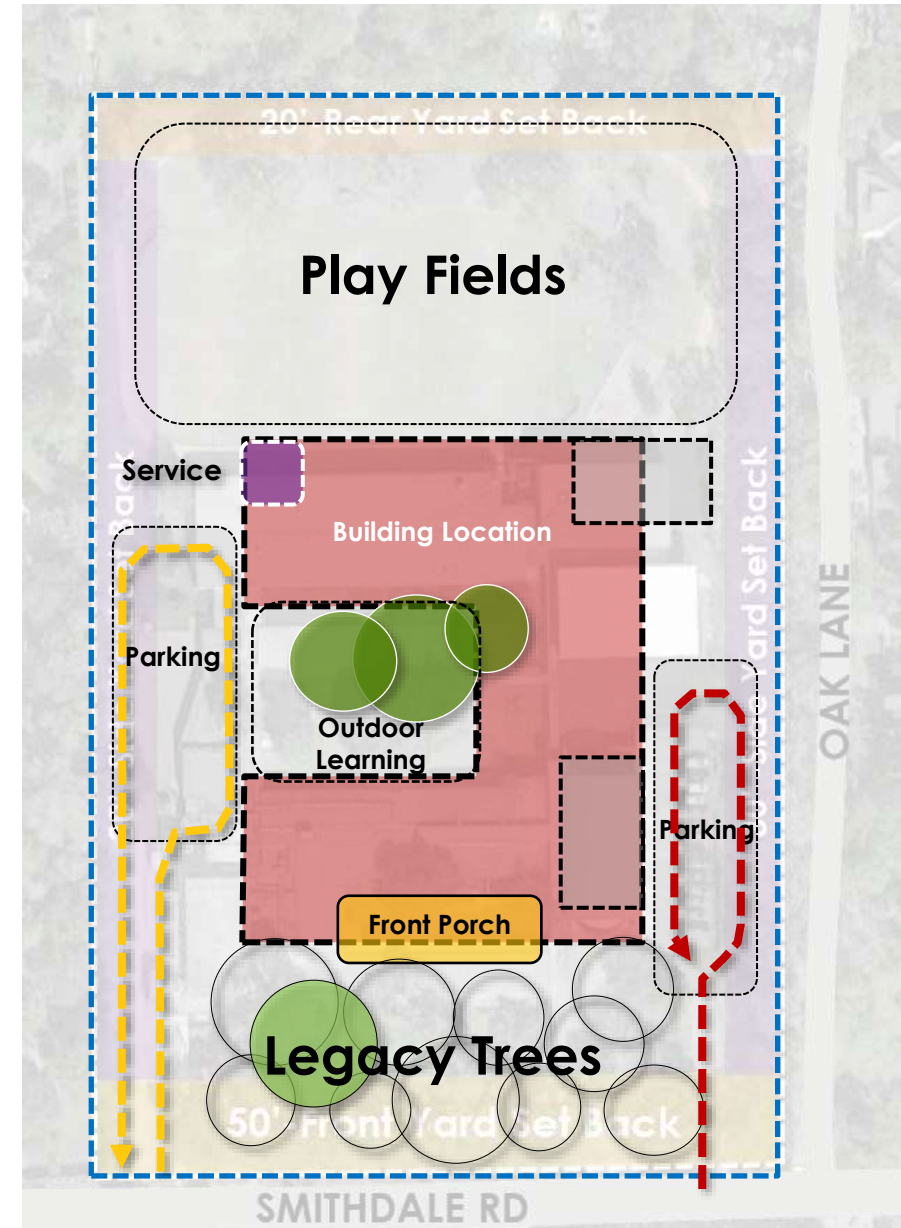



35 mins for Engagement Activity:

10 minutes of Group/Table work

25 minutes of Reporting out (5 mins /per table)

Each Table:

- *Report Out Your Solution*
- *Does it meet Guiding Principles?*

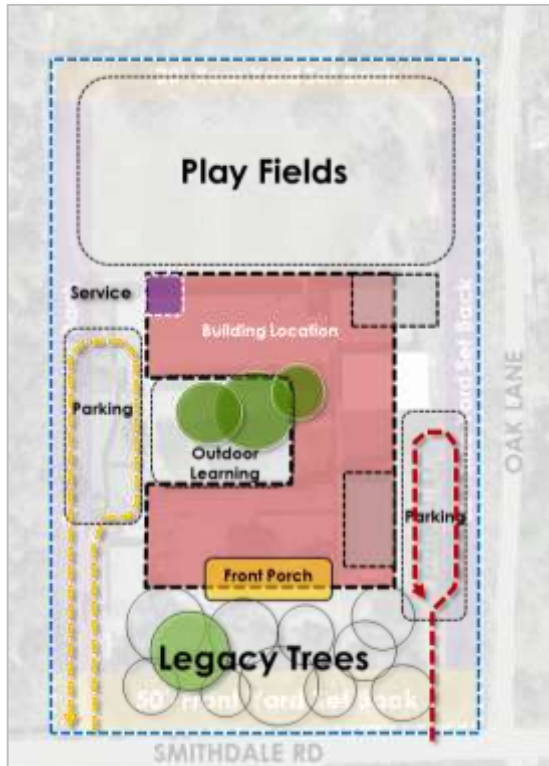

MDE DESIGN - GUIDING PRINCIPLES

Preserve the Intimate Wooded Setting

Maintain the legacy trees and the small neighborhood school character.

Celebrate our Community

Connect the community during school and after.

Encourage Our Commitment to One Another

Support and promote a caring close-knit family environment that encourages parent and community involvement.

Perpetuate Our Traditions

Keep the qualities of tradition, community and family in the new design with 21st century teaching and learning spaces.

Demonstrate Our Values

Focus on building student character and promoting the development of the individual as a future citizen.



Item 5

NEXT STEPS





Next Steps – PAT Engagement Process

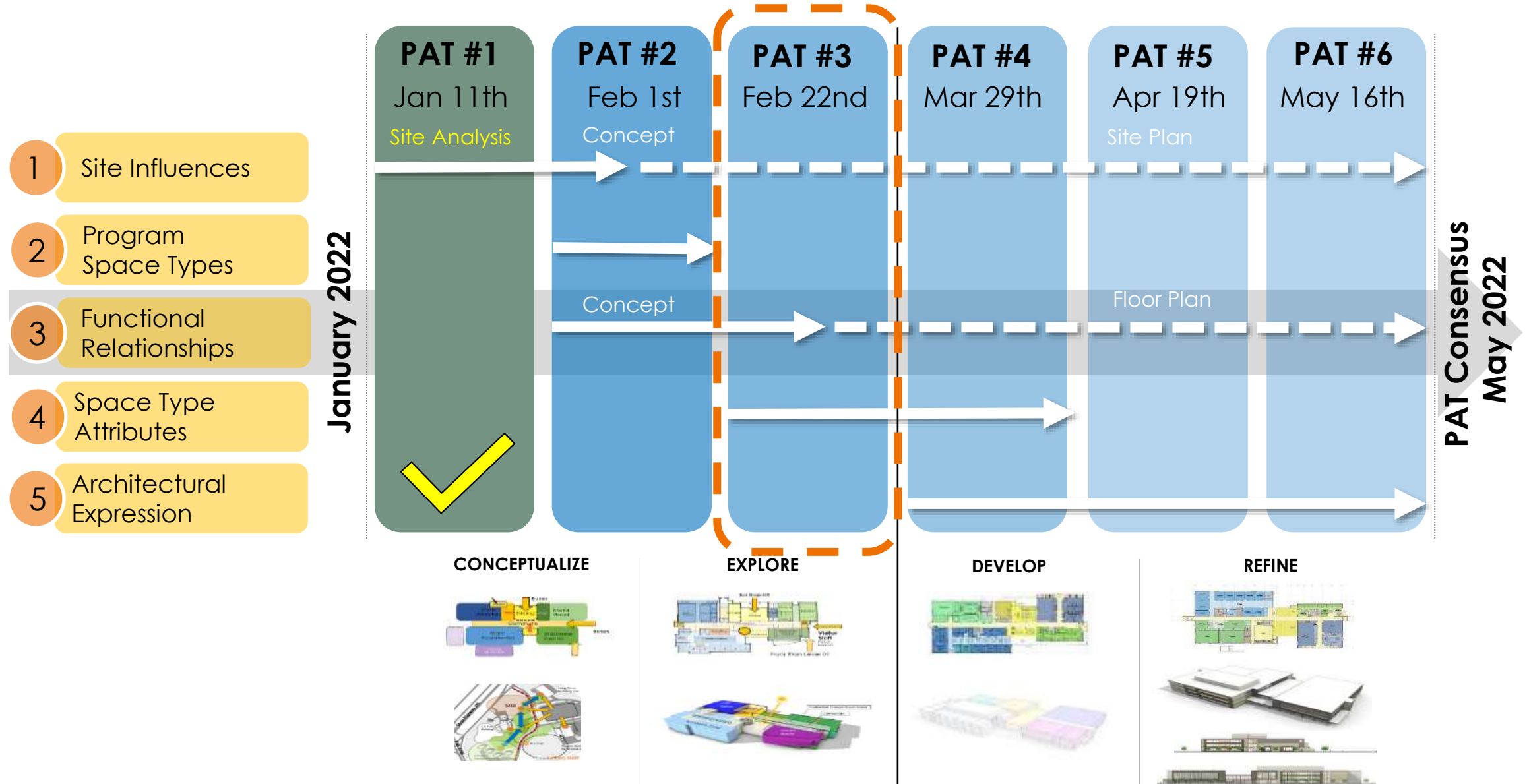



PAT Meeting #3 – What's Happening Next?

PAT Mtg #2 Activity

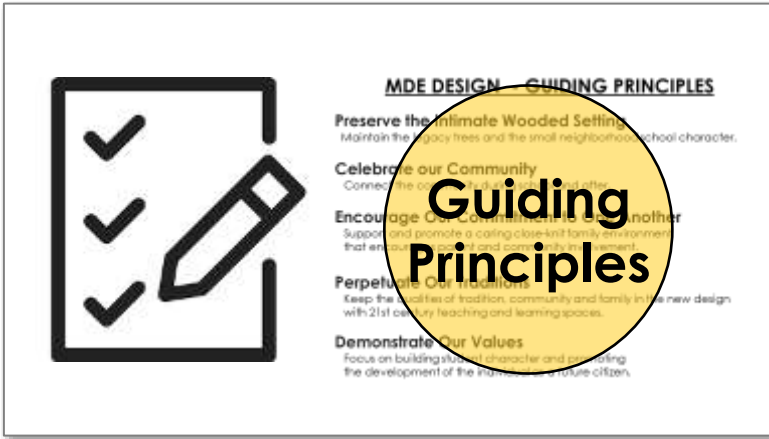

Guiding Principles

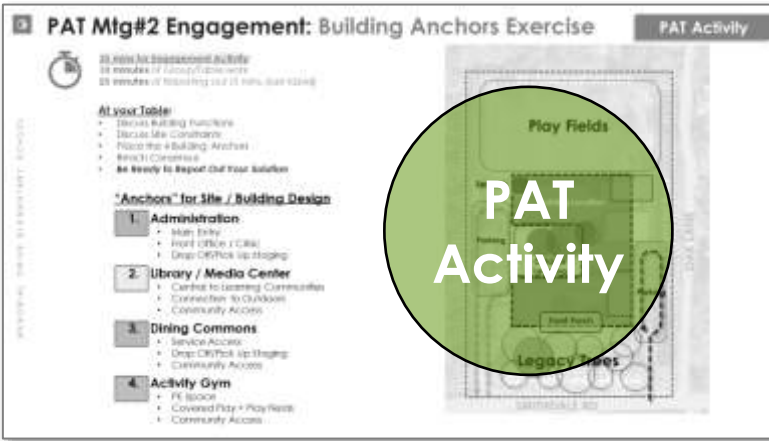

PAT Activity

PAT MEETING #3:

Building Organization + Exterior Identity



Floor Plan With Design Options

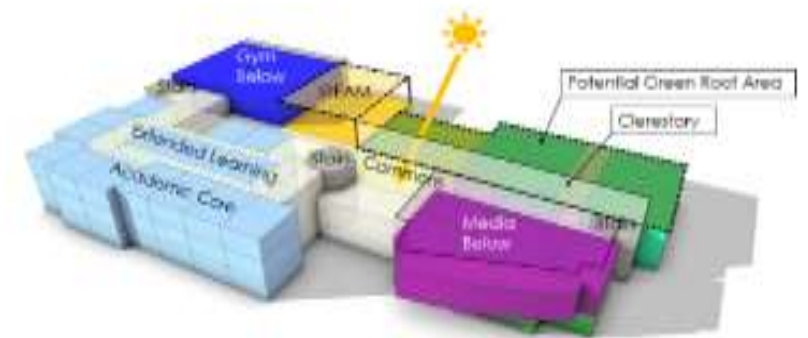

Stacking & Massing Diagrams



See you at PAT Mtg #3

**Feb 22, 2022
3:45 PM**

Memorial Drive ES

THANK YOU!